

**Korpus formy**

Mold base

**126x126**

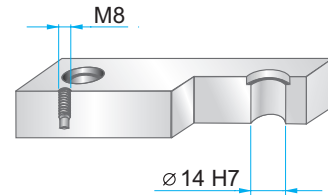
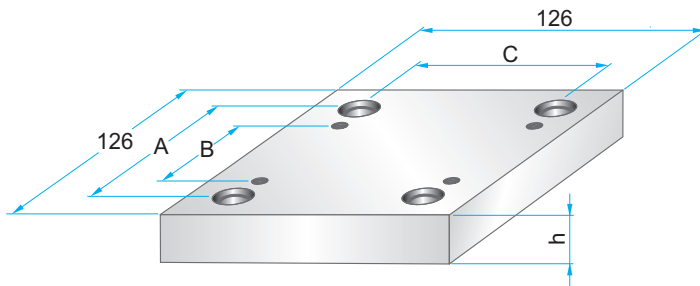

Wymiary i tolerancje  
Dimensions and tolerances



|     | A   | B  | C   |
|-----|-----|----|-----|
| PKA | 104 | 54 | 104 |

**PKA 01**

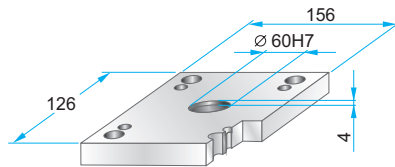

**PKA 01 – 126 x 126 x h / material**

|    |      |
|----|------|
| 17 | 1730 |
| 22 | 2312 |
|    | 2085 |

**PKA 11**

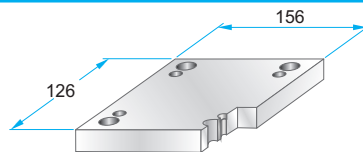

**PKA 11 – 126 x 126 x h / material**

|    |      |
|----|------|
| 17 | 1730 |
| 22 | 2312 |
|    | 2085 |

**PKA 02**

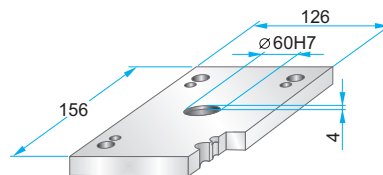
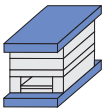

**PKA 02 – 126 x 126 x h / material**

|    |      |
|----|------|
| 17 | 1730 |
|    | 2312 |
|    | 2085 |

**PKA 12**

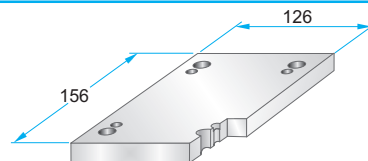
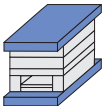

**PKA 12 – 126 x 126 x h / material**

|    |      |
|----|------|
| 17 | 1730 |
|    | 2312 |
|    | 2085 |

**PKA 025**

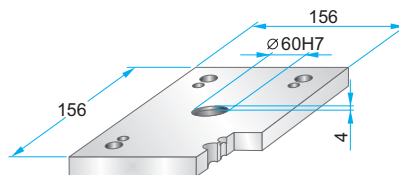

**PKA 025 – 126 x 126 x h / material**

|    |      |
|----|------|
| 17 | 1730 |
| 22 | 2312 |
|    | 2085 |

**PKA 125**

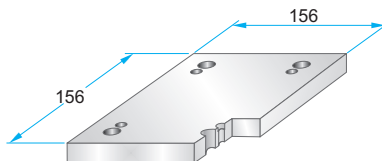

**PKA 125 – 126 x 126 x h / material**

|    |      |
|----|------|
| 17 | 1730 |
| 22 | 2312 |
|    | 2085 |

**PKA 21**

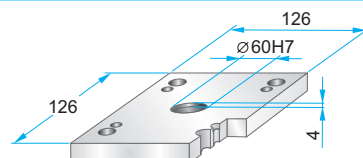

**PKA 21 – 126 x 126 x h / material**

|    |      |
|----|------|
| 17 | 1730 |
|    | 2312 |
|    | 2085 |

**Korpus formy**

Mold base

**126x126**

**PKA 22**

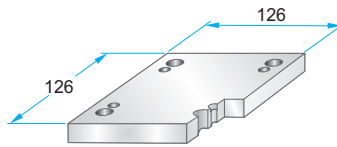

**PKA 22 – 126 x 126 x h / material**

|    |      |
|----|------|
| 17 | 1730 |
|    | 2312 |
|    | 2085 |

**PKA 03**

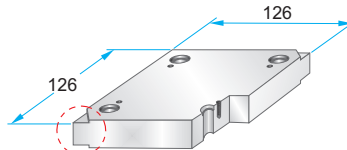
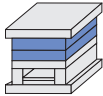

**PKA 03 – 126 x 126 x h / material**

|    |          |
|----|----------|
| 12 | 1730     |
| 17 | 2083     |
| 22 | 2085     |
| 27 | 2162     |
| 36 | 2311     |
| 46 | 2312     |
| 56 | 2738     |
|    | Toolox33 |
|    | Toolox44 |
|    | 2738HH   |
|    | 2714HH   |

Podcięcia do demontażu na życzenie.  
Corner undercuts upon request.



Material info



**PKA 31**

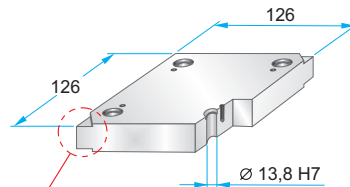
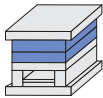

**PKA 31 – 126 x 126 x h / material**

|    |          |
|----|----------|
| 12 | 1730     |
| 17 | 2083     |
| 22 | 2085     |
| 27 | 2162     |
| 36 | 2311     |
| 46 | 2312     |
| 56 | 2343     |
|    | 2738     |
|    | 2767     |
|    | Toolox33 |
|    | Toolox44 |
|    | 2738HH   |
|    | 2714HH   |

Podcięcia do demontażu na życzenie.  
Corner undercuts upon request.



Material info



**PKA 04**

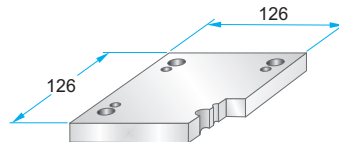
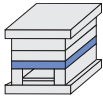

**PKA 04 – 126 x 126 x h / material**

|    |      |
|----|------|
| 17 | 1730 |
| 22 | 2312 |
| 27 | 2085 |

**PKA 05**

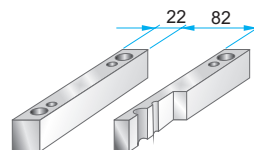
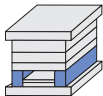

**PKA 05 – 126 x 126 x h / material**

|    |      |
|----|------|
| 36 | 1730 |
| 46 | 2085 |
| 56 |      |
| 66 |      |

**PKA 06**

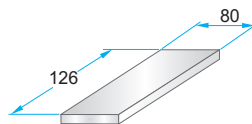
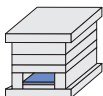

**PKA 06 – 126 x 126 x h / material**

|   |      |
|---|------|
| 9 | 1730 |
|   | 2085 |

**PKA 07**

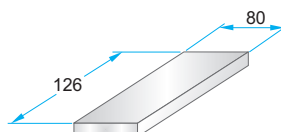
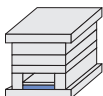

**PKA 07 – 126 x 126 x h / material**

|    |      |
|----|------|
| 12 | 1730 |
|    | 2312 |
|    | 2085 |