

Korpus formy

Mold base

156x156

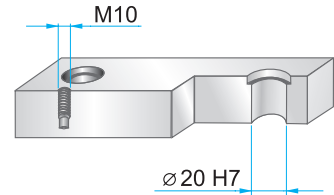
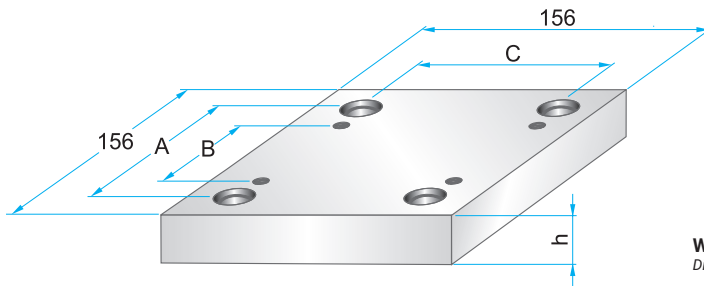

Wymiary i tolerancje
Dimensions and tolerances



	A	B	C
PK	122	72	122
PKA	124	60	124

**PK 01
PKA 01**

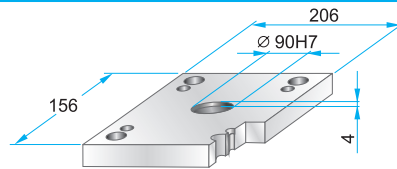

PK 01 - 156 x 156 x h / material
PKA 01 - 156 x 156 x h / material

17	1730
22	2312
27	2085

**PK 11
PKA 11**

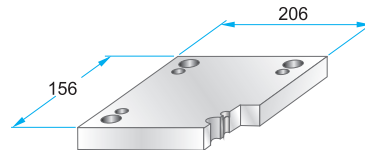

PK 11 - 156 x 156 x h / material
PKA 11 - 156 x 156 x h / material

17	1730
22	2312
27	2085

**PK 02
PKA 02**

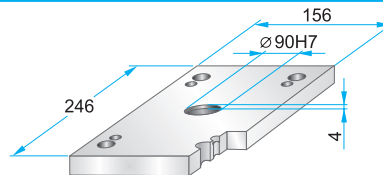

PK 02 - 156 x 156 x h / material
PKA 02 - 156 x 156 x h / material

22	1730
27	2312
	2085

**PK 12
PKA 12**

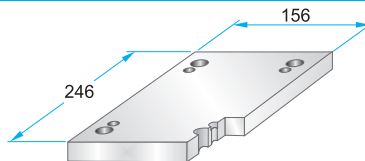
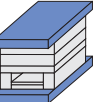

PK 12 - 156 x 156 x h / material
PKA 12 - 156 x 156 x h / material

22	1730
27	2312
	2085

**PK 21
PKA 21**

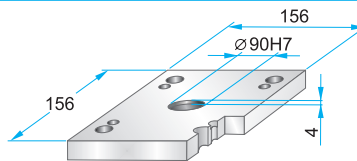
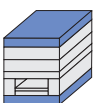

PK 21 - 156 x 156 x h / material
PKA 21 - 156 x 156 x h / material

17	1730
22	2312
27	2085

**PK 22
PKA 22**

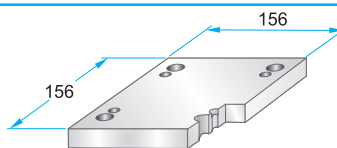

PK 22 - 156 x 156 x h / material
PKA 22 - 156 x 156 x h / material

17	1730
22	2312
27	2085

**PK 03
PKA 03**

Podcięcia do demontażu
na życzenie.
Corner undercuts upon request.

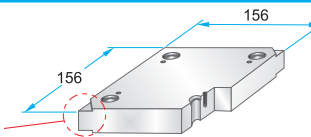

PK 03 - 156 x 156 x h / material
PKA 03 - 156 x 156 x h / material

PK 35 - 156 x 156 x h / material
PKA 35 - 156 x 156 x h / (a1/b1/h1)

17	1730
22	2083
27	2085
36	2162

**PK 35
PKA 35**

Podcięcia do demontażu
na życzenie.
Corner undercuts upon request.

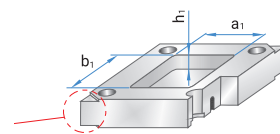

Material info



46	2311
56	2312
66	2738
76	Toolox33
86	Toolox44
96	2738HH
	2714HH

Korpus formy

Mold base

156x156

**PK 31
PKA 31**

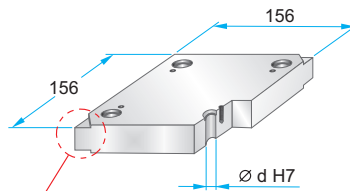
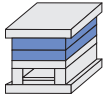

Podcięcia do demontażu na życzenie.
Corner undercuts upon request.



	d
PK 31	19,6
PKA 31	19,7

Material info



PK 31 - 156 x 156 x	h /	material
PKA 31 - 156 x 156 x	h /	
	17	1730
	22	2083
	27	2085
	36	2162
	46	2311
	56	2312
	66	2738
	76	2767
	86	Toolox33
		Toolox44
		2738HH
		2714HH

**PK 04
PKA 04**

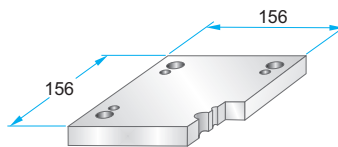
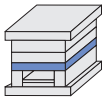

PK 04 - 156 x 156 x h / **material**
PKA 04 - 156 x 156 x h /

	17	1730
	22	2312
	27	2085
	36	
	46	
	56	
	66	

**PK 05
PKA 05**

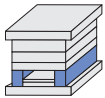

	A	B
PK 05	32	92
PKA 05	29	98

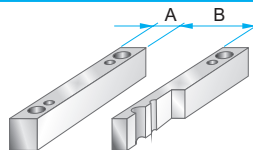

PK 05 - 156 x 156 x h / **material**
PKA 05 - 156 x 156 x h /

	36	1730
	46	2085
	56	
	66	
	76	
	86	
	96	

**PK 55
PKA 55**

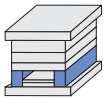

**PK 06
PKA 06**

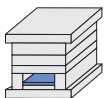

	A	B	C
PK 06	100	68	90
PKA 06	80	70	96

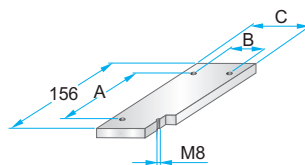

PK 06 - 156 x 156 x h / **material**
PKA 06 - 156 x 156 x h /

	9	1730
		2085

**PK 65
PKA 65**

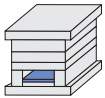

**PK 07
PKA 07**

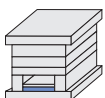

	A	B	C	D	M
PK 07	100	68	90	136	M4
PKA 07	80	70	96	130	M5

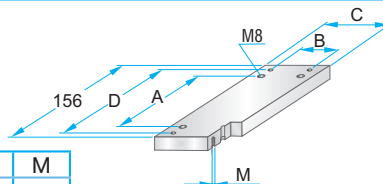

PK 07 - 156 x 156 x h / **material**
PKA 07 - 156 x 156 x h /

	17	1730
		2312
		2085

**PK 75
PKA 75**

