

Korpus formy

Mold base

156x196

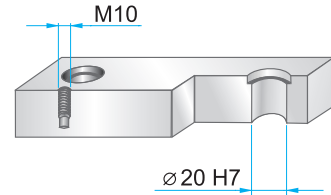
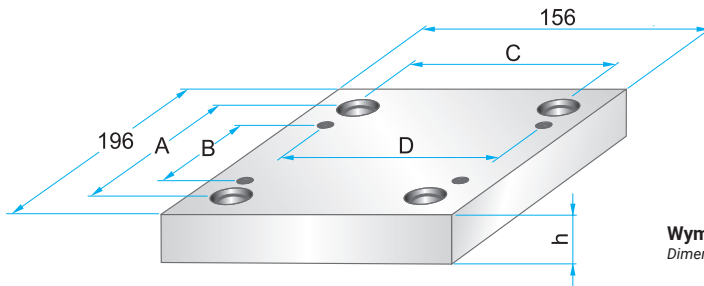

Wymiary i tolerancje
Dimensions and tolerances



	A	B	C	D
PK	156	114	120	126
PKA	164	100	124	124

**PK 01
PKA 01**

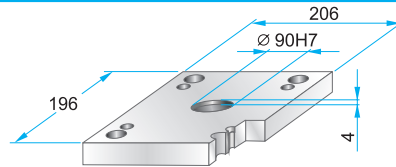

PK 01 - 156 x 196 x h / material
PKA 01 - 156 x 196 x h / material

17	1730
22	2312
27	2085

**PK 11
PKA 11**

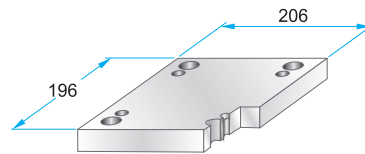

PK 11 - 156 x 196 x h / material
PKA 11 - 156 x 196 x h / material

17	1730
22	2312
27	2085

**PK 02
PKA 02**

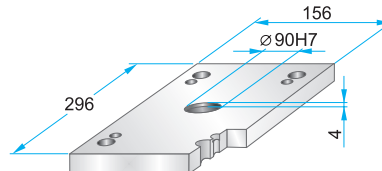

PK 02 - 156 x 196 x h / material
PKA 02 - 156 x 196 x h / material

22	1730
27	2312
	2085

**PK 12
PKA 12**

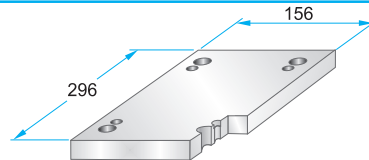
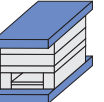

PK 12 - 156 x 196 x h / material
PKA 12 - 156 x 196 x h / material

22	1730
27	2312
	2085

**PK 21
PKA 21**

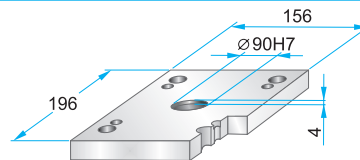
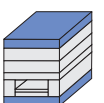

PK 21 - 156 x 196 x h / material
PKA 21 - 156 x 196 x h / material

17	1730
22	2312
27	2085

**PK 22
PKA 22**

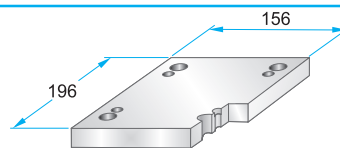

PK 22 - 156 x 196 x h / material
PKA 22 - 156 x 196 x h / material

17	1730
22	2312
27	2085

**PK 03
PKA 03**

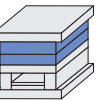

Podcięcia do demontażu
na życzenie.
Corner undercuts upon request.

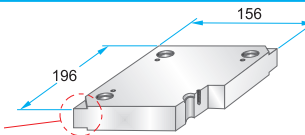

PK 03 - 156 x 196 x h / material
PKA 03 - 156 x 196 x h / material

PK 35 - 156 x 196 x h / material
PKA 35 - 156 x 196 x h / (a1/b1/h1)

17	1730
22	2083
27	2085
36	2162
46	2311
56	2312
66	2738
76	Toolox33
86	Toolox44
96	2738HH
	2714HH

**PK 35
PKA 35**

Podcięcia do demontażu
na życzenie.
Corner undercuts upon request.

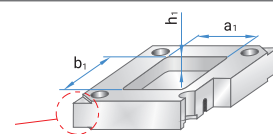

Material info



Korpus formy

Mold base

156x196

**PK 31
PKA 31**

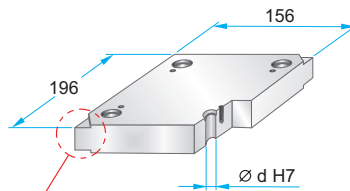
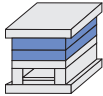

Podcięcia do demontażu na życzenie.
Corner undercuts upon request.



	d
PK 31	19,6
PKA 31	19,7

PK 31 – 156 x 196 x h / material
PKA 31 – 156 x 196 x h / material

17	1730
22	2083
27	2085
36	2162
46	2311
56	2312
66	2343
76	2738
86	2767
	Toolox33
	Toolox44
	2738HH
	2714HH

Material info



**PK 04
PKA 04**

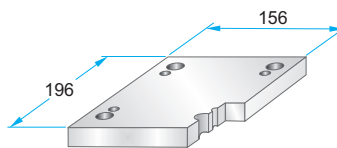
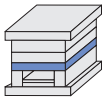

PK 04 – 156 x 196 x h / material
PKA 04 – 156 x 196 x h / material

17	1730
22	2312
27	2085
36	
46	
56	
66	

**PK 05
PKA 05**

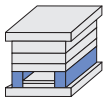

	A	B
PK 05	32	92
PKA 05	29	98

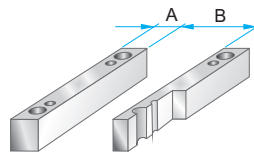

PK 05 – 156 x 196 x h / material
PKA 05 – 156 x 196 x h / material

46	1730
56	2085
66	
76	
86	
96	

**PK 55
PKA 55**

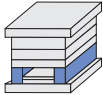

**PK 06
PKA 06**

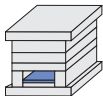

	A	B	C
PK 06	140	68	90
PKA 06	120	70	96

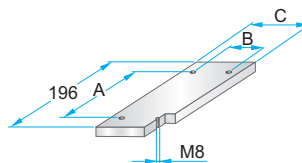

PK 06 – 156 x 196 x h / material
PKA 06 – 156 x 196 x h / material

9	1730
	2085

**PK 65
PKA 65**

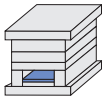

**PK 07
PKA 07**

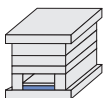

	A	B	C	D	M
PK 07	140	68	90	172	M4
PKA 07	120	70	96	170	M5

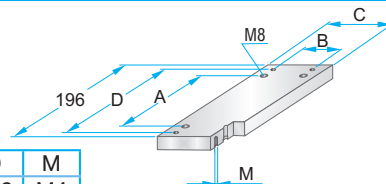

PK 07 – 156 x 196 x h / material
PKA 07 – 156 x 196 x h / material

17	1730
	2312
	2085

**PK 75
PKA 75**

