

**Korpus formy**

Mold base

**156x296**

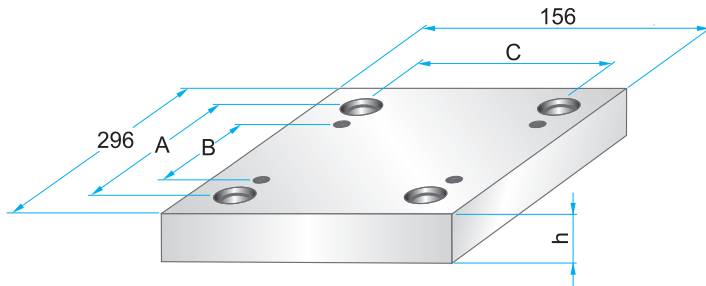

Wymiary i tolerancje  
Dimensions and tolerances



	A	B	C
<b>PK</b>	262	212	122
<b>PKA</b>	264	200	124

**PK 01  
PKA 01**

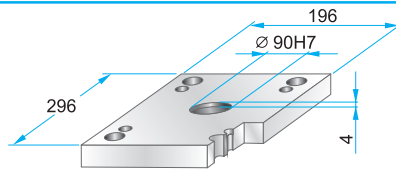

**PK 01** - 156 x 296 x h / material  
**PKA 01** - 156 x 296 x h / material

22	1730
27	2312
	2085

**PK 11  
PKA 11**

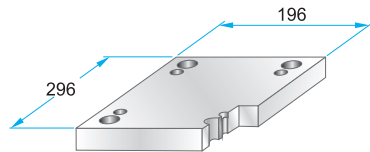

**PK 11** - 156 x 296 x h / material  
**PKA 11** - 156 x 296 x h / material

22	1730
27	2312
	2085

**PK 02  
PKA 02**

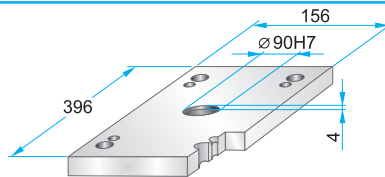

**PK 02** - 156 x 296 x h / material  
**PKA 02** - 156 x 296 x h / material

22	1730
27	2312
	2085

**PK 12  
PKA 12**

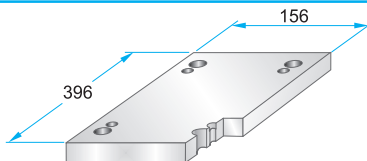
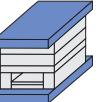

**PK 12** - 156 x 296 x h / material  
**PKA 12** - 156 x 296 x h / material

22	1730
27	2312
	2085

**PK 21  
PKA 21**

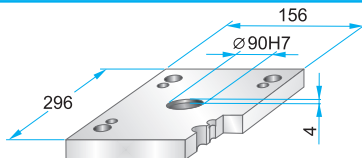
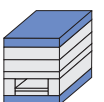

**PK 21** - 156 x 296 x h / material  
**PKA 21** - 156 x 296 x h / material

22	1730
27	2312
	2085

**PK 22  
PKA 22**

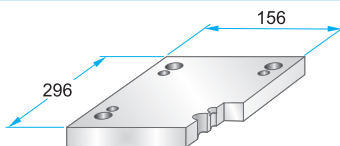

**PK 22** - 156 x 296 x h / material  
**PKA 22** - 156 x 296 x h / material

22	1730
27	2312
	2085

**PK 03  
PKA 03**

Podcięcia do demontażu  
na życzenie.  
Corner undercuts upon request.

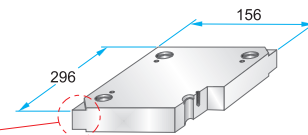

**PK 03** - 156 x 296 x h / material  
**PKA 03** - 156 x 296 x h / material

**PK 35** - 156 x 296 x h / material  
**PKA 35** - 156 x 296 x h / (a1/b1/h1)

17	1730
22	2083
27	2085
36	2162
46	2311
56	2312
66	2738
76	Toolox33
86	Toolox44
	2738HH
	2714HH

**PK 35  
PKA 35**

Podcięcia do demontażu  
na życzenie.  
Corner undercuts upon request.

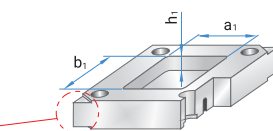

Material info



**Korpus formy**

Mold base

**156x296**

**PK 31  
PKA 31**

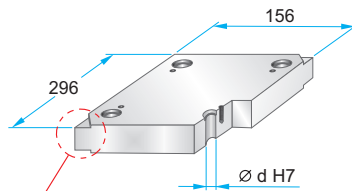
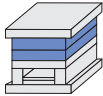

Podcięcia do demontażu na życzenie.  
Corner undercuts upon request.



	d
<b>PK 31</b>	19,6
<b>PKA 31</b>	19,7

Material info



**PK 31 – 156 x 296 x h / material**  
**PKA 31 – 156 x 296 x h / material**

17	1730
22	2083
27	2085
36	2162
46	2311
56	2312
66	2343
76	2738
86	2767
	Toolox33
	Toolox44
	2738HH
	2714HH

**PK 04  
PKA 04**

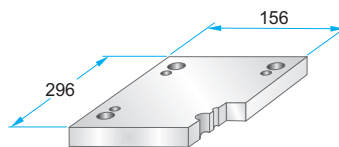
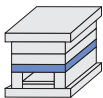

**PK 04 – 156 x 296 x h / material**  
**PKA 04 – 156 x 296 x h / material**

27	1730
36	2312
46	2085
56	

**PK 05  
PKA 05**

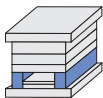

	A	B
<b>PK 05</b>	32	92
<b>PKA 05</b>	29	98

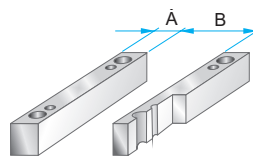

**PK 05 – 156 x 296 x h / material**  
**PKA 05 – 156 x 296 x h / material**

46	1730
56	2085
66	
76	
86	
96	

**PK 55  
PKA 55**

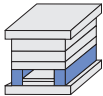

**PK 06  
PKA 06**

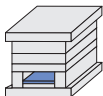

	A	B	C
<b>PK 06</b>	236	68	90
<b>PKA 06</b>	220	70	96

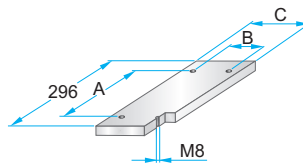

**PK 06 – 156 x 296 x h / material**  
**PKA 06 – 156 x 296 x h / material**

12	1730
	2085

**PK 65  
PKA 65**

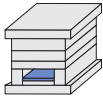

**PK 07  
PKA 07**

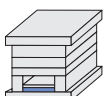

	A	B	C	D	M
<b>PK 07</b>	236	68	90	274	M4
<b>PKA 07</b>	220	70	96	270	M5

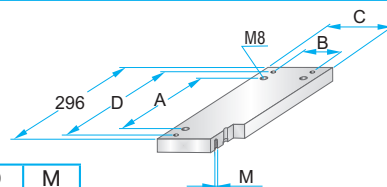

**PK 07 – 156 x 296 x h / material**  
**PKA 07 – 156 x 296 x h / material**

17	1730
	2312
	2085

**PK 75  
PKA 75**

