

Korpus formy

Mold base

156x346

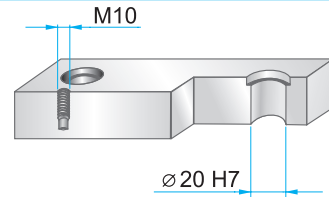
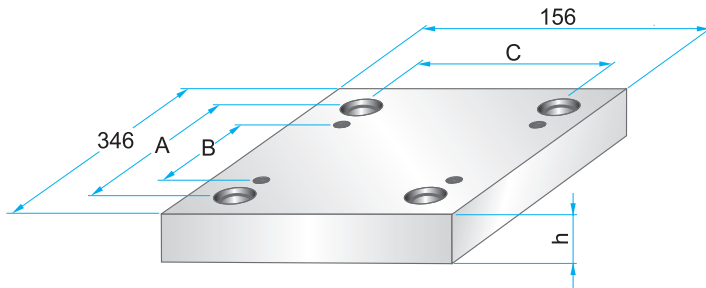

Wymiary i tolerancje
Dimensions and tolerances



	A	B	C
PK	312	262	122
PKA	314	250	124

**PK 01
PKA 01**

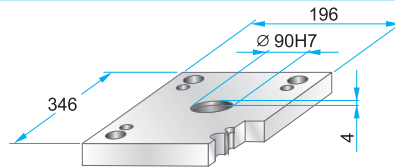
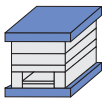

PK 01 – 156 x 346 x h / material
PKA 01 – 156 x 346 x h / material

22	1730
27	2312
	2085

**PK 11
PKA 11**

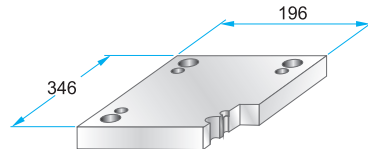
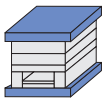

PK 11 – 156 x 346 x h / material
PKA 11 – 156 x 346 x h / material

22	1730
27	2312
	2085

**PK 02
PKA 02**

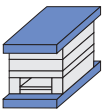

	A
PK 02	396
PKA 02	446

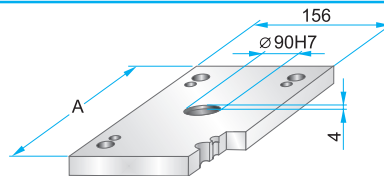

PK 02 – 156 x 346 x h / material
PKA 02 – 156 x 346 x h / material

22	1730
27	2312
	2085

**PK 12
PKA 12**

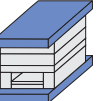

	A
PK 12	396
PKA 12	446

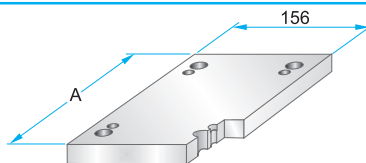

PK 12 – 156 x 346 x h / material
PKA 12 – 156 x 346 x h / material

22	1730
27	2312
	2085

**PK 21
PKA 21**

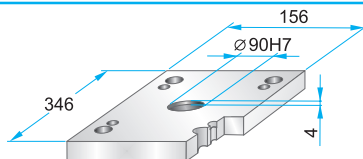

PK 21 – 156 x 346 x h / material
PKA 21 – 156 x 346 x h / material

22	1730
27	2312
	2085

**PK 22
PKA 22**

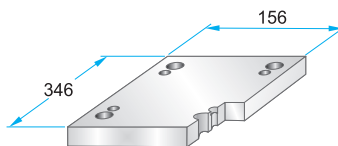

PK 22 – 156 x 346 x h / material
PKA 22 – 156 x 346 x h / material

22	1730
27	2312
	2085

**PK 03
PKA 03**

Podcięcia do demontażu
na życzenie.
Corner undercuts upon request.

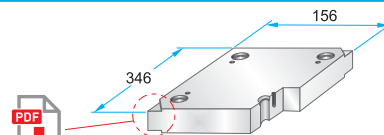

PK 03 – 156 x 346 x h / material
PKA 03 – 156 x 346 x h / material

**PK 35
PKA 35**

Podcięcia do demontażu
na życzenie.
Corner undercuts upon request.

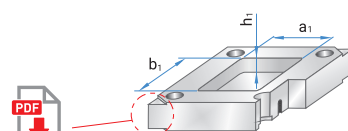

PK 35 – 156 x 346 x h / material
PKA 35 – 156 x 346 x h / (a1/b1/h1)

17	1730
22	2083
27	2085
36	2162
46	2311
56	2312
66	2738
76	Toolox33
86	Toolox44
	2738HH
	2714HH

Material info



Korpus formy

Mold base

156x346

**PK 31
PKA 31**

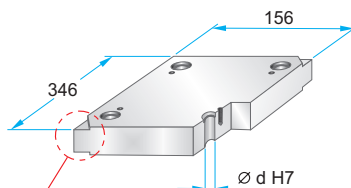
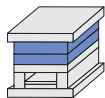

Podcięcia do demontażu na życzenie.
Corner undercuts upon request.



	d
PK 31	19,6
PKA 31	19,7

Material info



PK 31 – 156 x 346 x	h /	material
PKA 31 – 156 x 346 x	h /	
	17	1730
	22	2083
	27	2085
	36	2162
	46	2311
	56	2312
	66	2343
	76	2738
	86	2767
		Toolox33
		Toolox44
		2738HH
		2714HH

**PK 04
PKA 04**

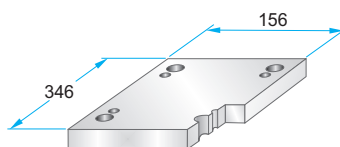
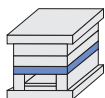

PK 04 – 156 x 346 x	h /	material
PKA 04 – 156 x 346 x	h /	
	27	1730
	36	2312
	46	2085
	56	

**PK 05
PKA 05**

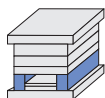

	A	B
PK 05	32	92
PKA 05	29	98

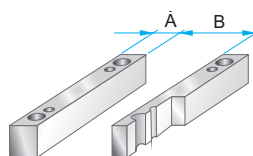

PK 05 – 156 x 346 x	h /	material
PKA 05 – 156 x 346 x	h /	
	46	1730
	56	2085
	66	
	76	
	86	
	96	

**PK 55
PKA 55**

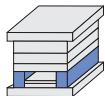

**PK 06
PKA 06**

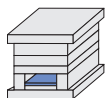

	A	B	C
PK 06	286	68	90
PKA 06	270	70	96

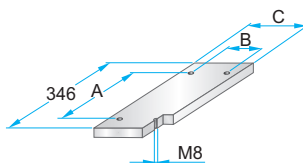

PK 06 – 156 x 346 x	h /	material
PKA 06 – 156 x 346 x	h /	
	12	1730
		2085

**PK 65
PKA 65**

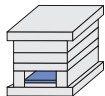

**PK 07
PKA 07**

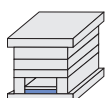

	A	B	C	D	M
PK 07	286	68	90	324	M4
PKA 07	270	70	96	320	M5

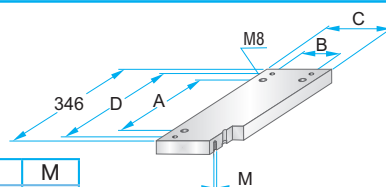

PK 07 – 156 x 346 x	h /	material
PKA 07 – 156 x 346 x	h /	
	17	1730
		2312
		2085

**PK 75
PKA 75**

