

Korpus formy

Mold base

196x246

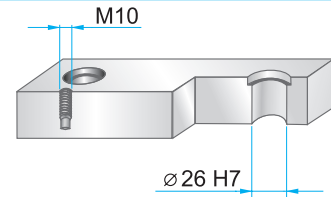
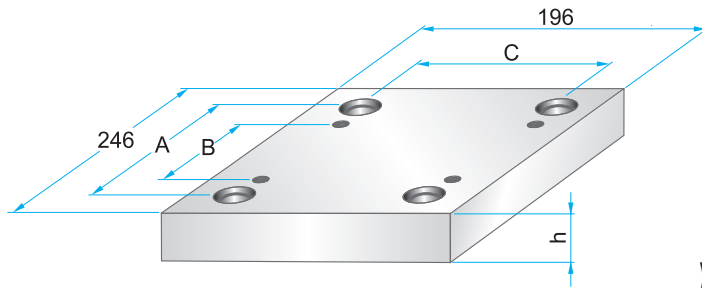

Wymiary i tolerancje
Dimensions and tolerances



	A	B	C
PKA	206	136	156

PKA 01

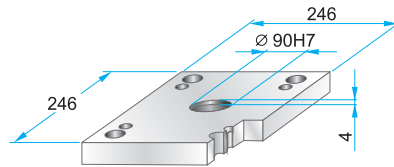
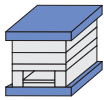

PKA 01 – 196 x 246 x h / material

22	1730
27	2312
36	2085
46	

PKA 11

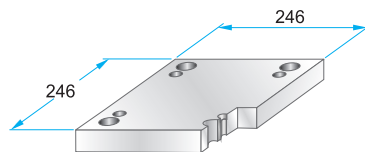

PKA 11 – 196 x 246 x h / material

22	1730
27	2312
36	2085
46	

PKA 02

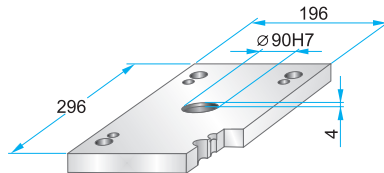
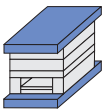

PKA 02 – 196 x 246 x h / material

22	1730
27	2312
36	2085

PKA 12

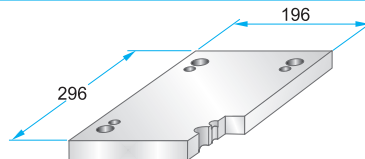
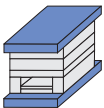

PKA 12 – 196 x 246 x h / material

22	1730
27	2312
36	2085

PKA 21

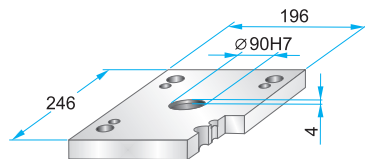
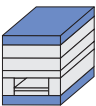

PKA 21 – 196 x 246 x h / material

22	1730
27	2312
	2085

PKA 22

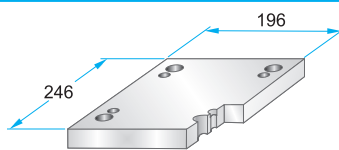
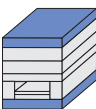

PKA 22 – 196 x 246 x h / material

22	1730
27	2312
	2085

PKA 03

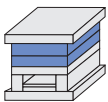

Podcięcia do demontażu
na życzenie.
Corner undercuts upon request.

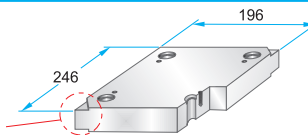

PKA 03 – 196 x 246 x h / material

PKA 35 – 196 x 246 x h / material (a1/b1/h1)

17	1730
22	2083
27	2085
36	2162
46	2311
56	2312
66	2738
76	Toolox33
86	Toolox44
96	2738HH
116	2714HH

PKA 35

Podcięcia do demontażu
na życzenie.
Corner undercuts upon request.

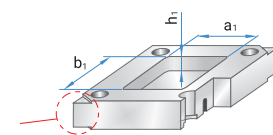

Material info



Korpus formy

Mold base

196x246

PKA 31

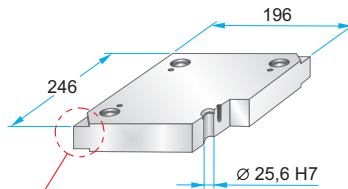
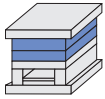

Podcięcia do demontażu na życzenie.
Corner undercuts upon request.



Material info



PKA 31 – 196 x 246 x h / material

17	1730
22	2083
27	2085
36	2162
46	2311
56	2312
66	2343
76	2738
86	2767
96	Toolox33
	Toolox44
	2738HH
	2714HH

PKA 04

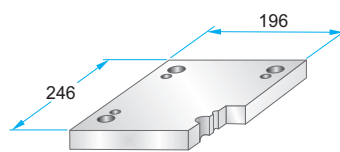
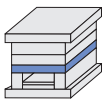

PKA 04 – 196 x 246 x h / material

17	1730
22	2312
27	2085
36	
46	
56	
66	

PKA 05

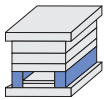

	A	B
PKA 05	36	124

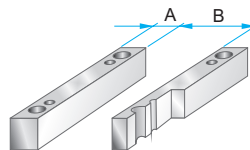

PKA 05 – 196 x 246 x h / material

46	1730
56	2085
66	
76	
86	
96	

PKA 55

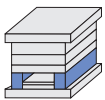

	A	B
PKA 55	50	96

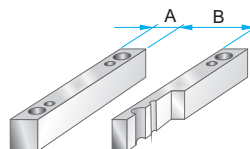

PKA 55 – 196 x 246 x h / material

46	1730
56	2085
66	
76	
86	
96	

PKA 06



	A	B	C
PKA 06	170	96	122

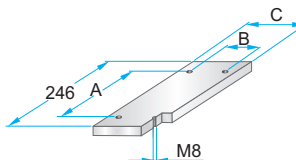

PKA 06 – 196 x 246 x h / material

12	1730
	2085

PKA 65



	A	B	C
PKA 65	170	68	94

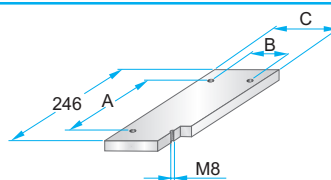

PKA 65 – 196 x 246 x h / material

12	1730
	2085

PKA 07

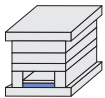

	A	B	C	D
PKA 07	170	96	122	220

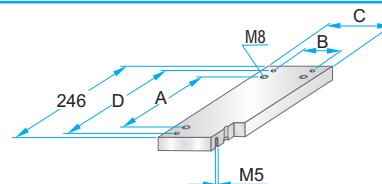

PKA 07 – 196 x 246 x h / material

17	1730
	2312
	2085

PKA 75

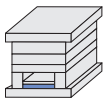

	A	B	C	D
PKA 75	170	68	94	220

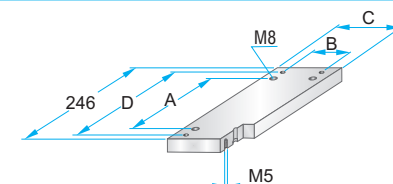

PKA 75 – 196 x 246 x h / material

17	1730
	2312
	2085