

**Korpus formy**

Mold base

**196x396**

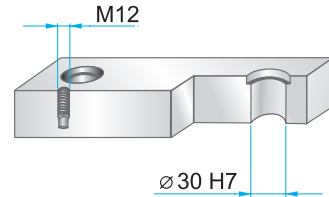
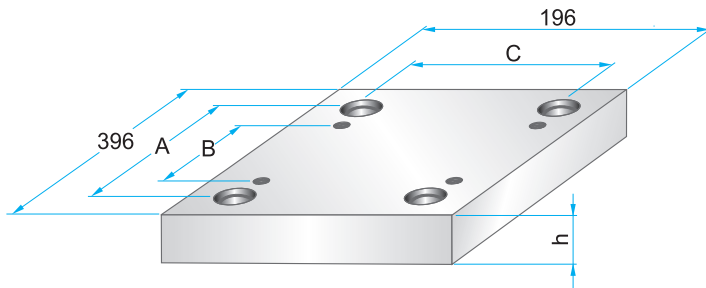

Wymiary i tolerancje  
Dimensions and tolerances



	A	B	C
<b>PK</b>	344	274	144
<b>PKA</b>	348	270	148

**PK 01  
PKA 01**

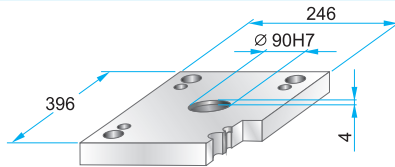
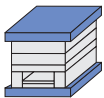

**PK 01** - 196 x 396 x h / material  
**PKA 01** - 196 x 396 x h / material

27	1730
36	2312
	2085

**PK 11  
PKA 11**

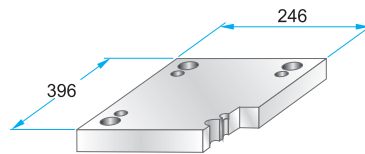

**PK 11** - 196 x 396 x h / material  
**PKA 11** - 196 x 396 x h / material

27	1730
36	2312
	2085

**PK 02  
PKA 02**

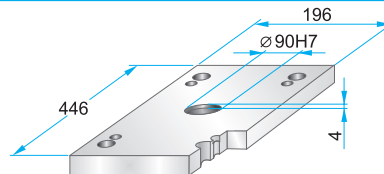

**PK 02** - 196 x 396 x h / material  
**PKA 02** - 196 x 396 x h / material

27	1730
36	2312
	2085

**PK 12  
PKA 12**

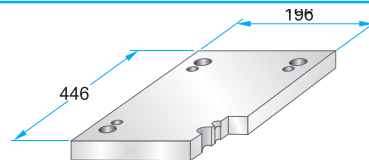
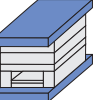

**PK 12** - 196 x 396 x h / material  
**PKA 12** - 196 x 396 x h / material

27	1730
36	2312
	2085

**PK 21  
PKA 21**

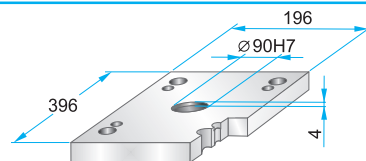

**PK 21** - 196 x 396 x h / material  
**PKA 21** - 196 x 396 x h / material

27	1730
	2312
	2085

**PK 22  
PKA 22**

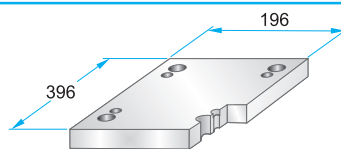

**PK 22** - 196 x 396 x h / material  
**PKA 22** - 196 x 396 x h / material

27	1730
	2312
	2085

**PK 03  
PKA 03**

Podcięcia do demontażu  
na życzenie.  
Corner undercuts upon request.

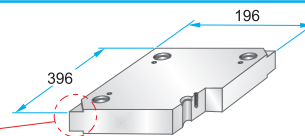

**PK 03** - 196 x 396 x h / material  
**PKA 03** - 196 x 396 x h / material

**PK 35** - 196 x 396 x h / material  
**PKA 35** - 196 x 396 x h / (a1/b1/h1)

22	1730
27	2083
36	2085
46	2162
56	2311
66	2312
76	2738
86	Toolox33
96	Toolox44
116	2738HH
	2714HH

**PK 35  
PKA 35**

Podcięcia do demontażu  
na życzenie.  
Corner undercuts upon request.

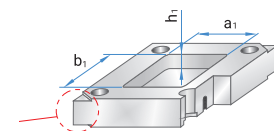

Material info



**Korpus formy**

Mold base

**196x396**

**PK 31  
PKA 31**

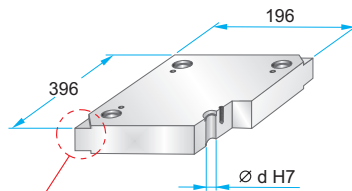
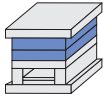

Podcięcia do demontażu na życzenie.  
Corner undercuts upon request.



	d
<b>PK 31</b>	29,4
<b>PKA 31</b>	29,5

Material info



PK 31 - 196 x 396 x	h	/	material
PKA 31 - 196 x 396 x	h	/	
	22	/	1730
	27	/	2083
	36	/	2085
	46	/	2162
	56	/	2311
	66	/	2312
	76	/	2343
	86	/	2738
	96	/	2767
			Toolox33
			Toolox44
			2738HH
			2714HH

**PK 04  
PKA 04**

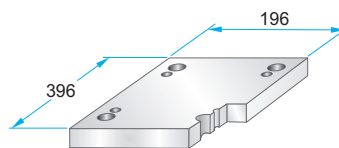
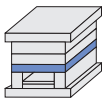

PK 04 - 196 x 396 x	h	/	material
PKA 04 - 196 x 396 x	h	/	
	27	/	1730
	36	/	2312
	46	/	2085
	56	/	

**PK 05  
PKA 05**

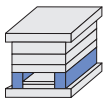

	A	B	M
<b>PK 05</b>	43	110	-
<b>PKA 05</b>	44	108	M10

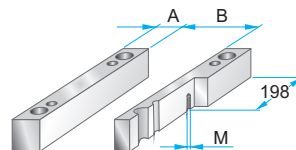

PK 05 - 196 x 396 x	h	/	material
PKA 05 - 196 x 396 x	h	/	
	56	/	1730
	66	/	2085
	76	/	
	86	/	
	96	/	
	116	/	

**PK 55  
PKA 55**

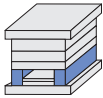

	A	B	M
<b>PK 55</b>	58	80	-
<b>PKA 55</b>	60	76	M10

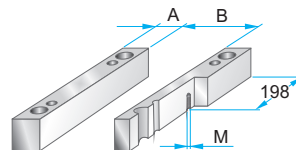

PK 55 - 196 x 396 x	h	/	material
PKA 55 - 196 x 396 x	h	/	
	56	/	1730
	66	/	2085
	76	/	
	86	/	
	96	/	
	116	/	

**PK 06  
PKA 06**

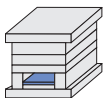

	A	B	C
<b>PK 06</b>	330	90	108
<b>PKA 06</b>	300	80	106

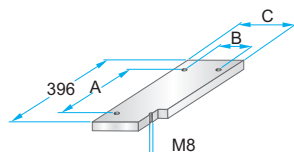

PK 06 - 196 x 396 x	h	/	material
PKA 06 - 196 x 396 x	h	/	
	17	/	1730
		/	2085

**PK 65  
PKA 65**

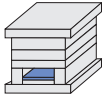

	A	B	C
<b>PK 65</b>	330	58	76
<b>PKA 65</b>	300	48	74

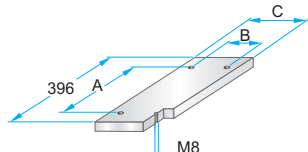

PK 65 - 196 x 396 x	h	/	material
PKA 65 - 196 x 396 x	h	/	
	17	/	1730
		/	2085

**PK 07  
PKA 07**

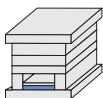

	A	B	C	D	M
<b>PK 07</b>	330	90	108	364	M4
<b>PKA 07</b>	300	80	106	370	M5

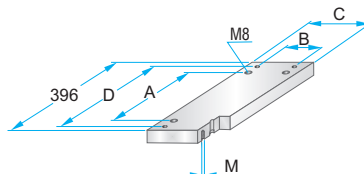

PK 07 - 196 x 396 x	h	/	material
PKA 07 - 196 x 396 x	h	/	
	22	/	1730
		/	2312
		/	2085

**PK 75  
PKA 75**

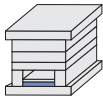

	A	B	C	D	M
<b>PK 75</b>	330	58	76	364	M4
<b>PKA 75</b>	300	48	74	370	M5

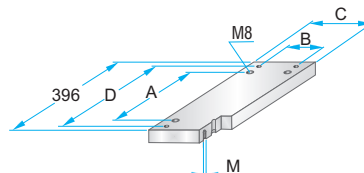

PK 75 - 196 x 396 x	h	/	material
PKA 75 - 196 x 396 x	h	/	
	22	/	1730
		/	2312
		/	2085