

**Korpus formy**

Mold base

**196x446**

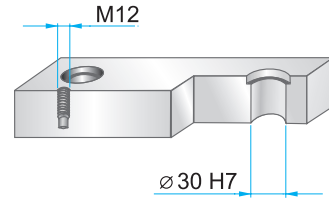
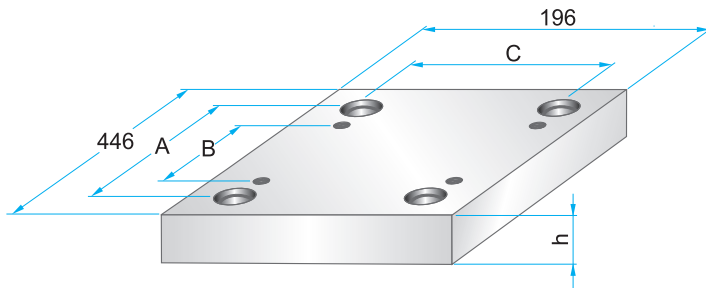

**Wymiary i tolerancje**  
Dimensions and tolerances



	A	B	C
<b>PK</b>	394	324	144
<b>PKA</b>	398	320	148

**PK 01  
PKA 01**

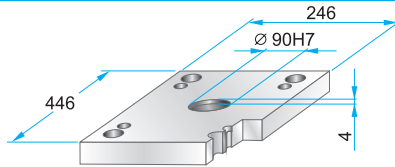

**PK 01** - 196 x 446 x h / material  
**PKA 01** - 196 x 446 x h / material

27	1730
36	2312
	2085

**PK 11  
PKA 11**

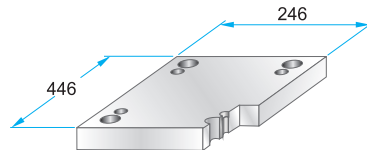

**PK 11** - 196 x 446 x h / material  
**PKA 11** - 196 x 446 x h / material

27	1730
36	2312
	2085

**PK 02**

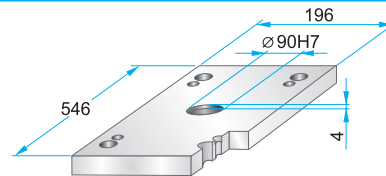
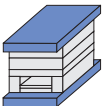

**PK 02** - 196 x 446 x h / material

36	1730
	2312
	2085

**PK 12**

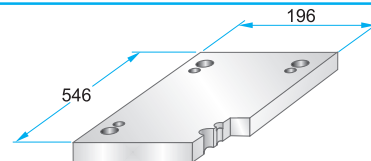
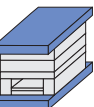

**PK 12** - 196 x 446 x h / material

36	1730
	2312
	2085

**PK 21  
PKA 21**

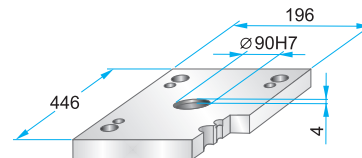
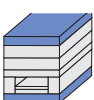

**PK 21** - 196 x 446 x h / material  
**PKA 21** - 196 x 446 x h / material

27	1730
	2312
	2085

**PK 22  
PKA 22**

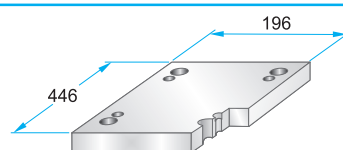

**PK 22** - 196 x 446 x h / material  
**PKA 22** - 196 x 446 x h / material

27	1730
	2312
	2085

**PK 03  
PKA 03**

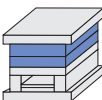

Podcięcia do demontażu  
na życzenie.  
Corner undercuts upon request.

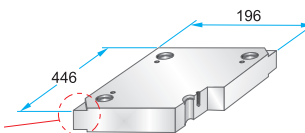

**PK 03** - 196 x 446 x h / material  
**PKA 03** - 196 x 446 x h / material

**PK 35** - 196 x 446 x h / material  
**PKA 35** - 196 x 446 x h / (a1/b1/h1)

22	1730
27	2083
36	2085
46	2162
56	2311
66	2312
76	2738
86	Toolox33
96	Toolox44
	2738HH
	2714HH

**PK 35  
PKA 35**

Podcięcia do demontażu  
na życzenie.  
Corner undercuts upon request.

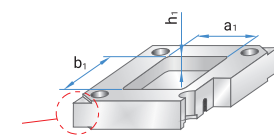

Material info



**Korpus formy**

Mold base

**196x446**

**PK 31  
PKA 31**

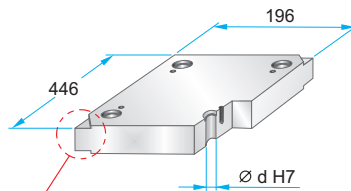
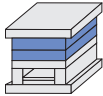

Podcięcia do demontażu na życzenie.  
Corner undercuts upon request.



	d
<b>PK 31</b>	29,4
<b>PKA 31</b>	29,5

Material info



PK 31 - 196 x 446 x	h	/	material
PKA 31 - 196 x 446 x	h	/	
	22		1730
	27		2083
	36		2085
	46		2162
	56		2311
	66		2312
	76		2343
	86		2738
	96		2767
			Toolox33
			Toolox44
			2738HH
			2714HH

**PK 04  
PKA 04**

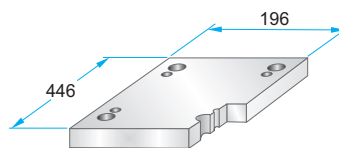
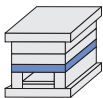

PK 04 - 196 x 446 x	h	/	material
PKA 04 - 196 x 446 x	h	/	
	27		1730
	36		2312
	46		2085
	56		

**PK 05  
PKA 05**

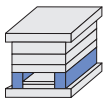

	A	B	M
<b>PK 05</b>	43	110	-
<b>PKA 05</b>	44	108	M10

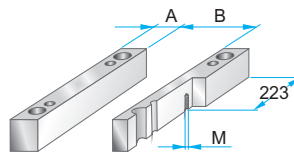

PK 05 - 196 x 446 x	h	/	material
PKA 05 - 196 x 446 x	h	/	
	56		1730
	66		2085
	76		
	86		
	96		
	116		

**PK 55  
PKA 55**

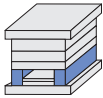

	A	B	M
<b>PK 55</b>	58	80	-
<b>PKA 55</b>	60	76	M10

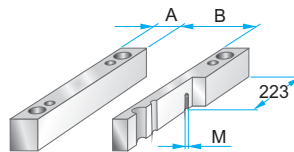

PK 55 - 196 x 446 x	h	/	material
PKA 55 - 196 x 446 x	h	/	
	56		1730
	66		2085
	76		
	86		
	96		
	116		

**PK 06  
PKA 06**

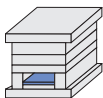

	A	B	C
<b>PK 06</b>	380	90	108
<b>PKA 06</b>	350	80	106

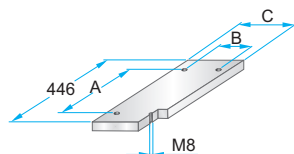

PK 06 - 196 x 446 x	h	/	material
PKA 06 - 196 x 446 x	h	/	
	17		1730
			2085

**PK 65  
PKA 65**

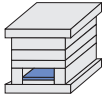

	A	B	C
<b>PK 65</b>	380	58	76
<b>PKA 65</b>	350	48	74

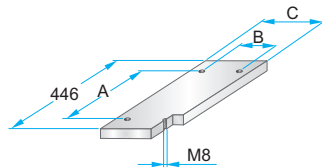

PK 65 - 196 x 446 x	h	/	material
PKA 65 - 196 x 446 x	h	/	
	17		1730
			2085

**PK 07  
PKA 07**

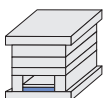

	A	B	C	D	M
<b>PK 07</b>	380	90	108	414	M4
<b>PKA 07</b>	350	80	106	420	M5

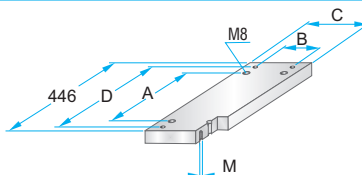

PK 07 - 196 x 446 x	h	/	material
PKA 07 - 196 x 446 x	h	/	
	22		1730
			2312
			2085

**PK 75  
PKA 75**

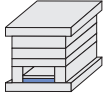

	A	B	C	D	M
<b>PK 75</b>	380	58	76	414	M4
<b>PKA 75</b>	350	48	74	420	M5

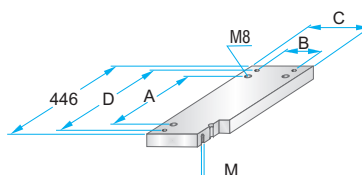

PK 75 - 196 x 446 x	h	/	material
PKA 75 - 196 x 446 x	h	/	
	22		1730
			2312
			2085