

Korpus formy

Mold base

196x496

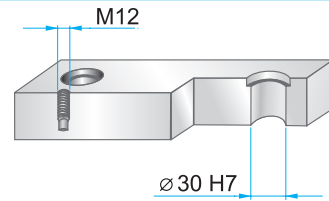
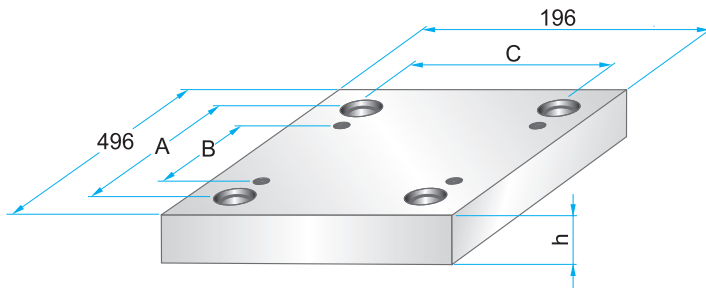

Wymiary i tolerancje
Dimensions and tolerances



	A	B	C
PK	444	374	144
PKA	448	370	148

**PK 01
PKA 01**

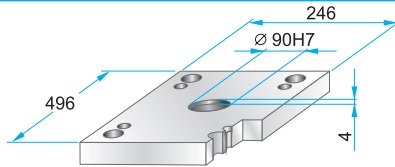

PK 01 - 196 x 496 x h / material
PKA 01 - 196 x 496 x h / material

27	1730
36	2312
	2085

**PK 11
PKA 11**

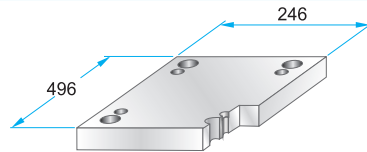

PK 11 - 196 x 496 x h / material
PKA 11 - 196 x 496 x h / material

27	1730
36	2312
	2085

PK 02

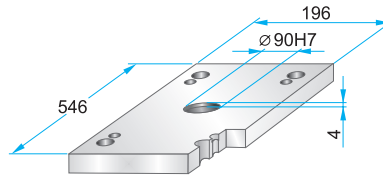
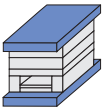

PK 02 - 196 x 496 x h / material

36	1730
	2312
	2085

PK 12

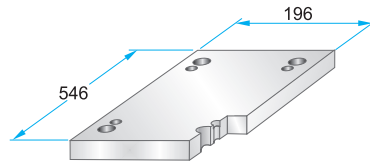
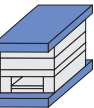

PKA 12 - 196 x 496 x h / material

36	1730
	2312
	2085

**PK 21
PKA 21**

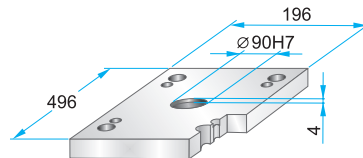
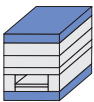

PK 21 - 196 x 496 x h / material
PKA 21 - 196 x 496 x h / material

27	1730
	2312
	2085

**PK 22
PKA 22**

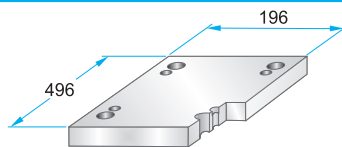

PK 22 - 196 x 496 x h / material
PKA 22 - 196 x 496 x h / material

27	1730
	2312
	2085

**PK 03
PKA 03**

Podcięcia do demontażu
na życzenie.
Corner undercuts upon request.

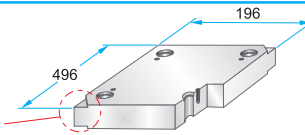

PK 03 - 196 x 496 x h / material
PKA 03 - 196 x 496 x h / material

PK 35 - 196 x 446 x h / material
PKA 35 - 196 x 446 x h / (a1/b1/h1)

22	1730
27	2083
36	2085
46	2162
56	2311
66	2312
76	2738
86	Toolox33
96	Toolox44
	2738HH
	2714HH

**PK 35
PKA 35**

Podcięcia do demontażu
na życzenie.
Corner undercuts upon request.

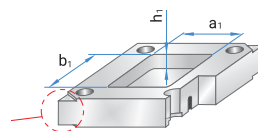

Material info



Korpus formy

Mold base

196x496

**PK 31
PKA 31**

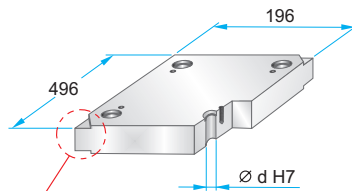
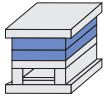

Podcięcia do demontażu na życzenie.
Corner undercuts upon request.



	d
PK 31	29,4
PKA 31	29,5

Material info



PK 31 - 196 x 496 x	h	/	material
PKA 31 - 196 x 496 x	h	/	
	22	/	1730
	27	/	2083
	36	/	2085
	46	/	2162
	56	/	2311
	66	/	2312
	76	/	2343
	86	/	2738
	96	/	2767
			Toolox33
			Toolox44
			2738HH
			2714HH

**PK 04
PKA 04**

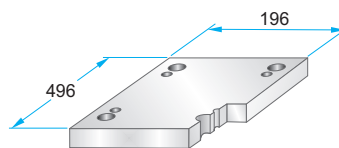
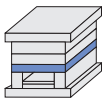

PK 04 - 196 x 496 x	h	/	material
PKA 04 - 196 x 496 x	h	/	
	27	/	1730
	36	/	2312
	46	/	2085
	56	/	

**PK 05
PKA 05**

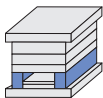

	A	B	M
PK 05	43	110	-
PKA 05	44	108	M10

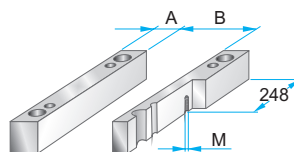

PK 05 - 196 x 496 x	h	/	material
PKA 05 - 196 x 496 x	h	/	
	56	/	1730
	66	/	2085
	76	/	
	86	/	
	96	/	
	116	/	

**PK 55
PKA 55**

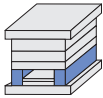

	A	B	M
PK 55	58	80	-
PKA 55	60	76	M10

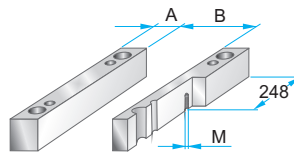

PK 55 - 196 x 496 x	h	/	material
PKA 55 - 196 x 496 x	h	/	
	56	/	1730
	66	/	2085
	76	/	
	86	/	
	96	/	
	116	/	

**PK 06
PKA 06**

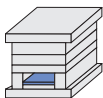

	A	B	C
PK 06	430	90	108
PKA 06	400	80	106

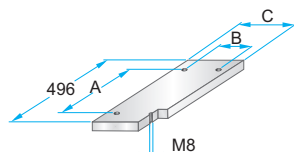

PK 06 - 196 x 496 x	h	/	material
PKA 06 - 196 x 496 x	h	/	
	17	/	1730
		/	2085

**PK 65
PKA 65**

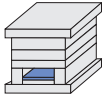

	A	B	C
PK 65	430	58	76
PKA 65	400	48	74

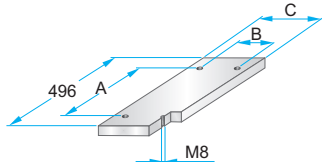

PK 65 - 196 x 496 x	h	/	material
PKA 65 - 196 x 496 x	h	/	
	17	/	1730
		/	2085

**PK 07
PKA 07**

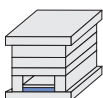

	A	B	C	D	M
PK 07	430	90	108	464	M4
PKA 07	400	80	106	470	M5

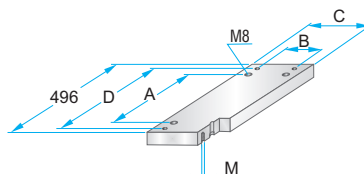

PK 07 - 196 x 496 x	h	/	material
PKA 07 - 196 x 496 x	h	/	
	22	/	1730
		/	2312
		/	2085

**PK 75
PKA 75**

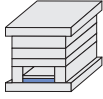

	A	B	C	D	M
PK 75	430	58	76	464	M4
PKA 75	400	48	74	470	M5

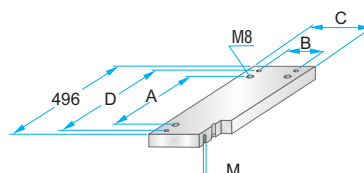

PK 75 - 196 x 496 x	h	/	material
PKA 75 - 196 x 496 x	h	/	
	22	/	1730
		/	2312
		/	2085