

Korpus formy

Mold base

296x296

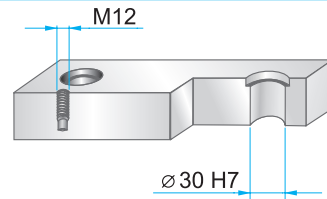
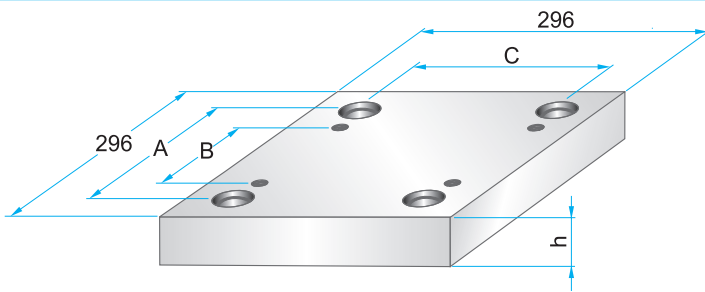

Wymiary i tolerancje
Dimensions and tolerances



	A	B	C
PK	244	186	250
PKA	248	170	248

**PK 01
PKA 01**

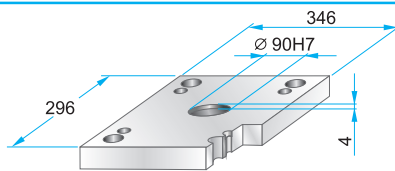
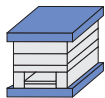

PK 01 - 296 x 296 x h / material
PKA 01 - 296 x 296 x h / material

27	1730
36	2312
46	2085

**PK 11
PKA 11**

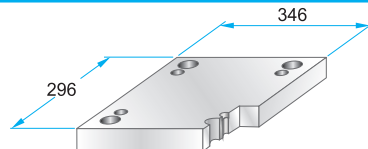
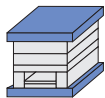

PK 11 - 296 x 296 x h / material
PKA 11 - 296 x 296 x h / material

27	1730
36	2312
46	2085

**PK 02
PKA 02**

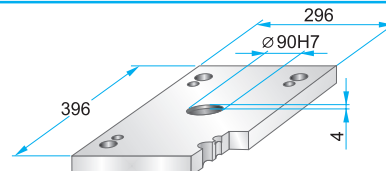

PK 02 - 296 x 296 x h / material
PKA 02 - 296 x 296 x h / material

27	1730
36	2312
	2085

**PK 12
PKA 12**

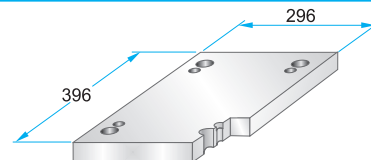

PK 12 - 296 x 296 x h / material
PKA 12 - 296 x 296 x h / material

27	1730
36	2312
	2085

**PK 21
PKA 21**

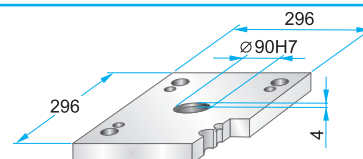
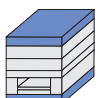

PK 21 - 296 x 296 x h / material
PKA 21 - 296 x 296 x h / material

22	1730
27	2312
36	2085

**PK 22
PKA 22**

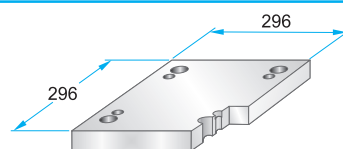

PK 22 - 296 x 296 x h / material
PKA 22 - 296 x 296 x h / material

22	1730
27	2312
36	2085

**PK 03
PKA 03**

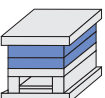

Podcięcia do demontażu
na życzenie.
Corner undercuts upon request.

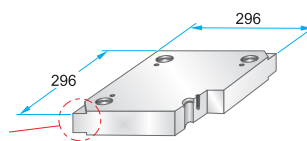

PK 03 - 296 x 296 x h / material
PKA 03 - 296 x 296 x h / material

PK 35 - 296 x 296 x h / material
PKA 35 - 296 x 296 x h / (a1/b1/h1)

17	1730
22	2083
27	2085
36	2162
46	2311
56	2312
66	2738
76	Toolox33
86	Toolox44
96	2738HH
116	2714HH
136	
156	

**PK 35
PKA 35**

Podcięcia do demontażu
na życzenie.
Corner undercuts upon request.

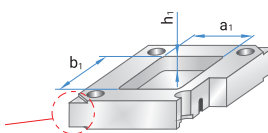

Material info



Korpus formy

Mold base

296x296

**PK 31
PKA 31**

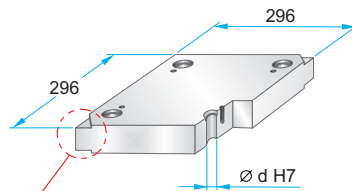
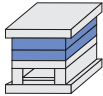

Podcięcia do demontażu na życzenie.
Corner undercuts upon request.



	d
PK 31	29,4
PKA 31	29,5

Material info

PK 31 – 296 x 296 x	h /	material
PKA 31 – 296 x 296 x	h /	
	22	1730
	27	2083
	36	2085
	46	2162
	56	2311
	66	2312
	76	2343
	86	2738
	96	2767
	116	Toolox33
	136	Toolox44
		2738HH
		2714HH

**PK 04
PKA 04**

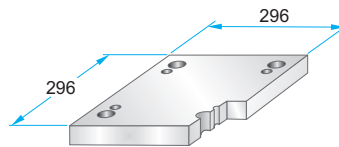
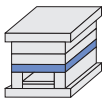

PK 04 – 296 x 296 x	h /	material
PKA 04 – 296 x 296 x	h /	
	27	1730
	36	2312
	46	2085
	56	
	66	
	76	
	86	

**PK 05
PKA 05**

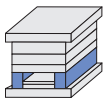

	A	B	M
PK 05	43	210	–
PKA 05	44	208	M10

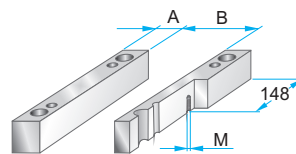

PK 05 – 296 x 296 x	h /	material
PKA 05 – 296 x 296 x	h /	
	56	1730
	66	2085
	76	
	86	
	96	
	116	

**PK 55
PKA 55**

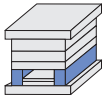

	A	B	M
PK 55	58	180	–
PKA 55	60	176	M10

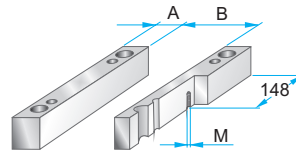

PK 55 – 296 x 296 x	h /	material
PKA 55 – 296 x 296 x	h /	
	56	1730
	66	2085
	76	
	86	
	96	
	116	

**PK 06
PKA 06**

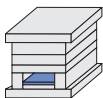

	A	B	C
PK 06	230	180	208
PKA 06	200	180	206

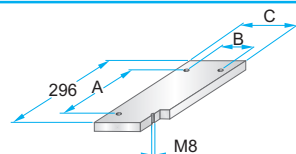

PK 06 – 296 x 296 x	h /	material
PKA 06 – 296 x 296 x	h /	
	12	1730
		2085

**PK 65
PKA 65**

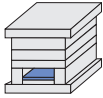

	A	B	C
PK 65	230	148	176
PKA 65	200	146	172

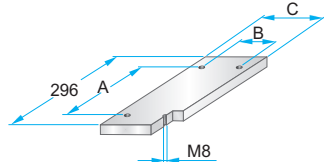

PK 65 – 296 x 296 x	h /	material
PKA 65 – 296 x 296 x	h /	
	12	1730
		2085

**PK 07
PKA 07**

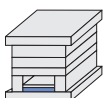

	A	B	C	D	M
PK 07	230	180	208	266	M4
PKA 07	200	180	206	270	M5

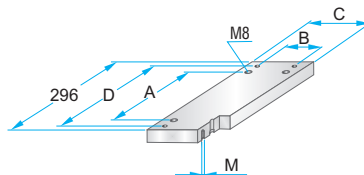

PK 07 – 296 x 296 x	h /	material
PKA 07 – 296 x 296 x	h /	
	17	1730
	22	2312
		2085

**PK 75
PKA 75**

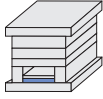

	A	B	C	D	M
PK 75	230	148	176	266	M4
PKA 75	200	146	172	270	M5

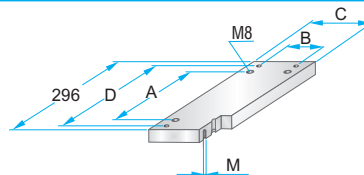

PK 75 – 296 x 296 x	h /	material
PKA 75 – 296 x 296 x	h /	
	17	1730
	22	2312
		2085