

**Korpus formy**

Mold base

**296x396**

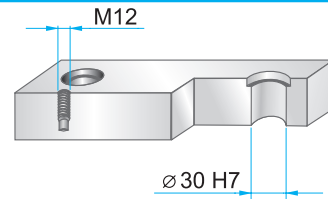
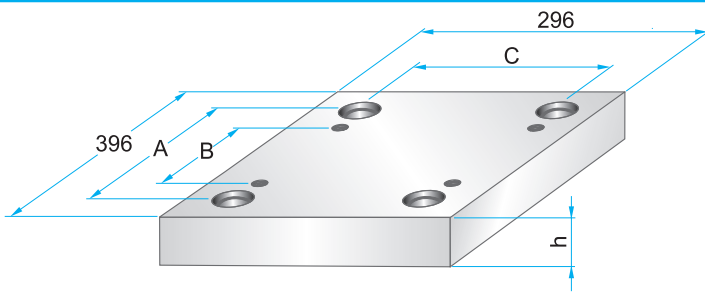

Wymiary i tolerancje  
Dimensions and tolerances



	A	B	C
<b>PK</b>	340	284	248
<b>PKA</b>	348	270	248

**PK 01  
PKA 01**

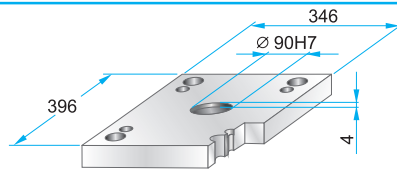
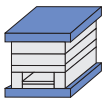

**PK 01** – 296 x 396 x h / material  
**PKA 01** – 296 x 396 x h / material

27	1730
36	2312
46	2085

**PK 11  
PKA 11**

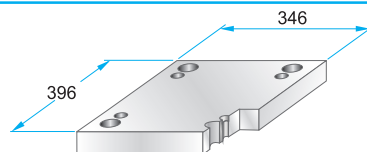
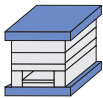

**PK 11** – 296 x 396 x h / material  
**PKA 11** – 296 x 396 x h / material

27	1730
36	2312
46	2085

**PK 02  
PKA 02**

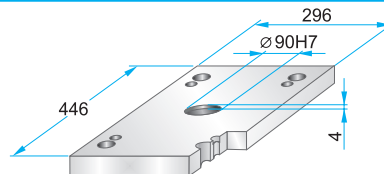
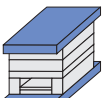

**PK 02** – 296 x 396 x h / material  
**PKA 02** – 296 x 396 x h / material

27	1730
36	2312
	2085

**PK 12  
PKA 12**

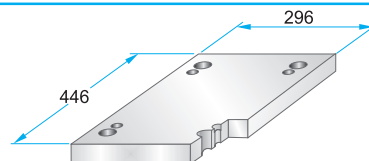

**PK 12** – 296 x 396 x h / material  
**PKA 12** – 296 x 396 x h / material

27	1730
36	2312
	2085

**PK 21  
PKA 21**

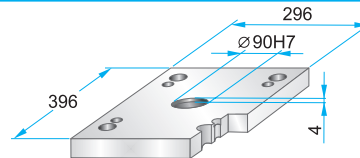

**PK 21** – 296 x 396 x h / material  
**PKA 21** – 296 x 396 x h / material

22	1730
27	2312
36	2085

**PK 22  
PKA 22**

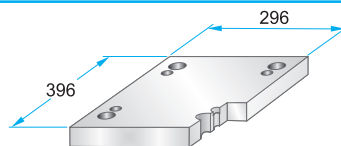

**PK 22** – 296 x 396 x h / material  
**PKA 22** – 296 x 396 x h / material

22	1730
27	2312
36	2085

**PK 03  
PKA 03**

Podcięcia do demontażu  
na życzenie.  
Corner undercuts upon request.

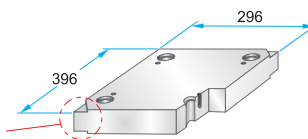

**PK 35  
PKA 35**

Podcięcia do demontażu  
na życzenie.  
Corner undercuts upon request.

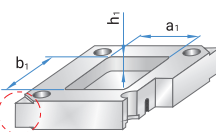

**PK 03** – 296 x 396 x h / material  
**PKA 03** – 296 x 396 x h / material

**PK 35** – 296 x 396 x h / material  
**PKA 35** – 296 x 396 x h / (a1/b1/h1)

17	1730
22	2083
27	2085
36	2162
46	2311
56	2312
66	2738
76	Toolox33
86	Toolox44
96	2738HH
116	2714HH
136	
156	

Material info



**Korpus formy**

Mold base

**296x396**

**PK 31  
PKA 31**

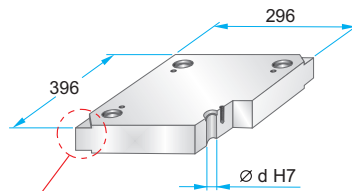
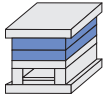

Podcięcia do demontażu na życzenie.  
Corner undercuts upon request.



	d
<b>PK 31</b>	29,4
<b>PKA 31</b>	29,5

Material info



PK 31 – 296 x 396 x	h	/	material
PKA 31 – 296 x 396 x	h	/	
	22	/	1730
	27	/	2083
	36	/	2085
	46	/	2162
	56	/	2311
	66	/	2312
	76	/	2343
	86	/	2738
	96	/	2767
	116	/	Toolox33
	136	/	Toolox44 2738HH 2714HH

**PK 04  
PKA 04**

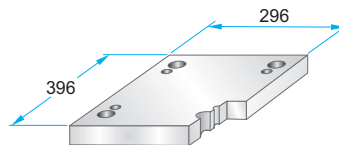
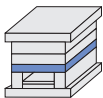

**PK 04 – 296 x 396 x**    **h /**    **material**  
**PKA 04 – 296 x 396 x**    **h /**   

	27	/	1730
	36	/	2312
	46	/	2085
	56	/	
	66	/	
	76	/	
	86	/	

**PK 05  
PKA 05**

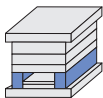

	A	B	M
<b>PK 05</b>	47	202	–
<b>PKA 05</b>	44	208	M10

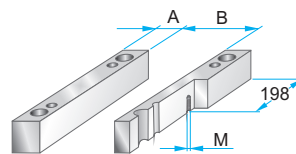

**PK 05 – 296 x 396 x**    **h /**    **material**  
**PKA 05 – 296 x 396 x**    **h /**   

	56	/	1730
	66	/	2085
	76	/	
	86	/	
	96	/	
	116	/	

**PK 55  
PKA 55**

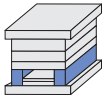

	A	B	M
<b>PK 55</b>	62	172	–
<b>PKA 55</b>	60	176	M10

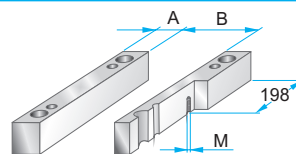

**PK 55 – 296 x 396 x**    **h /**    **material**  
**PKA 55 – 296 x 396 x**    **h /**   

	56	/	1730
	66	/	2085
	76	/	
	86	/	
	96	/	
	116	/	

**PK 06  
PKA 06**

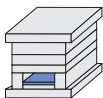

	A	B	C
<b>PK 06</b>	330	176	200
<b>PKA 06</b>	300	180	206

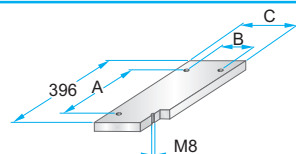

**PK 06 – 296 x 396 x**    **h /**    **material**  
**PKA 06 – 296 x 396 x**    **h /**   

	17	/	1730
		/	2085

**PK 65  
PKA 65**

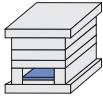

	A	B	C
<b>PK 65</b>	330	144	168
<b>PKA 65</b>	300	146	172

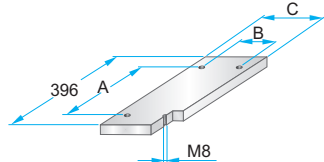

**PK 65 – 296 x 396 x**    **h /**    **material**  
**PKA 65 – 296 x 396 x**    **h /**   

	17	/	1730
		/	2085

**PK 07  
PKA 07**

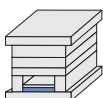

	A	B	C	D	M
<b>PK 07</b>	330	176	200	364	M4
<b>PKA 07</b>	300	180	206	370	M5

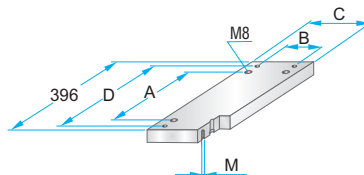

**PK 07 – 296 x 396 x**    **h /**    **material**  
**PKA 07 – 296 x 396 x**    **h /**   

	22	/	1730
		/	2312
		/	2085

**PK 75  
PKA 75**

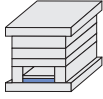

	A	B	C	D	M
<b>PK 75</b>	330	144	168	364	M4
<b>PKA 75</b>	300	146	172	370	M5

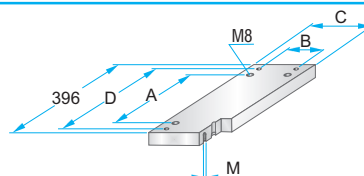

**PK 75 – 296 x 396 x**    **h /**    **material**  
**PKA 75 – 296 x 396 x**    **h /**   

	22	/	1730
		/	2312
		/	2085