

Korpus formy

Mold base

296x446

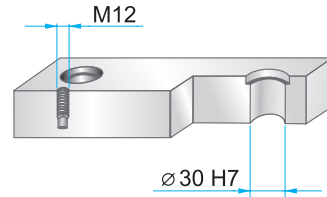
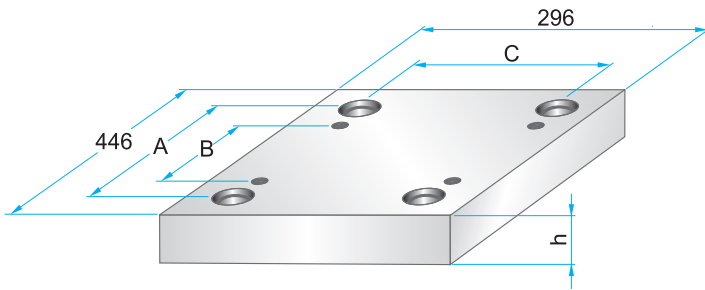

Wymiary i tolerancje
Dimensions and tolerances



	A	B	C
PK	394	324	244
PKA	398	320	248

**PK 01
PKA 01**

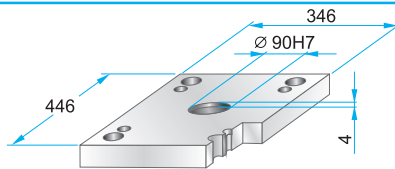
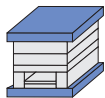

PK 01 – 296 x 446 x h / material
PKA 01 – 296 x 446 x h / material

27	1730
36	2312
46	2085

**PK 11
PKA 11**

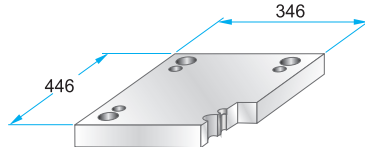
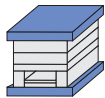

PK 11 – 296 x 446 x h / material
PKA 11 – 296 x 446 x h / material

27	1730
36	2312
46	2085

PKA 02

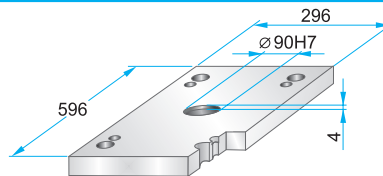
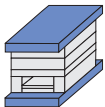

PKA 02 – 296 x 446 x h / material

27	1730
36	2312
	2085

PKA 12

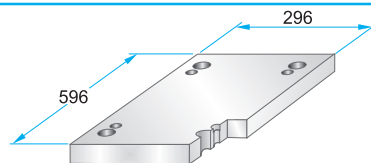

PKA 12 – 296 x 446 x h / material

27	1730
36	2312
	2085

**PK 21
PKA 21**

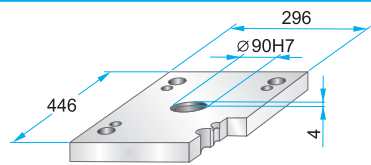
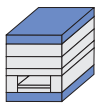

PK 21 – 296 x 446 x h / material
PKA 21 – 296 x 446 x h / material

27	1730
36	2312
	2085

**PK 22
PKA 22**

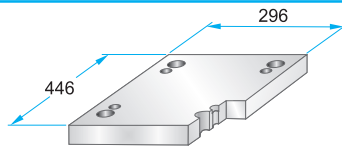

PK 22 – 296 x 446 x h / material
PKA 22 – 296 x 446 x h / material

27	1730
36	2312
	2085

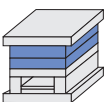

**PK 03
PKA 03**

Podcięcia do demontażu
na życzenie.
Corner undercuts upon request.

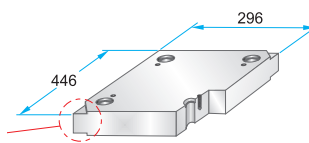

PK 03 – 296 x 446 x h / material
PKA 03 – 296 x 446 x h / material

PK 35 – 296 x 446 x h / material
PKA 35 – 296 x 446 x h / (a1/b1/h1)

17	1730
22	2083
27	2085
36	2162
46	2311
56	2312
66	2738
76	Toolox33
86	Toolox44
96	2738HH
116	2714HH
136	
156	

**PK 35
PKA 35**

Podcięcia do demontażu
na życzenie.
Corner undercuts upon request.

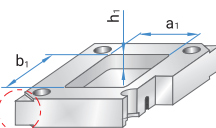

Material info



Korpus formy

Mold base

296x446

**PK 31
PKA 31**

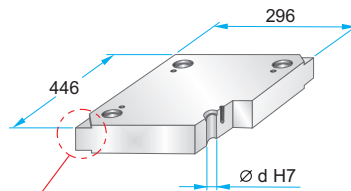
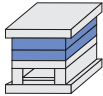

Podcięcia do demontażu na życzenie.
Corner undercuts upon request.



	d
PK 31	29,4
PKA 31	29,5

Material info



PK 31 – 296 x 446 x	h	/	material
PKA 31 – 296 x 446 x	h	/	
	27	/	1730
	36	/	2083
	46	/	2085
	56	/	2162
	66	/	2311
	76	/	2312
	86	/	2343
	96	/	2738
	116	/	2767
	136	/	Toolox33
		/	Toolox44
		/	2738HH
		/	2714HH

**PK 04
PKA 04**

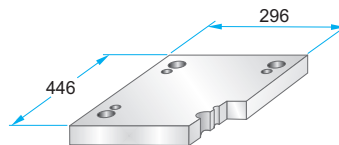
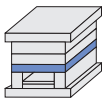

PK 04 – 296 x 446 x **h / material**
PKA 04 – 296 x 446 x **h /**

	36	/	1730
	46	/	2312
	56	/	2085
	66	/	
	76	/	
	86	/	

**PK 05
PKA 05**

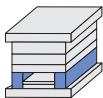

	A	B	M
PK 05	43	210	-
PKA 05	44	208	M10

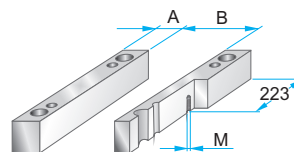

PK 05 – 296 x 446 x **h / material**
PKA 05 – 296 x 446 x **h /**

	56	/	1730
	66	/	2085
	76	/	
	86	/	
	96	/	
	116	/	

**PK 55
PKA 55**

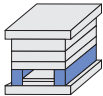

	A	B	M
PK 55	58	180	-
PKA 55	60	176	M10

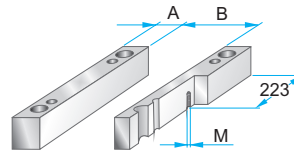

PK 55 – 296 x 446 x **h / material**
PKA 55 – 296 x 446 x **h /**

	56	/	1730
	66	/	2085
	76	/	
	86	/	
	96	/	
	116	/	

**PK 06
PKA 06**

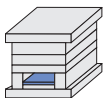

	A	B	C
PK 06	380	184	208
PKA 06	350	180	206

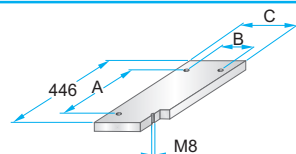

PK 06 – 296 x 446 x **h / material**
PKA 06 – 296 x 446 x **h /**

	17	/	1730
		/	2085

**PK 65
PKA 65**

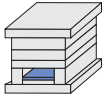

	A	B	C
PK 65	380	152	176
PKA 65	350	146	172

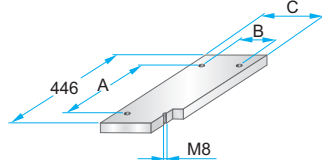

PK 65 – 296 x 446 x **h / material**
PKA 65 – 296 x 446 x **h /**

	17	/	1730
		/	2085

**PK 07
PKA 07**

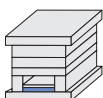

	A	B	C	D	M
PK 07	380	184	208	414	M4
PKA 07	350	180	206	420	M5

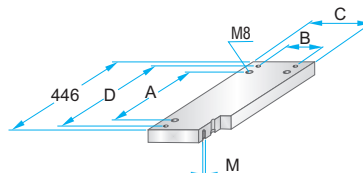

PK 07 – 296 x 446 x **h / material**
PKA 07 – 296 x 446 x **h /**

	22	/	1730
		/	2312
		/	2085

**PK 75
PKA 75**

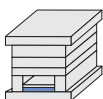

	A	B	C	D	M
PK 75	380	152	176	414	M4
PKA 75	350	146	172	420	M5

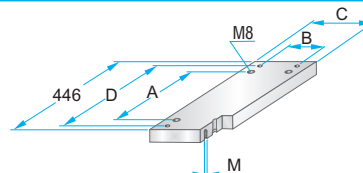

PK 75 – 296 x 446 x **h / material**
PKA 75 – 296 x 446 x **h /**

	22	/	1730
		/	2312
		/	2085