

**Korpus formy**

Mold base

**296x496**

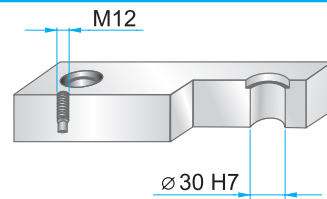
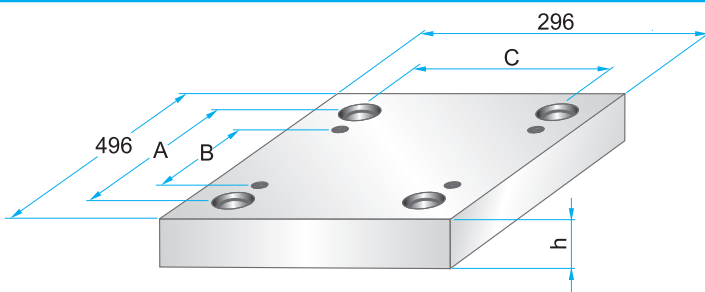

Wymiary i tolerancje  
Dimensions and tolerances



	A	B	C
<b>PK</b>	444	374	244
<b>PKA</b>	448	370	248

**PK 01  
PKA 01**

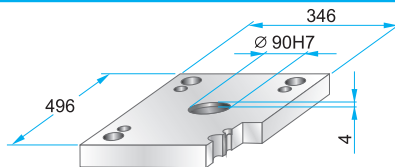

**PK 01** – 296 x 496 x h / material  
**PKA 01** – 296 x 496 x h / material

27	1730
36	2312
	2085

**PK 11  
PKA 11**

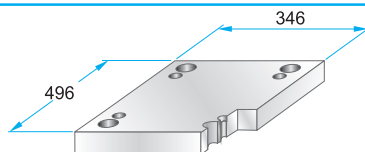

**PK 11** – 296 x 496 x h / material  
**PKA 11** – 296 x 496 x h / material

27	1730
36	2312
	2085

**PKA 02**

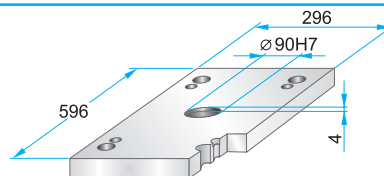
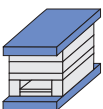

**PKA 02** – 296 x 496 x h / material

27	1730
	2312
	2085

**PKA 12**

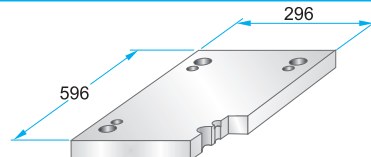
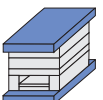

**PKA 12** – 296 x 496 x h / material

27	1730
	2312
	2085

**PK 21  
PKA 21**

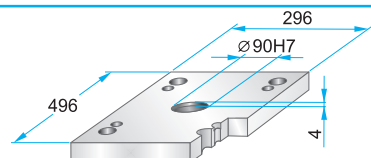
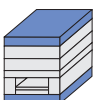

**PK 21** – 296 x 496 x h / material  
**PKA 21** – 296 x 496 x h / material

27	1730
36	2312
	2085

**PK 22  
PKA 22**

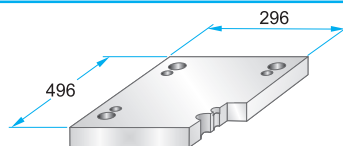

**PK 22** – 296 x 496 x h / material  
**PKA 22** – 296 x 496 x h / material

27	1730
36	2312
	2085

**PK 03  
PKA 03**

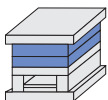

Podcięcia do demontażu  
na życzenie.  
Corner undercuts upon request.

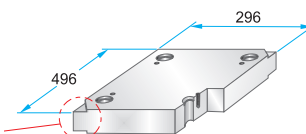

**PK 03** – 296 x 496 x h / material  
**PKA 03** – 296 x 496 x h / material

**PK 35** – 296 x 496 x h / material  
**PKA 35** – 296 x 496 x h / (a1/b1/h1)

22	1730
27	2083
36	2085
46	2162
56	2311
66	2312
76	2738
86	Toolox33
96	Toolox44
116	2738HH
136	2714HH
156	

**PK 35  
PKA 35**

Podcięcia do demontażu  
na życzenie.  
Corner undercuts upon request.

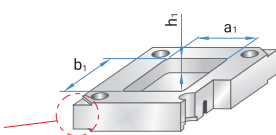

Material info



**Korpus formy**

Mold base

**296x496**

**PK 31  
PKA 31**

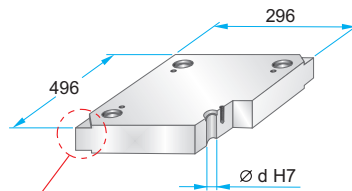
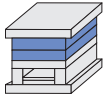

Podcięcia do demontażu na życzenie.  
Corner undercuts upon request.



	d
<b>PK 31</b>	29,4
<b>PKA 31</b>	29,5

Material info



PK 31 – 296 x 496 x	h	/	material
PKA 31 – 296 x 496 x	h	/	
	27		1730
	36		2083
	46		2085
	56		2162
	66		2311
	76		2312
	86		2343
	96		2738
	116		2767
	136		Toolox33 Toolox44 2738HH 2714HH

**PK 04  
PKA 04**

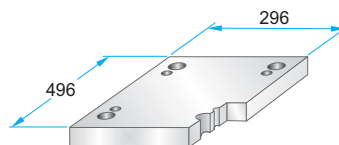
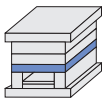

PK 04 – 296 x 496 x	h	/	material
PKA 04 – 296 x 496 x	h	/	
	36		1730
	46		2312
	56		2085
	66		
	76		

**PK 05  
PKA 05**

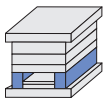

	A	B	M
<b>PK 05</b>	43	210	–
<b>PKA 05</b>	44	208	M10

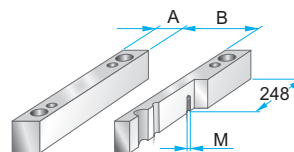

PK 05 – 296 x 496 x	h	/	material
PKA 05 – 296 x 496 x	h	/	
	56		1730
	66		2085
	76		
	86		
	96		
	116		

**PK 55  
PKA 55**

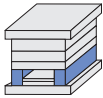

	A	B	M
<b>PK 55</b>	58	180	–
<b>PKA 55</b>	60	176	M10

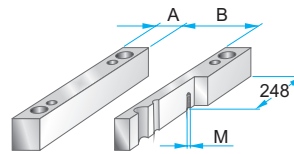

PK 55 – 296 x 496 x	h	/	material
PKA 55 – 296 x 496 x	h	/	
	56		1730
	66		2085
	76		
	86		
	96		
	116		

**PK 06  
PKA 06**

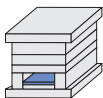

	A	B	C
<b>PK 06</b>	418	180	208
<b>PKA 06</b>	400	180	206

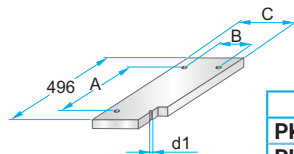

	d1
<b>PK 06</b>	M10
<b>PKA 06</b>	M8

PK 06 – 296 x 496 x	h	/	material
PKA 06 – 296 x 496 x	h	/	
	17		1730 2085

**PK 65  
PKA 65**

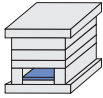

	A	B	C
<b>PK 65</b>	418	148	176
<b>PKA 65</b>	400	146	172

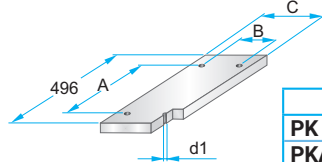

	d1
<b>PK 65</b>	M10
<b>PKA 65</b>	M8

PK 65 – 296 x 496 x	h	/	material
PKA 65 – 296 x 496 x	h	/	
	17		1730 2085

**PK 07  
PKA 07**

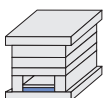

	A	B	C	D	M
<b>PK 07</b>	418	180	208	464	M4
<b>PKA 07</b>	400	180	206	470	M5

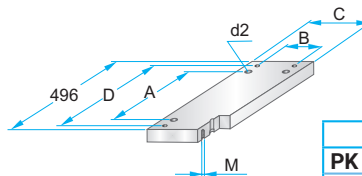

	d2
<b>PK 07</b>	M10
<b>PKA 07</b>	M8

PK 07 – 296 x 496 x	h	/	material
PKA 07 – 296 x 496 x	h	/	
	22		1730 2312 2085

**PK 75  
PKA 75**

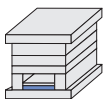

	A	B	C	D	M
<b>PK 75</b>	418	148	176	464	M4
<b>PKA 75</b>	400	146	172	470	M5

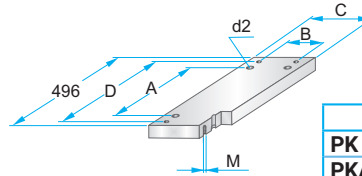

	d2
<b>PK 75</b>	M10
<b>PKA 75</b>	M8

PK 75 – 296 x 496 x	h	/	material
PKA 75 – 296 x 496 x	h	/	
	22		1730 2312 2085