

**Korpus formy**

Mold base

**296x646**

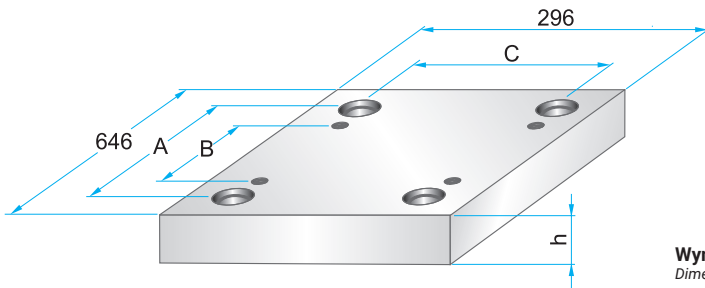

**Wymiary i tolerancje**  
Dimensions and tolerances



	A	B	C	d	d2
<b>PK</b>	574	480	224	42	M16
<b>PKA</b>	598	520	248	30	M12

**PK 01  
PKA 01**

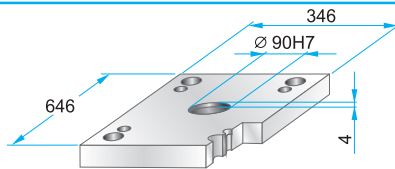
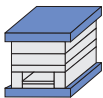

**PK 01** – 296 x 646 x h / material  
**PKA 01** – 296 x 646 x h / material

36	1730
	2312
	2085

**PK 11  
PKA 11**

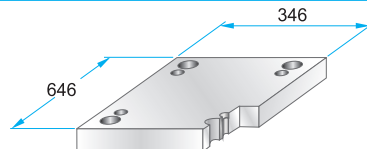

**PK 11** – 296 x 646 x h / material  
**PKA 11** – 296 x 646 x h / material

36	1730
	2312
	2085

**PK 02  
PKA 02**

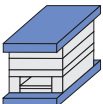

**PK 12  
PKA 12**

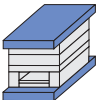

**PK 21  
PKA 21**

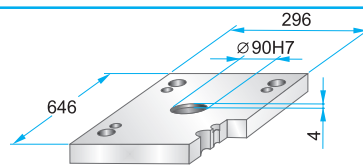
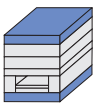

**PK 21** – 296 x 646 x h / material  
**PKA 21** – 296 x 646 x h / material

27	1730
36	2312
	2085

**PK 22  
PKA 22**

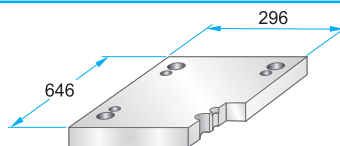

**PK 22** – 296 x 646 x h / material  
**PKA 22** – 296 x 646 x h / material

27	1730
36	2312
	2085



**PK 03  
PKA 03**

Podcięcia do demontażu  
na życzenie.  
Corner undercuts upon request.

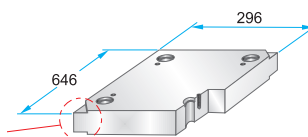

**PK 35  
PKA 35**

Podcięcia do demontażu  
na życzenie.  
Corner undercuts upon request.

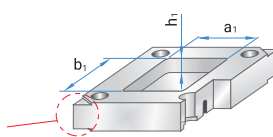

**PK 03** – 296 x 646 x h / material  
**PKA 03** – 296 x 646 x h / material

**PK 35** – 296 x 646 x h / material  
**PKA 35** – 296 x 646 x h / (a1/b1/h1)

22	1730
27	2083
36	2085
46	2162
56	2311
66	2312
76	2738
86	Toolox33
96	Toolox44
116	2738HH
136	2714HH
156	

Material info



**Korpus formy**

Mold base

**296x646**

**PK 31**

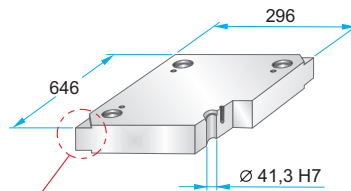
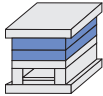

**PK 31 – 296 x 646 x h / material**

h	material
27	1730
36	2083
46	2085
56	2162
66	2311
76	2312
86	2343
96	2738
116	2767
136	Toolox33
	Toolox44
	2738HH
	2714HH

Podcięcia do demontażu na życzenie.  
Corner undercuts upon request.



Material info



**PK 04  
PKA 04**

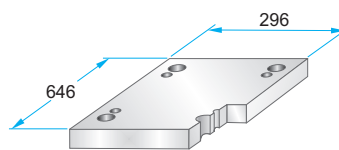
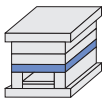

**PK 04 – 296 x 646 x h / material**  
**PKA 04 – 296 x 646 x h / material**

h	material
36	1730
46	2312
56	2085

**PK 05  
PKA 05**

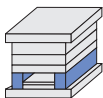

	A	B	M
<b>PK 05</b>	62	172	-
<b>PKA 05</b>	44	208	M10

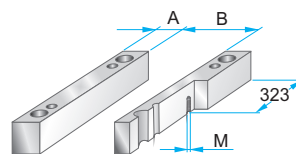

**PK 05 – 296 x 646 x h / material**  
**PKA 05 – 296 x 646 x h / material**

h	material
66	1730
76	2085
86	
96	
116	
136	

**PK 55  
PKA 55**

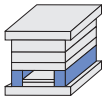

	A	B	M
<b>PK 55</b>	86	124	-
<b>PKA 55</b>	60	176	M10

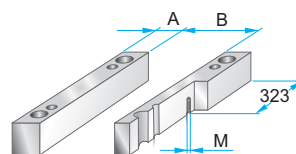

**PK 55 – 296 x 646 x h / material**  
**PKA 55 – 296 x 646 x h / material**

h	material
66	1730
76	2085
86	
96	
116	
136	

**PK 06  
PKA 06**

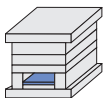

	A	B	C
<b>PK 06</b>	570	140	168
<b>PKA 06</b>	550	180	206

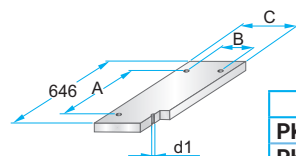

**PK 06 – 296 x 646 x h / material**  
**PKA 06 – 296 x 646 x h / material**

	d1
<b>PK 06</b>	M10
<b>PKA 06</b>	M8

h	material
22	1730
	2085

**PK 65  
PKA 65**

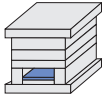

	A	B	C
<b>PK 65</b>	570	92	120
<b>PKA 65</b>	550	146	172

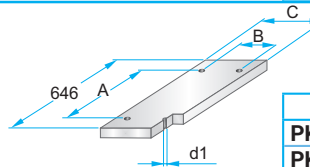

**PK 65 – 296 x 646 x h / material**  
**PKA 65 – 296 x 646 x h / material**

	d1
<b>PK 65</b>	M10
<b>PKA 65</b>	M8

h	material
22	1730
	2085

**PK 07  
PKA 07**

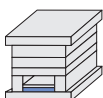

	A	B	C	D	M
<b>PK 07</b>	570	140	168	616	M4
<b>PKA 07</b>	550	180	206	620	M5

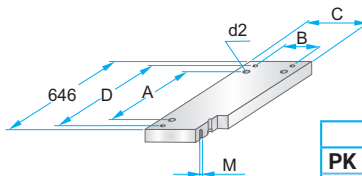

**PK 07 – 296 x 646 x h / material**  
**PKA 07 – 296 x 646 x h / material**

	d2
<b>PK 07</b>	M10
<b>PKA 07</b>	M8

h	material
27	1730
	2312
	2085

**PK 75  
PKA 75**

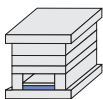

	A	B	C	D	M
<b>PK 75</b>	570	92	120	616	M4
<b>PKA 75</b>	550	146	172	620	M5

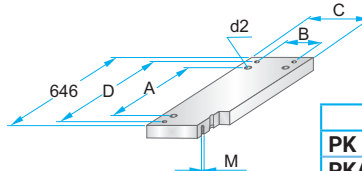

**PK 75 – 296 x 646 x h / material**  
**PKA 75 – 296 x 646 x h / material**

	d2
<b>PK 75</b>	M10
<b>PKA 75</b>	M8

h	material
27	1730
	2312
	2085