

Korpus formy

Mold base

296x696

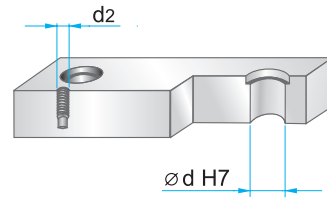
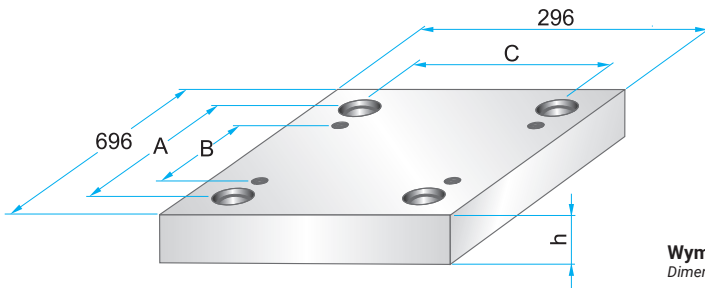

Wymiary i tolerancje
Dimensions and tolerances



	A	B	C	d	d2
PK	624	530	224	42	M16
PKA	648	570	248	30	M12

**PK 01
PKA 01**

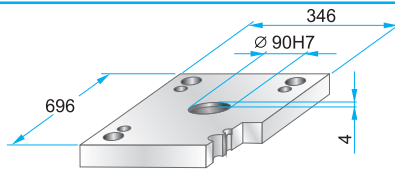
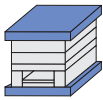

PK 01 – 296 x 696 x h / material
PKA 01 – 296 x 696 x h / material

36	1730
46	2312
	2085

**PK 11
PKA 11**

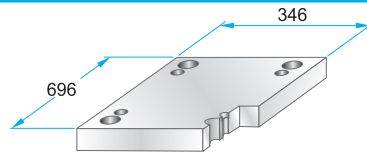
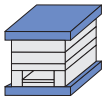

PK 11 – 296 x 696 x h / material
PKA 11 – 296 x 696 x h / material

36	1730
46	2312
	2085

**PK 02
PKA 02**

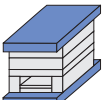

**PK 12
PKA 12**

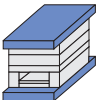

**PK 21
PKA 21**

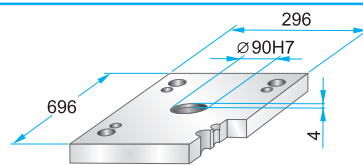
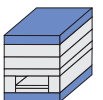

PK 21 – 296 x 696 x h / material
PKA 21 – 296 x 696 x h / material

27	1730
36	2312
	2085

**PK 22
PKA 22**

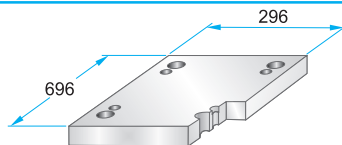

PK 22 – 296 x 696 x h / material
PKA 22 – 296 x 696 x h / material

27	1730
36	2312
	2085

**PK 03
PKA 03**

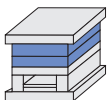

Podcięcia do demontażu
na życzenie.
Corner undercuts upon request.

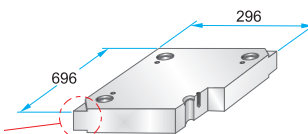

PK 03 – 296 x 696 x h / material
PKA 03 – 296 x 696 x h / material

PK 35 – 296 x 696 x h / material
PKA 35 – 296 x 696 x h / (a1/b1/h1)

**PK 35
PKA 35**

Podcięcia do demontażu
na życzenie.
Corner undercuts upon request.

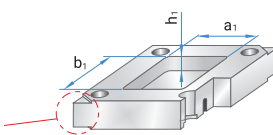

Material info



22	1730
27	2083
36	2085
46	2162
56	2311
66	2312
76	2738
86	Toolox33
96	Toolox44
116	2738HH
136	2714HH
156	

Korpus formy

Mold base

296x696

PK 31

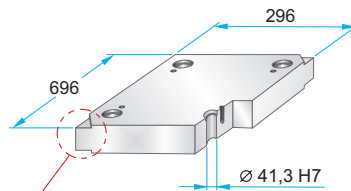
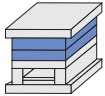

PK 31 – 296 x 696 x h / material

h	material
27	1730
36	2083
46	2085
56	2162
66	2311
76	2312
86	2343
96	2738
116	2767
136	Toolox33
	Toolox44
	2738HH
	2714HH

Podcięcia do demontażu na życzenie.
Corner undercuts upon request.



Material info



**PK 04
PKA 04**

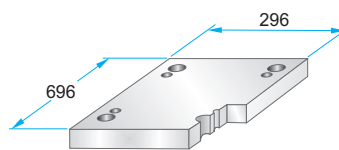
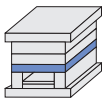

PK 04 – 296 x 696 x h / material
PKA 04 – 296 x 696 x h / material

h	material
36	1730
46	2312
56	2085

**PK 05
PKA 05**

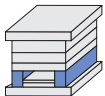

	A	B	M
PK 05	62	172	-
PKA 05	44	208	M10

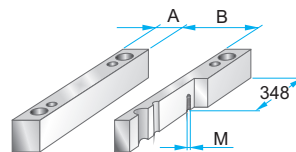

PK 05 – 296 x 696 x h / material
PKA 05 – 296 x 696 x h / material

h	material
66	1730
76	2085
86	
96	
116	
136	

**PK 55
PKA 55**

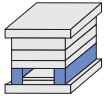

	A	B	M
PK 55	86	124	-
PKA 55	60	176	M10

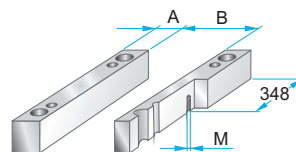

PK 55 – 296 x 696 x h / material
PKA 55 – 296 x 696 x h / material

h	material
66	1730
76	2085
86	
96	
116	
136	

**PK 06
PKA 06**

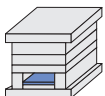

	A	B	C
PK 06	620	140	168
PKA 06	600	180	206

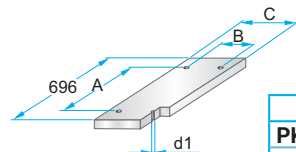

PK 06 – 296 x 696 x h / material
PKA 06 – 296 x 696 x h / material

	d1
PK 06	M10
PKA 06	M8

h	material
22	1730
	2085

**PK 65
PKA 65**

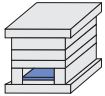

	A	B	C
PK 65	620	92	120
PKA 65	600	146	172

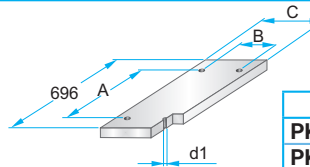

PK 65 – 296 x 696 x h / material
PKA 65 – 296 x 696 x h / material

	d1
PK 65	M10
PKA 65	M8

h	material
22	1730
	2085

**PK 07
PKA 07**

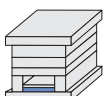

	A	B	C	D	M
PK 07	620	140	168	666	M4
PKA 07	600	180	206	670	M5

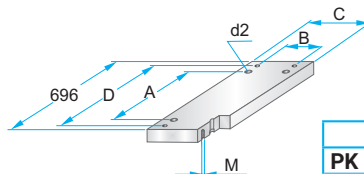

PK 07 – 296 x 696 x h / material
PKA 07 – 296 x 696 x h / material

	d2
PK 07	M10
PKA 07	M8

h	material
27	1730
	2312
	2085

**PK 75
PKA 75**

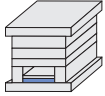

	A	B	C	D	M
PK 75	620	92	120	666	M4
PKA 75	600	146	172	670	M5

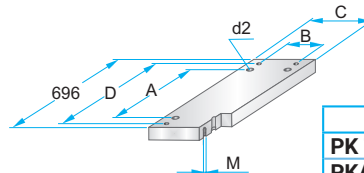

PK 75 – 296 x 696 x h / material
PKA 75 – 296 x 696 x h / material

	d2
PK 75	M10
PKA 75	M8

h	material
27	1730
	2312
	2085