

**Korpus formy**

Mold base

**316x396**

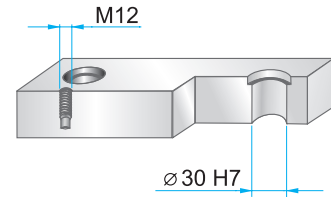
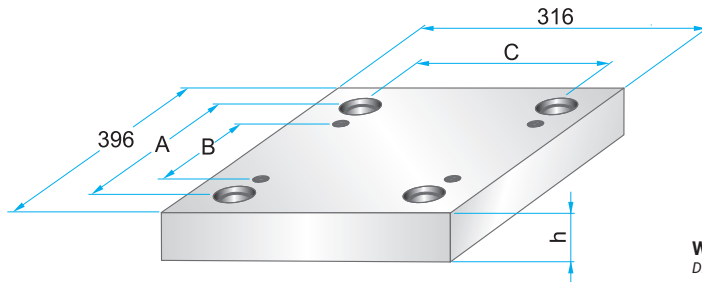

**Wymiary i tolerancje**  
Dimensions and tolerances



	A	B	C
<b>PKA</b>	348	270	268

**PKA 01**

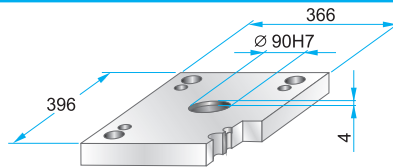

**PKA 01 – 316 x 396 x h / material**

27	1730
36	2312
	2085

**PKA 11**

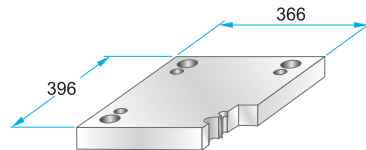

**PKA 11 – 316 x 396 x h / material**

27	1730
36	2312
	2085

**PKA 02**

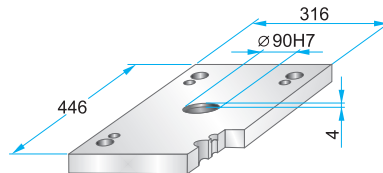
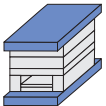

**PKA 02 – 316 x 396 x h / material**

27	1730
36	2312
	2085

**PKA 12**

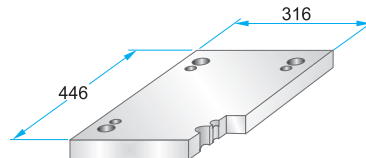
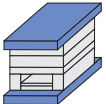

**PKA 12 – 316 x 396 x h / material**

27	1730
36	2312
	2085

**PKA 21**

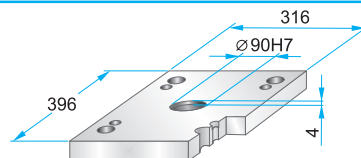

**PKA 21 – 316 x 396 x h / material**

27	1730
36	2312
	2085

**PKA 22**

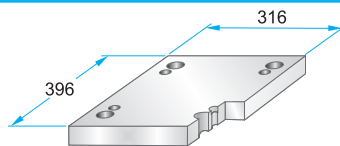
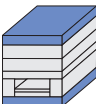

**PKA 22 – 316 x 396 x h / material**

27	1730
36	2312
	2085

**PK 03  
PKA 03**

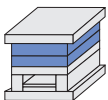

Podcięcia do demontażu  
na życzenie.  
Corner undercuts upon request.

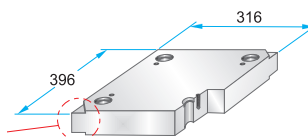

**PK 35  
PKA 35**

Podcięcia do demontażu  
na życzenie.  
Corner undercuts upon request.

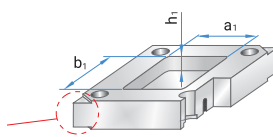

**PKA 03 – 316 x 396 x h / material**

**PKA 35 – 296 x 396 x h / material (a1/b1/h1)**

27	1730
36	2083
46	2085
56	2162
66	2311
76	2312
86	2738
96	Toolox33
116	Toolox44
136	2738HH
156	2714HH

Material info



**Korpus formy**

Mold base

**316x396**

**PKA 31**

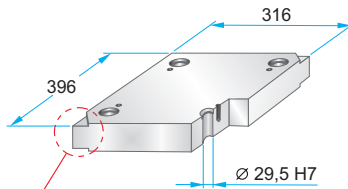
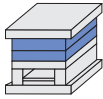

Podcięcia do demontażu na życzenie.  
Corner undercuts upon request.



Material info



**PKA 31 – 316 x 396 x h / material**

27	1730
36	2083
46	2085
56	2162
66	2311
76	2312
86	2343
96	2738
116	2767
136	Toolox33
156	Toolox44
	2738HH
	2714HH

**PKA 04**

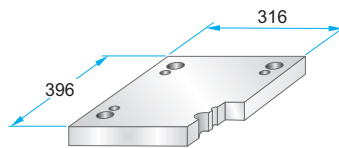
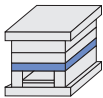

**PKA 04 – 316 x 396 x h / material**

36	1730
46	2312
56	2085
66	

**PKA 05**

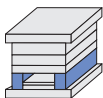

	A	B
<b>PKA 05</b>	44	228

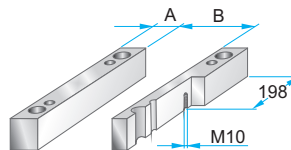

**PKA 05 – 316 x 396 x h / material**

56	1730
66	2085
76	
86	
96	
116	

**PKA 55**

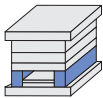

	A	B
<b>PKA 55</b>	60	196

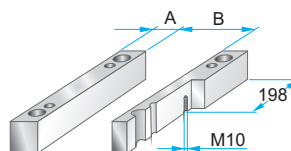

**PKA 55 – 316 x 396 x h / material**

56	1730
66	2085
76	
86	
96	
116	

**PKA 06**

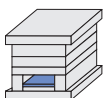

	A	B	C
<b>PKA 06</b>	300	200	226

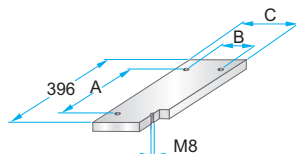

**PKA 06 – 316 x 396 x h / material**

17	1730
	2085

**PKA 65**

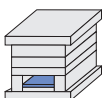

	A	B	C
<b>PKA 65</b>	300	168	194

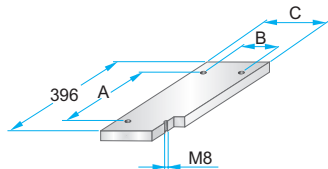

**PKA 65 – 316 x 396 x h / material**

17	1730
	2085

**PKA 07**

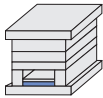

	A	B	C	D
<b>PKA 07</b>	300	200	226	370

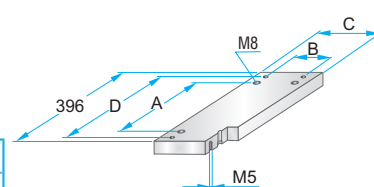

**PKA 07 – 316 x 396 x h / material**

22	1730
	2312
	2085

**PKA 75**

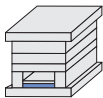

	A	B	C	D
<b>PKA 75</b>	300	168	194	370

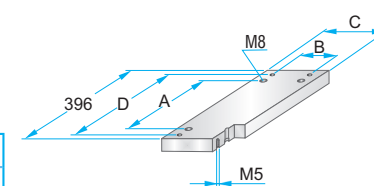

**PKA 75 – 316 x 396 x h / material**

22	1730
	2312
	2085