

Korpus formy

Mold base

346x446

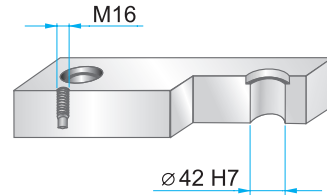
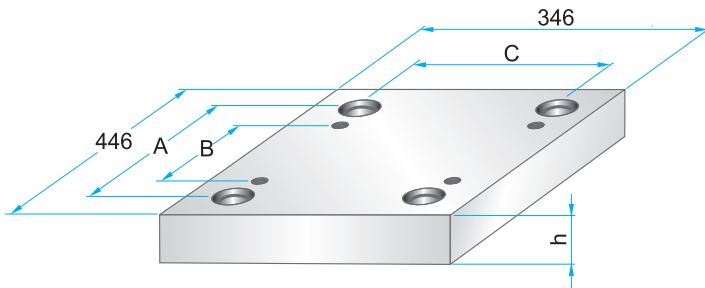

Wymiary i tolerancje
Dimensions and tolerances



| | A | B | C |
|------------|-----|-----|-----|
| PK | 374 | 280 | 274 |
| PKA | 374 | 280 | 274 |

**PK 01
PKA 01**

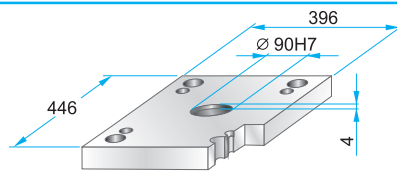

PK 01 – 346 x 446 x h / material
PKA 01 – 346 x 446 x h / material

| | |
|----|------|
| 27 | 1730 |
| 36 | 2312 |
| 46 | 2085 |

**PK 11
PKA 11**

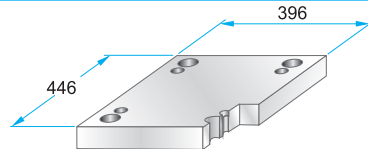
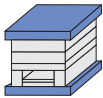

PK 11 – 346 x 446 x h / material
PKA 11 – 346 x 446 x h / material

| | |
|----|------|
| 27 | 1730 |
| 36 | 2312 |
| 46 | 2085 |

**PK 02
PKA 02**



| | L |
|---------------|-----|
| PK 02 | 496 |
| PKA 02 | 596 |

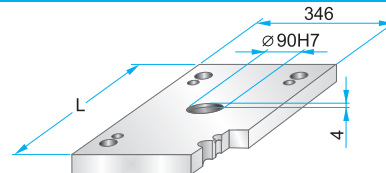

PK 02 – 346 x 446 x h / material
PKA 02 – 346 x 446 x h / material

| | |
|----|------|
| 27 | 1730 |
| 36 | 2312 |
| 46 | 2085 |

**PK 12
PKA 12**

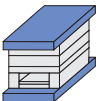

| | L |
|---------------|-----|
| PK 12 | 496 |
| PKA 12 | 596 |

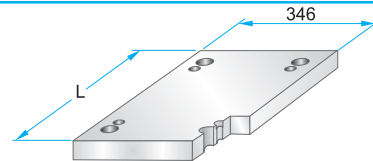

PK 12 – 346 x 446 x h / material
PKA 12 – 346 x 446 x h / material

| | |
|----|------|
| 27 | 1730 |
| 36 | 2312 |
| 46 | 2085 |

**PK 21
PKA 21**

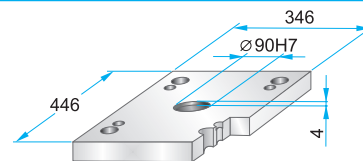
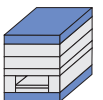

PK 21 – 346 x 446 x h / material
PKA 21 – 346 x 446 x h / material

| | |
|----|------|
| 22 | 1730 |
| 27 | 2312 |
| 36 | 2085 |
| 46 | |

**PK 22
PKA 22**

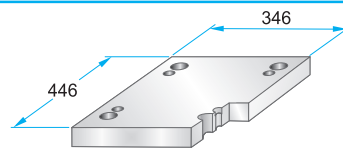

PK 22 – 346 x 446 x h / material
PKA 22 – 346 x 446 x h / material

| | |
|----|------|
| 22 | 1730 |
| 27 | 2312 |
| 36 | 2085 |
| 46 | |

**PK 03
PKA 03**

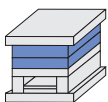

Podcięcia do demontażu
na życzenie.

Corner undercuts upon request.

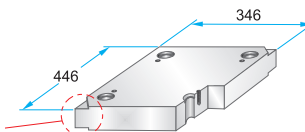

PK 03 – 346 x 446 x h / material
PKA 03 – 346 x 446 x h / material

PK 35 – 296 x 396 x h / material
PKA 35 – 296 x 396 x h / (a1/b1/h1)

| | |
|-----|----------|
| 22 | 1730 |
| 27 | 2083 |
| 36 | 2085 |
| 46 | 2162 |
| 56 | 2311 |
| 66 | 2312 |
| 76 | 2738 |
| 86 | Toolox33 |
| 96 | Toolox44 |
| 116 | 2738HH |
| 136 | 2714HH |
| 156 | |
| 176 | |

**PK 35
PKA 35**

Podcięcia do demontażu
na życzenie.

Corner undercuts upon request.

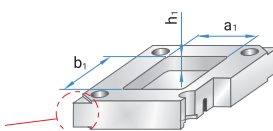

Material info



Korpus formy

Mold base

346x446

**PK 31
PKA 31**

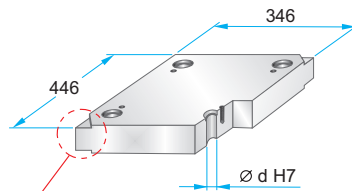
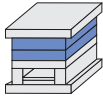

Podcięcia do demontażu na życzenie.
Corner undercuts upon request.



| | d |
|---------------|------|
| PK 31 | 41,3 |
| PKA 31 | 41,4 |

Material info



| PK 31 - 346 x 446 x h | h | material |
|------------------------|-----|----------|
| PKA 31 - 346 x 446 x h | h | |
| | 22 | 1730 |
| | 27 | 2083 |
| | 36 | 2085 |
| | 46 | 2162 |
| | 56 | 2311 |
| | 66 | 2312 |
| | 76 | 2343 |
| | 86 | 2738 |
| | 96 | 2767 |
| | 116 | Toolox33 |
| | 136 | Toolox44 |
| | 156 | 2738HH |
| | | 2714HH |

**PK 04
PKA 04**

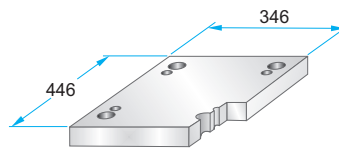
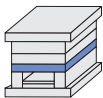

PK 04 - 346 x 446 x h / **material**
PKA 04 - 346 x 446 x h / **material**

| | | |
|---|----|------|
| h | 27 | 1730 |
| h | 36 | 2312 |
| h | 46 | 2085 |
| h | 56 | |
| h | 66 | |
| h | 76 | |
| h | 86 | |

**PK 05
PKA 05**

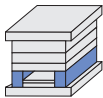

| | A | B | M |
|---------------|----|-----|-----|
| PK 05 | 62 | 222 | - |
| PKA 05 | 62 | 222 | M10 |

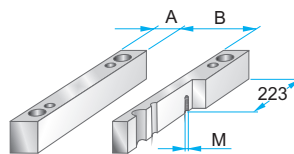

PK 05 - 346 x 446 x h / **material**
PKA 05 - 346 x 446 x h / **material**

| | | |
|---|-----|------|
| h | 56 | 1730 |
| h | 66 | 2085 |
| h | 76 | |
| h | 86 | |
| h | 96 | |
| h | 116 | |
| h | 136 | |

**PK 55
PKA 55**

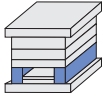

| | A | B | M |
|---------------|----|-----|-----|
| PK 55 | 86 | 174 | - |
| PKA 55 | 86 | 174 | M10 |

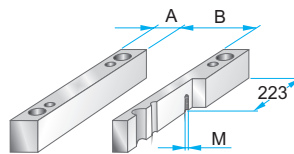

PK 55 - 346 x 446 x h / **material**
PKA 55 - 346 x 446 x h / **material**

| | | |
|---|-----|------|
| h | 56 | 1730 |
| h | 66 | 2085 |
| h | 76 | |
| h | 86 | |
| h | 96 | |
| h | 116 | |
| h | 136 | |

**PK 06
PKA 06**

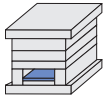

| | A | B | C |
|---------------|-----|-----|-----|
| PK 06 | 364 | 186 | 218 |
| PKA 06 | 310 | 180 | 218 |

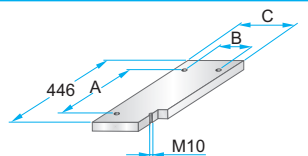

PK 06 - 346 x 446 x h / **material**
PKA 06 - 346 x 446 x h / **material**

| | | |
|---|----|------|
| h | 17 | 1730 |
| h | | 2085 |

**PK 65
PKA 65**



| | A | B | C |
|---------------|-----|-----|-----|
| PK 65 | 364 | 138 | 170 |
| PKA 65 | 310 | 134 | 172 |

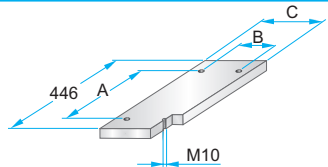

PK 65 - 346 x 446 x h / **material**
PKA 65 - 346 x 446 x h / **material**

| | | |
|---|----|------|
| h | 17 | 1730 |
| h | | 2085 |

**PK 07
PKA 07**

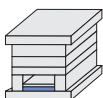

| | A | B | C | D | M |
|---------------|-----|-----|-----|-----|----|
| PK 07 | 364 | 186 | 218 | 414 | M4 |
| PKA 07 | 310 | 180 | 218 | 408 | M5 |

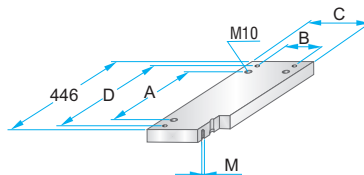

PK 07 - 346 x 446 x h / **material**
PKA 07 - 346 x 446 x h / **material**

| | | |
|---|----|------|
| h | 22 | 1730 |
| h | | 2312 |
| h | | 2085 |

**PK 75
PKA 75**

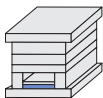

| | A | B | C | D | M |
|---------------|-----|-----|-----|-----|----|
| PK 75 | 364 | 138 | 170 | 414 | M4 |
| PKA 75 | 310 | 134 | 172 | 408 | M5 |

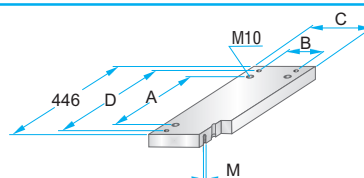

PK 75 - 346 x 446 x h / **material**
PKA 75 - 346 x 446 x h / **material**

| | | |
|---|----|------|
| h | 22 | 1730 |
| h | | 2312 |
| h | | 2085 |