

**Korpus formy**

Mold base

**346x546**

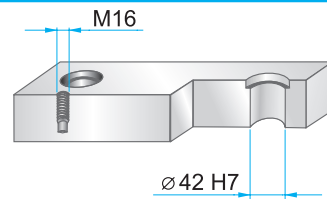
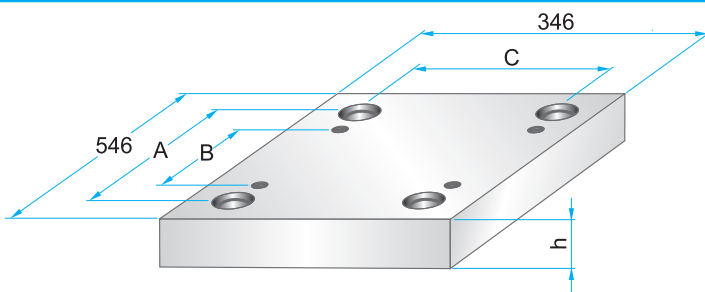

**Wymiary i tolerancje**  
Dimensions and tolerances



	A	B	C
<b>PK</b>	474	380	274
<b>PKA</b>	474	380	274

**PK 01  
PKA 01**

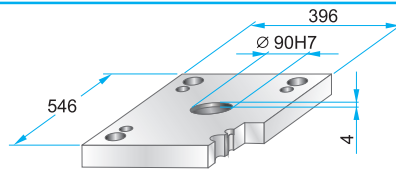
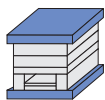

**PK 01** – 346 x 546 x h / material  
**PKA 01** – 346 x 546 x h / material

27	1730
36	2312
46	2085

**PK 11  
PKA 11**

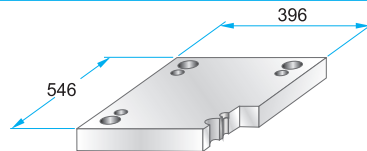

**PK 11** – 346 x 546 x h / material  
**PKA 11** – 346 x 546 x h / material

27	1730
36	2312
46	2085

**PK 02  
PKA 02**



**PK 12  
PKA 12**



**PK 21  
PKA 21**

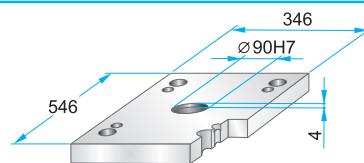
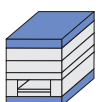

**PK 21** – 346 x 546 x h / material  
**PKA 21** – 346 x 546 x h / material

27	1730
36	2312
	2085

**PK 22  
PKA 22**

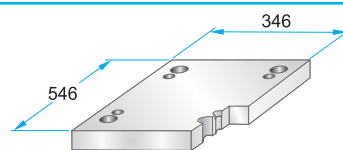

**PK 22** – 346 x 546 x h / material  
**PKA 22** – 346 x 546 x h / material

27	1730
36	2312
	2085

**PK 03  
PKA 03**

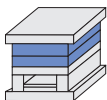

Podcięcia do demontażu  
na życzenie.  
Corner undercuts upon request.

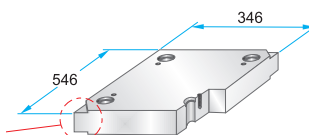

**PK 03** – 346 x 546 x h / material  
**PKA 03** – 346 x 546 x h / material

**PK 35** – 346 x 546 x h / material  
**PKA 35** – 346 x 546 x h / (a1/b1/h1)

**PK 35  
PKA 35**

Podcięcia do demontażu  
na życzenie.  
Corner undercuts upon request.

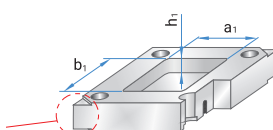

Material info



22	1730
27	2083
36	2085
46	2162
56	2311
66	2312
76	2738
86	Toolox33
96	Toolox44
116	2738HH
136	2714HH
156	
176	

**Korpus formy**

Mold base

**346x546**

**PK 31  
PKA 31**

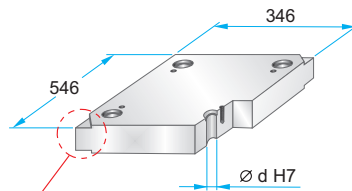

Podcięcia do demontażu na życzenie.  
Corner undercuts upon request.



	d
<b>PK 31</b>	41,3
<b>PKA 31</b>	41,4

Material info



PK 31 - 346 x 546 x	h /	material
PKA 31 - 346 x 546 x	h /	
	27	1730
	36	2083
	46	2085
	56	2162
	66	2311
	76	2312
	86	2343
	96	2738
	116	2767
	136	Toolox33
	156	Toolox44
		2738HH
		2714HH

**PK 04  
PKA 04**

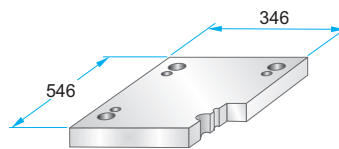

PK 04 - 346 x 546 x	h /	material
PKA 04 - 346 x 546 x	h /	
	36	1730
	46	2312
	56	2085
	66	

**PK 05  
PKA 05**

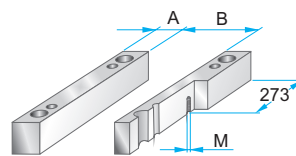
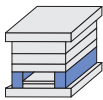

	A	B	M
<b>PK 05</b>	62	222	-
<b>PKA 05</b>	62	222	M10

PK 05 - 346 x 546 x	h /	material
PKA 05 - 346 x 546 x	h /	
	56	1730
	66	2085
	76	
	86	
	96	
	116	
	136	
	156	

**PK 55  
PKA 55**

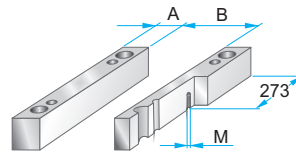
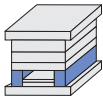

	A	B	M
<b>PK 55</b>	86	174	-
<b>PKA 55</b>	86	174	M10

PK 55 - 346 x 546 x	h /	material
PKA 55 - 346 x 546 x	h /	
	56	1730
	66	2085
	76	
	86	
	96	
	116	
	136	
	156	

**PK 06  
PKA 06**

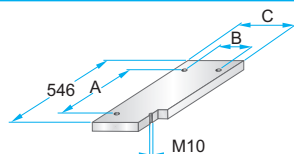
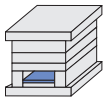

	A	B	C
<b>PK 06</b>	470	190	218
<b>PKA 06</b>	410	180	218

PK 06 - 346 x 546 x	h /	material
PKA 06 - 346 x 546 x	h /	
	22	1730
		2085

**PK 65  
PKA 65**

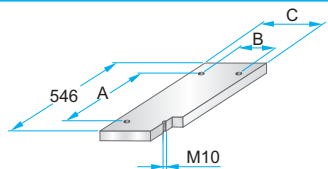
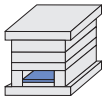

	A	B	C
<b>PK 65</b>	470	142	170
<b>PKA 65</b>	410	134	172

PK 65 - 346 x 546 x	h /	material
PKA 65 - 346 x 546 x	h /	
	22	1730
		2085

**PK 07  
PKA 07**

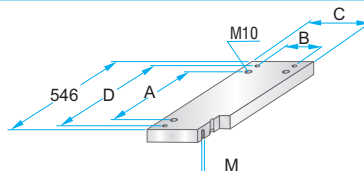
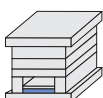

	A	B	C	D	M
<b>PK 07</b>	470	190	218	516	M4
<b>PKA 07</b>	410	180	218	508	M5

PK 07 - 346 x 546 x	h /	material
PKA 07 - 346 x 546 x	h /	
	27	1730
		2312
		2085

**PK 75  
PKA 75**

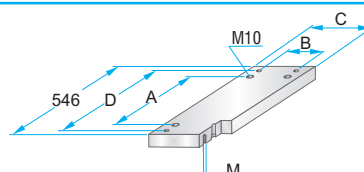
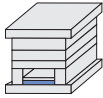

	A	B	C	D	M
<b>PK 75</b>	470	142	170	516	M4
<b>PKA 75</b>	410	134	172	508	M5

PK 75 - 346 x 546 x	h /	material
PKA 75 - 346 x 546 x	h /	
	27	1730
		2312
		2085