

Korpus formy

Mold base

346x596

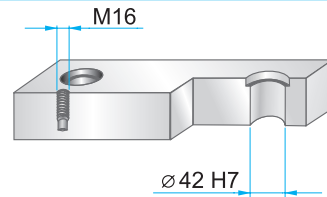
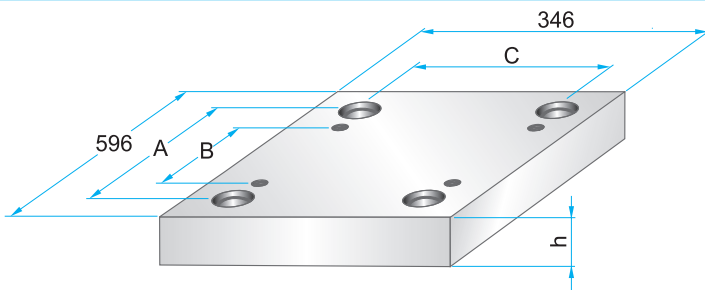

Wymiary i tolerancje
Dimensions and tolerances



	A	B	C
PK	524	430	274
PKA	524	430	274

**PK 01
PKA 01**

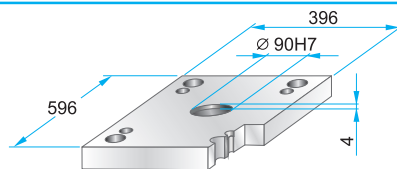
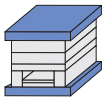

PK 01 – 346 x 596 x h / material
PKA 01 – 346 x 596 x h / material

27	1730
36	2312
46	2085

**PK 11
PKA 11**

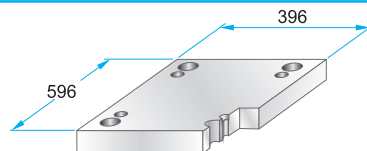
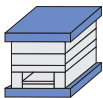

PK 11 – 346 x 596 x h / material
PKA 11 – 346 x 596 x h / material

27	1730
36	2312
46	2085

**PK 02
PKA 02**

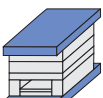

**PK 12
PKA 12**

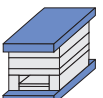

**PK 21
PKA 21**

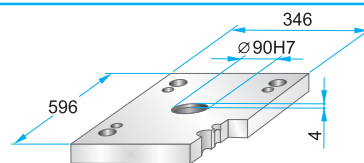
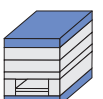

PK 21 – 346 x 596 x h / material
PKA 21 – 346 x 596 x h / material

27	1730
36	2312
46	2085

**PK 22
PKA 22**

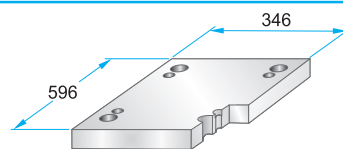

PK 22 – 346 x 596 x h / material
PKA 22 – 346 x 596 x h / material

27	1730
36	2312
46	2085

**PK 03
PKA 03**

Podcięcia do demontażu
na życzenie.
Corner undercuts upon request.

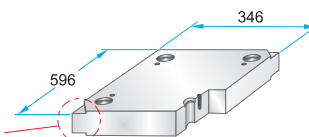

PK 03 – 346 x 596 x h / material
PKA 03 – 346 x 596 x h / material

PK 35 – 346 x 596 x h / material
PKA 35 – 346 x 596 x h / (a1/b1/h1)

22	1730
27	2083
36	2085
46	2162
56	2311
66	2312
76	2738
86	Toolox33
96	Toolox44
116	2738HH
136	2714HH
156	
176	

**PK 35
PKA 35**

Podcięcia do demontażu
na życzenie.
Corner undercuts upon request.

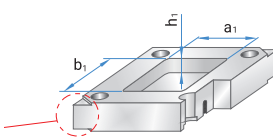

Material info



Korpus formy

Mold base

346x596

**PK 31
PKA 31**

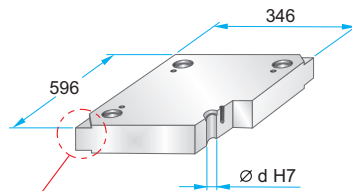
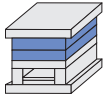

Podcięcia do demontażu na życzenie.
Corner undercuts upon request.



	d
PK 31	41,3
PKA 31	41,4

Material info



PK 31 - 346 x 596 x h	h	material
PKA 31 - 346 x 596 x h	h	
	27	1730
	36	2083
	46	2085
	56	2162
	66	2311
	76	2312
	86	2343
	96	2738
	116	2767
	136	Toolox33
	156	Toolox44
		2738HH
		2714HH

**PK 04
PKA 04**

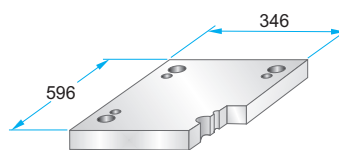
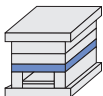

PK 04 - 346 x 596 x h	h	material
PKA 04 - 346 x 596 x h	h	
	36	1730
	46	2312
	56	2085
	66	

**PK 05
PKA 05**

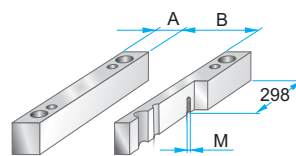
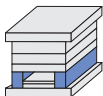

	A	B	M
PK 05	62	222	-
PKA 05	62	222	M10

PK 05 - 346 x 596 x h	h	material
PKA 05 - 346 x 596 x h	h	
	56	1730
	66	2085
	76	
	86	
	96	
	116	
	136	
	156	

**PK 55
PKA 55**

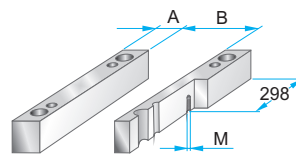
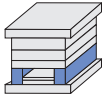

	A	B	M
PK 55	86	174	-
PKA 55	86	174	M10

PK 55 - 346 x 596 x h	h	material
PKA 55 - 346 x 596 x h	h	
	56	1730
	66	2085
	76	
	86	
	96	
	116	
	136	
	156	

**PK 06
PKA 06**

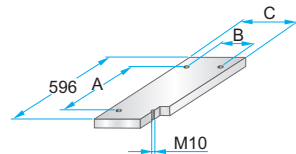
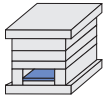

	A	B	C
PK 06	520	190	218
PKA 06	460	180	218

PK 06 - 346 x 596 x h	h	material
PKA 06 - 346 x 596 x h	h	
	22	1730
		2085

**PK 65
PKA 65**

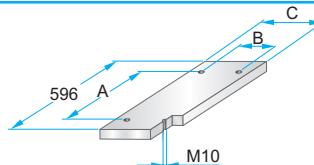
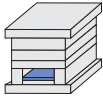

	A	B	C
PK 65	520	142	170
PKA 65	460	134	172

PK 65 - 346 x 596 x h	h	material
PKA 65 - 346 x 596 x h	h	
	22	1730
		2085

**PK 07
PKA 07**

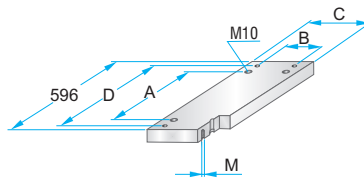
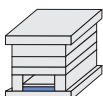

	A	B	C	D	M
PK 07	520	190	218	566	M4
PKA 07	460	180	218	558	M5

PK 07 - 346 x 596 x h	h	material
PKA 07 - 346 x 596 x h	h	
	27	1730
		2312
		2085

**PK 75
PKA 75**

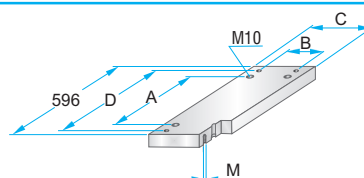
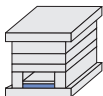

	A	B	C	D	M
PK 75	520	142	170	566	M4
PKA 75	460	134	172	558	M5

PK 75 - 346 x 596 x h	h	material
PKA 75 - 346 x 596 x h	h	
	27	1730
		2312
		2085