

Korpus formy

Mold base

346x696

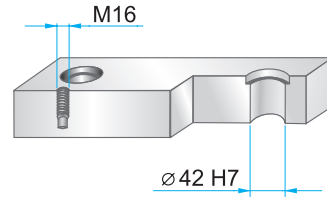
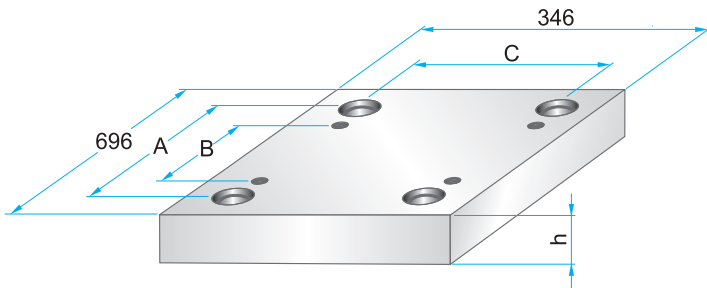

Wymiary i tolerancje
Dimensions and tolerances



	A	B	C
PK	624	530	274
PKA	624	530	274

**PK 01
PKA 01**



	W
PK 01	446
PKA 01	396

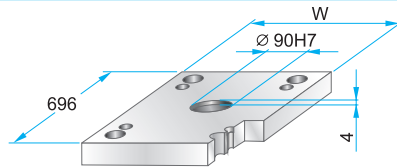

PK 01 - 346 x 646 x h / material
PKA 01 - 346 x 646 x h / material

36	1730
46	2312
	2085

**PK 11
PKA 11**

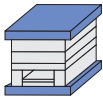

	W
PK 11	446
PKA 11	396

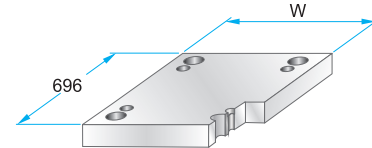

PK 11 - 346 x 646 x h / material
PKA 11 - 346 x 646 x h / material

36	1730
46	2312
	2085

**PK 02
PKA 02**

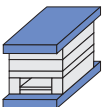

**PK 12
PKA 12**

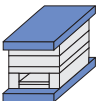

**PK 21
PKA 21**

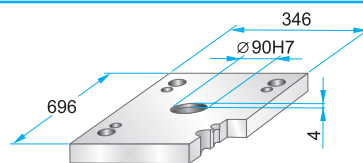
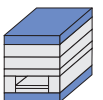

PK 21 - 346 x 646 x h / material
PKA 21 - 346 x 646 x h / material

27	1730
36	2312
46	2085

**PK 22
PKA 22**

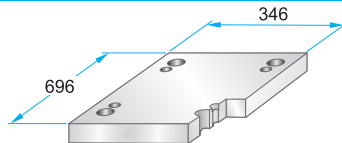

PK 22 - 346 x 646 x h / material
PKA 22 - 346 x 646 x h / material

27	1730
36	2312
46	2085

**PK 03
PKA 03**

Podcięcia do demontażu
na życzenie.
Corner undercuts upon request.

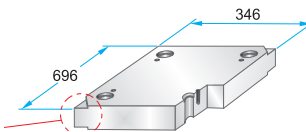

PK 03 - 346 x 646 x h / material
PKA 03 - 346 x 646 x h / material

PK 35 - 346 x 646 x h / material
PKA 35 - 346 x 646 x h / (a1/b1/h1)

22	1730
27	2083
36	2085
46	2162
56	2311
66	2312
76	2738
86	Toolox33
96	Toolox44
116	2738HH
136	2714HH
156	
176	

**PK 35
PKA 35**

Podcięcia do demontażu
na życzenie.
Corner undercuts upon request.

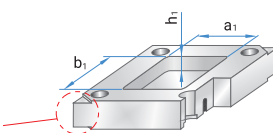

Material info



Korpus formy

Mold base

346x696

PK 31

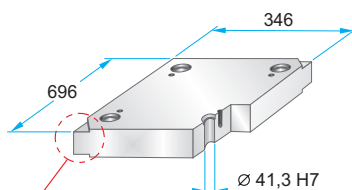
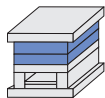

Podcięcia do demontażu na życzenie.
Corner undercuts upon request.



Material info



PK 31 - 346 x 696 x h / material

h	material
27	1730
36	2083
46	2085
56	2162
66	2311
76	2312
86	2343
96	2738
116	2767
136	Toolox33
156	Toolox44
	2738HH
	2714HH

**PK 04
PKA 04**

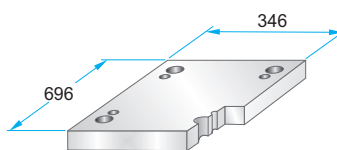
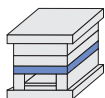

**PK 04 - 346 x 696 x h / material
PKA 04 - 346 x 696 x h / material**

h	material
36	1730
46	2312
56	2085
66	
76	

**PK 05
PKA 05**

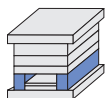

	A	B	M
PK 05	62	222	-
PKA 05	62	222	M10

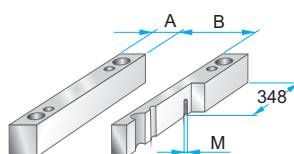

**PK 05 - 346 x 696 x h / material
PKA 05 - 346 x 696 x h / material**

h	material
56	1730
66	2085
76	
86	
96	
116	
136	
156	

**PK 55
PKA 55**

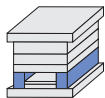

	A	B	M
PK 55	86	174	-
PKA 55	86	174	M10

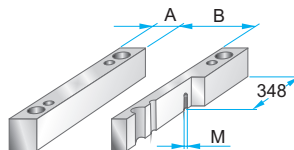

**PK 55 - 346 x 696 x h / material
PKA 55 - 346 x 696 x h / material**

h	material
56	1730
66	2085
76	
86	
96	
116	
136	
156	

**PK 06
PKA 06**

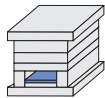

	A	B	C
PK 06	620	190	218
PKA 06	560	180	218

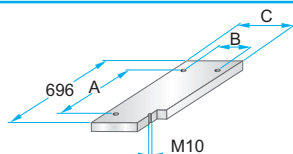

**PK 06 - 346 x 696 x h / material
PKA 06 - 346 x 696 x h / material**

h	material
22	1730
27	2085

**PK 65
PKA 65**

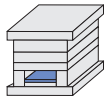

	A	B	C
PK 65	620	142	170
PKA 65	560	134	172

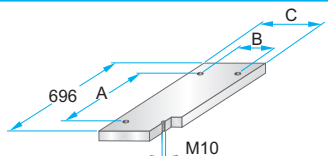

**PK 65 - 346 x 696 x h / material
PKA 65 - 346 x 696 x h / material**

h	material
22	1730
	2085

**PK 07
PKA 07**

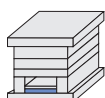

	A	B	C	D	M
PK 07	620	190	218	666	M4
PKA 07	560	180	218	658	M5

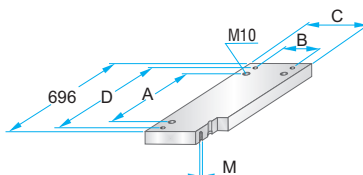

**PK 07 - 346 x 696 x h / material
PKA 07 - 346 x 696 x h / material**

h	material
27	1730
36	2312
	2085

**PK 75
PKA 75**

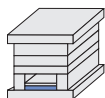

	A	B	C	D	M
PK 75	620	142	170	666	M4
PKA 75	560	134	172	658	M5

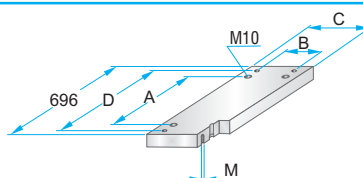

**PK 75 - 346 x 696 x h / material
PKA 75 - 346 x 696 x h / material**

h	material
27	1730
	2312
	2085