

**Korpus formy**

Mold base

**346x796**

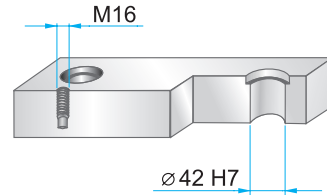
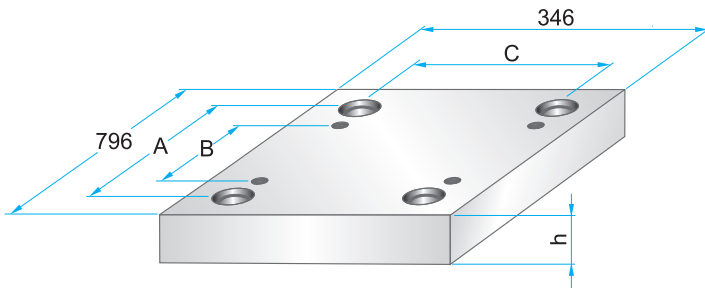

Wymiary i tolerancje  
Dimensions and tolerances



	A	B	C
<b>PK</b>	724	630	274
<b>PKA</b>	724	630	274

**PKA 01**

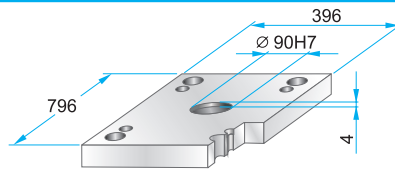
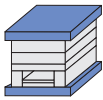

**PKA 01 – 346 x 796 x h / material**

36	1730
46	2312
	2085

**PK 11  
PKA 11**



	W
<b>PK 11</b>	446
<b>PKA 11</b>	396

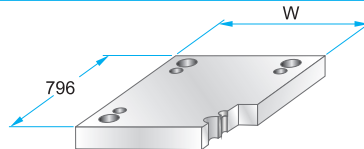

**PK 11 – 346 x 796 x h / material  
PKA 11 – 346 x 796 x h / material**

36	1730
46	2312
56	2085

**PK 02  
PKA 02**

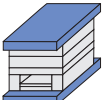

**PK 12  
PKA 12**



**PKA 21**

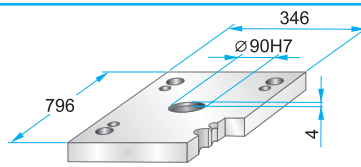

**PKA 21 – 346 x 796 x h / material**

46	1730
	2312
	2085

**PK 22  
PKA 22**

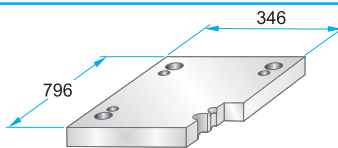

**PK 22 – 346 x 796 x h / material  
PKA 22 – 346 x 796 x h / material**

36	1730
46	2312
	2085

**PK 03  
PKA 03**

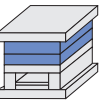

Podcięcia do demontażu  
na życzenie.  
Corner undercuts upon request.

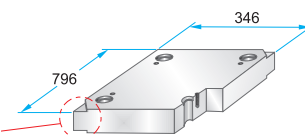

**PK 03 – 346 x 796 x h / material  
PKA 03 – 346 x 796 x h / material**

**PK 35 – 346 x 796 x h / material  
PKA 35 – 346 x 796 x h / (a1/b1/h1)**

22	1730
27	2083
36	2085
46	2162
56	2311
66	2312
76	2738
86	Toolox33
96	Toolox44
116	2738HH
136	2714HH
156	
176	

**PK 35  
PKA 35**

Podcięcia do demontażu  
na życzenie.  
Corner undercuts upon request.

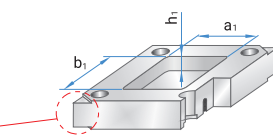

Material info



**Korpus formy**

Mold base

**346x796**

**PK 31**

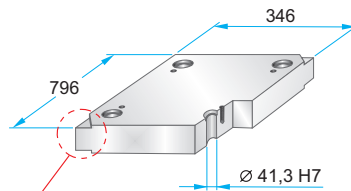
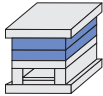

Podcięcia do demontażu na życzenie.  
Corner undercuts upon request.



**PK 31 - 346 x 796 x h / material**

27	1730
36	2083
46	2085
56	2162
66	2311
76	2312
86	2343
96	2738
116	2767
136	Toolox33
156	Toolox44
	2738HH
	2714HH

Material info



**PK 04  
PKA 04**

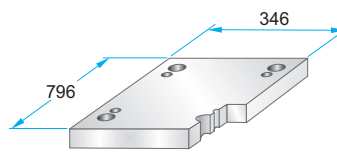
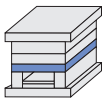

**PK 04 - 346 x 796 x h / material  
PKA 04 - 346 x 796 x h / material**

36	1730
46	2312
56	2085
66	
76	

**PK 05  
PKA 05**

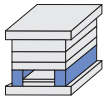

	A	B	M
<b>PK 05</b>	62	222	-
<b>PKA 05</b>	62	222	M10

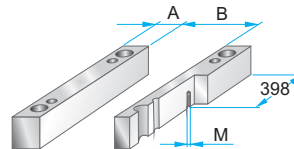

**PK 05 - 346 x 796 x h / material  
PKA 05 - 346 x 796 x h / material**

56	1730
66	2085
76	
86	
96	
116	
136	
156	

**PK 55**

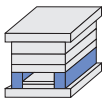

	A	B
<b>PK 55</b>	86	174

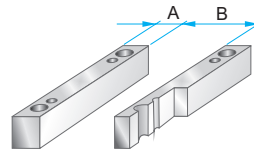

**PK 55 - 346 x 796 x h / material**

86	1730
96	2085
116	
136	
156	

**PK 06  
PKA 06**

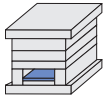

	A	B	C
<b>PK 06</b>	714	186	218
<b>PKA 06</b>	660	180	218

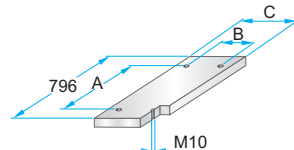

**PK 06 - 346 x 796 x h / material  
PKA 06 - 346 x 796 x h / material**

22	1730
27	2085

**PK 65**

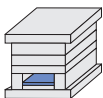

	A	B	C
<b>PK 65</b>	714	138	170

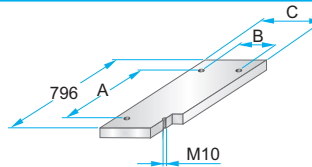

**PK 65 - 346 x 796 x h / material**

22	1730
	2085

**PK 07  
PKA 07**

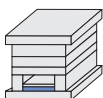

	A	B	C	D	M
<b>PK 07</b>	714	186	218	-	-
<b>PKA 07</b>	660	180	218	758	M5

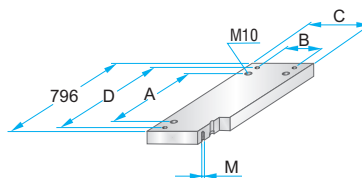

**PK 07 - 346 x 796 x h / material  
PKA 07 - 346 x 796 x h / material**

27	1730
36	2312
	2085

**PK 75**

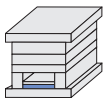

	A	B	C
<b>PK 75</b>	714	138	170

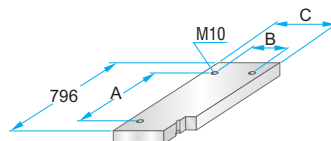

**PK 75 - 346 x 796 x h / material**

27	1730
	2312
	2085