

Korpus formy

Mold base

396x696

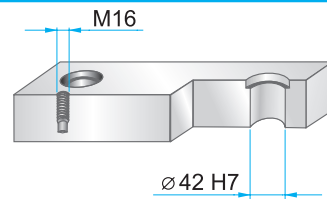
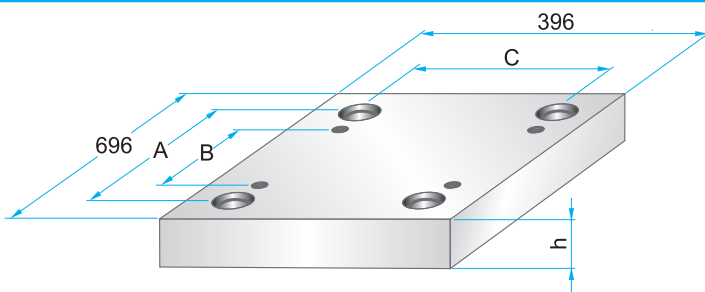

Wymiary i tolerancje
Dimensions and tolerances



	A	B	C
PK	624	530	324
PKA	624	530	324

**PK 01
PKA 01**

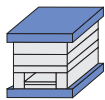

	W
PK 01	496
PKA 01	446

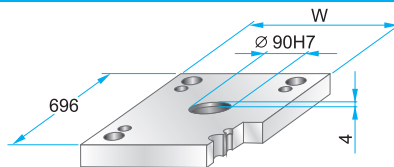

PK 01 - 396 x 696 x h / material
PKA 01 - 396 x 696 x h /

36	1730
46	2312
56	2085

**PK 11
PKA 11**

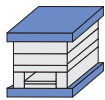

	W
PK 11	496
PKA 11	446

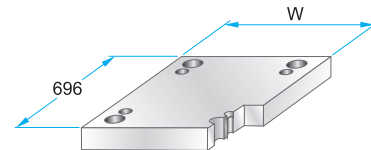

PK 11 - 396 x 696 x h / material
PKA 11 - 396 x 696 x h /

36	1730
46	2312
56	2085

**PK 02
PKA 02**

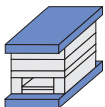

**PK 12
PKA 12**



**PK 21
PKA 21**

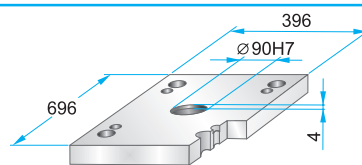
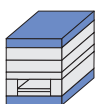

PK 21 - 396 x 696 x h / material
PKA 21 - 396 x 696 x h /

36	1730
46	2312
	2085

**PK 22
PKA 22**

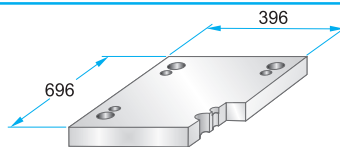

PK 22 - 396 x 696 x h / material
PKA 22 - 396 x 696 x h /

36	1730
46	2312
	2085

**PK 03
PKA 03**

Podcięcia do demontażu
na życzenie.
Corner undercuts upon request.

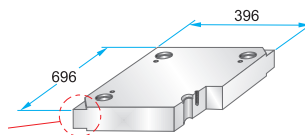

PK 03 - 396 x 696 x h / material
PKA 03 - 396 x 696 x h /

PK 35 - 396 x 696 x h / material
PKA 35 - 396 x 696 x h / (a1/b1/h1)

22	1730
27	2083
36	2085
46	2162
56	2311
66	2312
76	2738
86	Toolox33
96	Toolox44
116	2738HH
136	2714HH
156	
176	

**PK 35
PKA 35**

Podcięcia do demontażu
na życzenie.
Corner undercuts upon request.

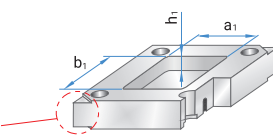

Material info



Korpus formy

Mold base

396x696

PK 31

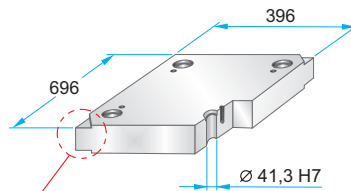
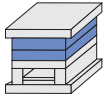

PK 31 - 396 x 696 x h / material

h	material
36	1730
46	2083
56	2085
66	2162
76	2311
86	2312
96	2343
116	2738
136	2767
156	Toolox33
176	Toolox44
	2738HH
	2714HH

Podcięcia do demontażu na życzenie.
Corner undercuts upon request.



Material info



**PK 04
PKA 04**

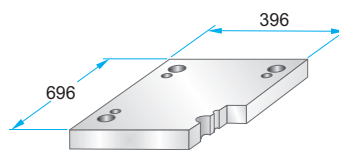
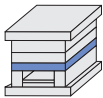

**PK 04 - 396 x 696 x h / material
PKA 04 - 396 x 696 x h / material**

h	material
36	1730
46	2312
56	2085

**PK 05
PKA 05**

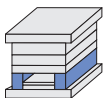

	A	B	M
PK 05	62	272	-
PKA 05	62	272	M10

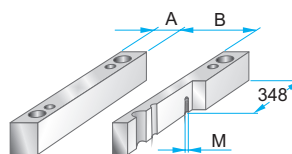

**PK 05 - 396 x 696 x h / material
PKA 05 - 396 x 696 x h / material**

h	material
76	1730
86	2085
96	
116	
136	
156	

**PK 55
PKA 55**

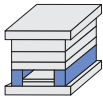

	A	B	M
PK 55	86	224	-
PKA 55	86	224	M10

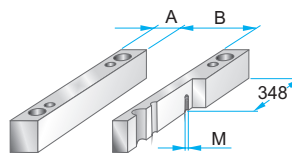

**PK 55 - 396 x 696 x h / material
PKA 55 - 396 x 696 x h / material**

h	material
76	1730
86	2085
96	
116	
136	
156	

**PK 06
PKA 06**

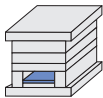

	A	B	C
PK 06	614	240	268
PKA 06	560	230	268

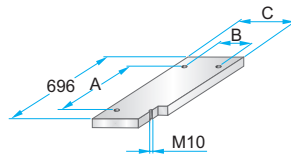

**PK 06 - 396 x 696 x h / material
PKA 06 - 396 x 696 x h / material**

h	material
27	1730
	2085

**PK 65
PKA 65**

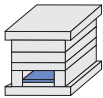

	A	B	C
PK 65	614	192	220
PKA 65	560	180	218

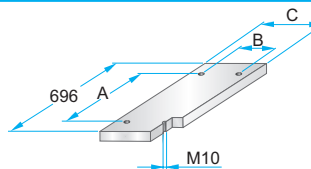

**PK 65 - 396 x 696 x h / material
PKA 65 - 396 x 696 x h / material**

h	material
27	1730
	2085

**PK 07
PKA 07**

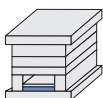

	A	B	C	D	M
PK 07	614	240	268	660	M4
PKA 07	560	230	268	658	M5

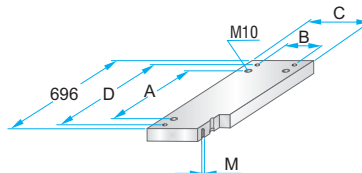

**PK 07 - 396 x 696 x h / material
PKA 07 - 396 x 696 x h / material**

h	material
36	1730
	2312
	2085

**PK 75
PKA 75**

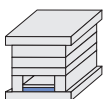

	A	B	C	D	M
PK 75	614	192	220	660	M4
PKA 75	560	180	218	658	M5

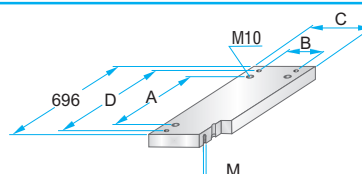

**PK 75 - 396 x 696 x h / material
PKA 75 - 396 x 696 x h / material**

h	material
36	1730
	2312
	2085