

Korpus formy

Mold base

396x896

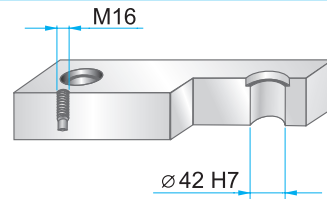
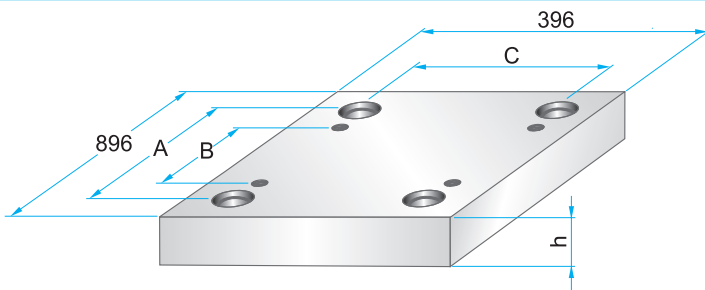

Wymiary i tolerancje
Dimensions and tolerances



	A	B	C
PK	824	730	324

PK 01



PK 11

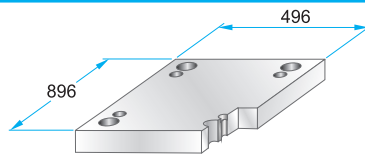

PK 11 – 396 x 896 x h / material

46	1730
56	2312
	2085

PK 02

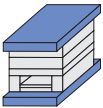

PK 12

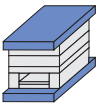

PK 21



PK 22

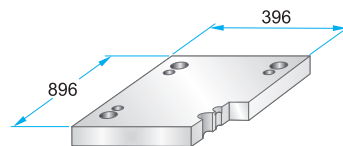

PK 22 – 396 x 896 x h / material

36	1730
46	2312
	2085

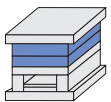

**PK 03
PKA 03**

Podcięcia do demontażu
na życzenie.
Corner undercuts upon request.

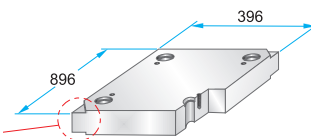

PK 03 – 396 x 896 x h / material

PK 35 – 396 x 896 x h / material
(a1/b1/h1)

36	1730
46	2083
56	2085
66	2162
76	2311
86	2312
96	2738
116	Toolox33
136	Toolox44
156	2738HH
176	2714HH

**PK 35
PKA 35**

Podcięcia do demontażu
na życzenie.
Corner undercuts upon request.

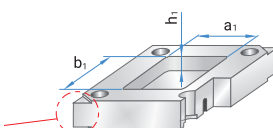

Material info



Korpus formy

Mold base

396x896

PK 31

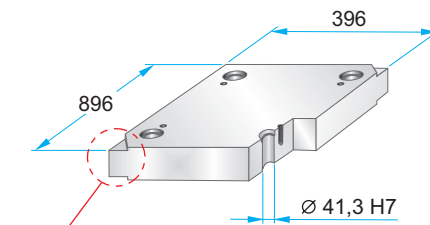
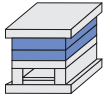

Podcięcia do demontażu na życzenie.
Corner undercuts upon request.



PK 31 - 396 x 896 x h / material

h	material
36	1730
46	2083
56	2085
66	2162
76	2311
86	2312
96	2343
116	2738
136	2767
156	Toolox33
176	Toolox44
	2738HH
	2714HH

Material info



PK 04

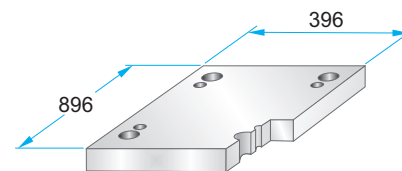
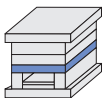

PK 04 - 396 x 896 x h / material

h	material
46	1730
56	2312
	2085

PK 05

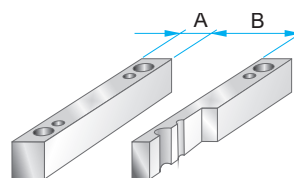
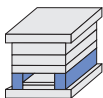

	A	B
PK 05	62	272

PK 05 - 396 x 896 x h / material

h	material
86	1730
96	2085
116	
136	
156	

PK 55

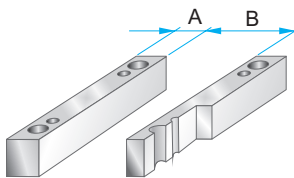
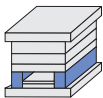

	A	B
PK 55	86	224

PK 55 - 396 x 896 x h / material

h	material
86	1730
96	2085
116	
136	
156	

PK 06

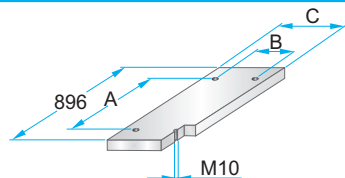
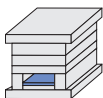

	A	B	C
PK 06	814	236	268

PK 06 - 396 x 896 x h / material

h	material
27	1730
	2085

PK 65

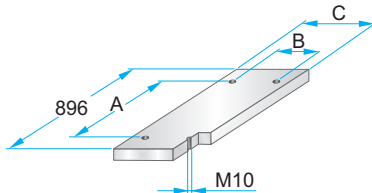
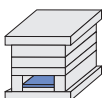

	A	B	C
PK 65	814	188	220

PK 65 - 396 x 896 x h / material

h	material
27	1730
	2085

PK 07

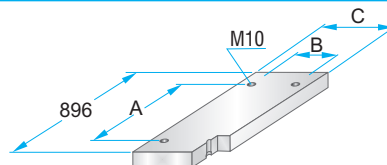
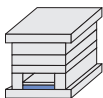

	A	B	C
PK 07	814	236	268

PK 07 - 396 x 896 x h / material

h	material
36	1730
	2312
	2085

PK 75

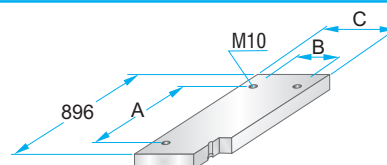
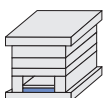

	A	B	C
PK 75	814	188	220

PK 75 - 396 x 896 x h / material

h	material
36	1730
	2312
	2085