

Korpus formy

Mold base

446x446

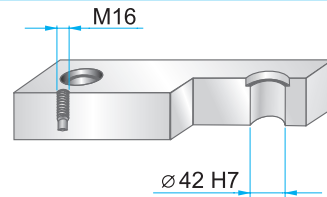
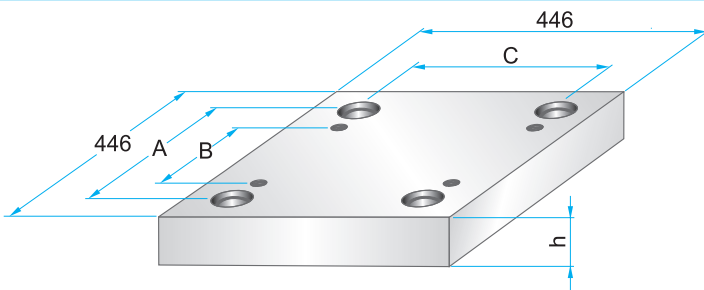

Wymiary i tolerancje
Dimensions and tolerances



	A	B	C
PK	374	280	374
PKA	374	280	374

**PK 01
PKA 01**



	W
PK 01	546
PKA 01	496

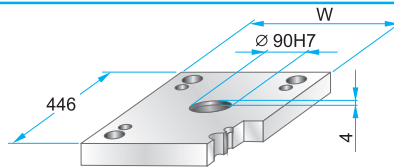

PK 01 - 446 x 446 x h / material
PKA 01 - 446 x 446 x h / material

36	1730
46	2312
	2085

**PK 11
PKA 11**

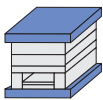

	W
PK 11	546
PKA 11	496

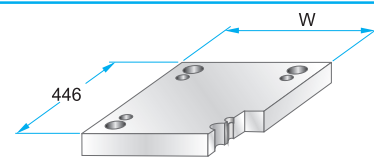

PK 11 - 446 x 446 x h / material
PKA 11 - 446 x 446 x h / material

36	1730
46	2312
	2085

**PK 02
PKA 02**

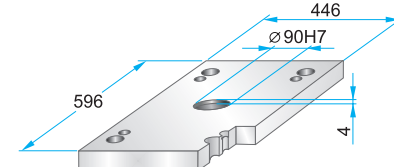

PK 02 - 446 x 446 x h / material
PKA 02 - 446 x 446 x h / material

36	1730
46	2312
	2085

**PK 12
PKA 12**

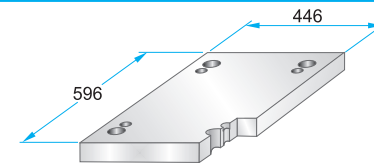
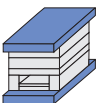

PK 12 - 446 x 446 x h / material
PKA 12 - 446 x 446 x h / material

36	1730
46	2312
	2085

**PK 21
PKA 21**

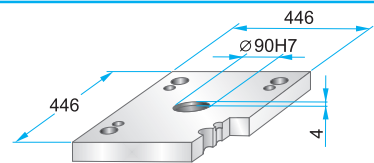
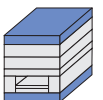

PK 21 - 446 x 446 x h / material
PKA 21 - 446 x 446 x h / material

27	1730
36	2312
46	2085

**PK 22
PKA 22**

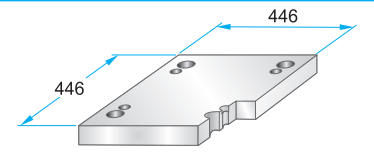

PK 22 - 446 x 446 x h / material
PKA 22 - 446 x 446 x h / material

27	1730
36	2312
46	2085

**PK 03
PKA 03**

Podcięcia do demontażu
na życzenie.
Corner undercuts upon request.

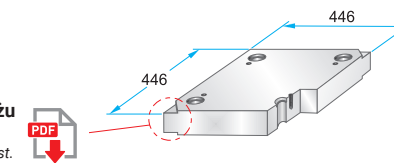

PK 03 - 446 x 446 x h / material
PKA 03 - 446 x 446 x h / material

PK 35 - 446 x 446 x h / material
PKA 35 - 446 x 446 x h / (a1/b1/h1)

27	1730
36	2083
46	2085
56	2162
66	2311
76	2312
86	2738
96	Toolox33
116	Toolox44
136	2738HH
156	2714HH
176	

**PK 35
PKA 35**

Podcięcia do demontażu
na życzenie.
Corner undercuts upon request.

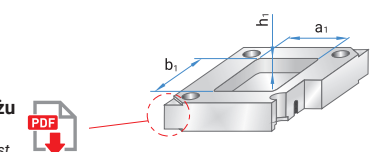

Material info



Korpus formy

Mold base

446x446

**PK 31
PKA 31**

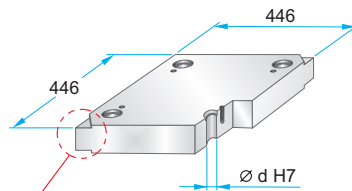
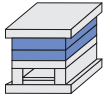

Podcięcia do demontażu na życzenie.
Corner undercuts upon request.



	d
PK 31	41,3
PKA 31	41,4

Material info



PK 31 – 446 x 446 x h / material
PKA 31 – 446 x 446 x h / material

22	1730
27	2083
36	2085
46	2162
56	2311
66	2312
76	2343
86	2738
96	2767
116	Toolox33
136	Toolox44
156	2738HH
176	2714HH

**PK 04
PKA 04**

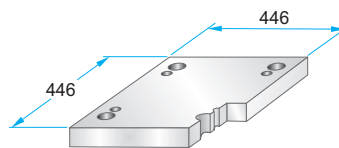
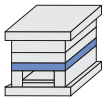

PK 04 – 446 x 446 x h / material
PKA 04 – 446 x 446 x h / material

36	1730
46	2312
56	2085
66	
76	
86	

**PK 05
PKA 05**

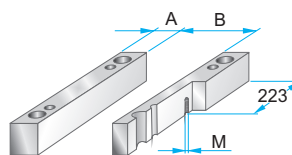
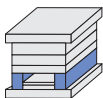

	A	B	M
PK 05	62	322	-
PKA 05	62	322	M10

PK 05 – 446 x 446 x h / material
PKA 05 – 446 x 446 x h / material

56	1730
66	2085
76	
86	
96	
116	
136	
156	

**PK 55
PKA 55**

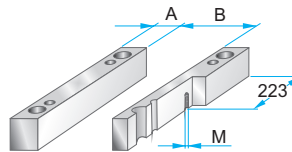
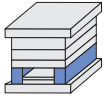

	A	B	M
PK 55	86	274	-
PKA 55	86	274	M10

PK 55 – 446 x 446 x h / material
PKA 55 – 446 x 446 x h / material

56	1730
66	2085
76	
86	
96	
116	
136	
156	

**PK 06
PKA 06**

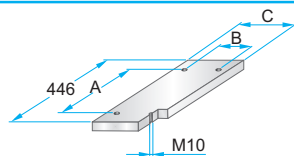
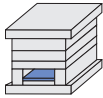

	A	B	C
PK 06	364	286	318
PKA 06	310	280	318

PK 06 – 446 x 446 x h / material
PKA 06 – 446 x 446 x h / material

17	1730
22	2085

**PK 65
PKA 65**

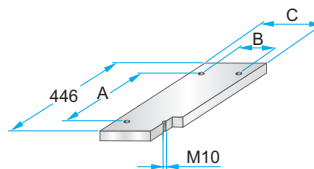
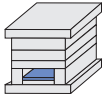

	A	B	C
PK 65	364	238	270
PKA 65	310	230	268

PK 65 – 446 x 446 x h / material
PKA 65 – 446 x 446 x h / material

17	1730
22	2085

**PK 07
PKA 07**

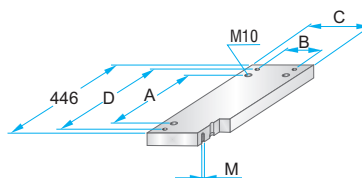
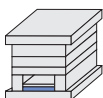

	A	B	C	D	M
PK 07	364	286	318	414	M4
PKA 07	310	280	318	408	M5

PK 07 – 446 x 446 x h / material
PKA 07 – 446 x 446 x h / material

27	1730
	2312
	2085

**PK 75
PKA 75**

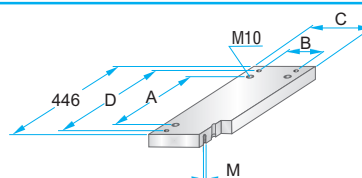
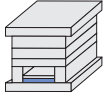

	A	B	C	D	M
PK 75	364	238	270	414	M4
PKA 75	310	230	268	408	M5

PK 75 – 446 x 446 x h / material
PKA 75 – 446 x 446 x h / material

27	1730
	2312
	2085