

**Korpus formy**

Mold base

**446x496**

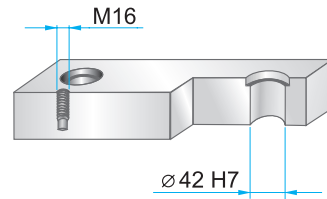
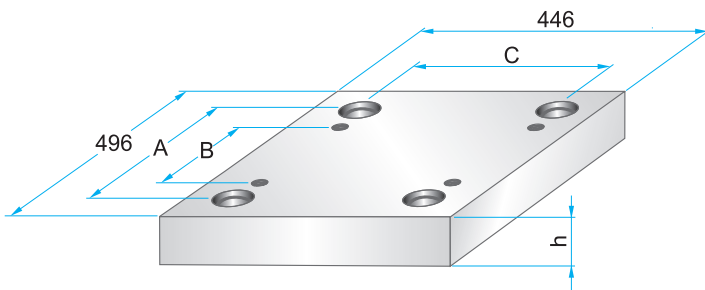

Wymiary i tolerancje  
Dimensions and tolerances



	A	B	C
<b>PK</b>	424	330	374
<b>PKA</b>	424	330	374

**PK 01  
PKA 01**

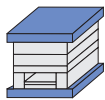

	W
<b>PK 01</b>	546
<b>PKA 01</b>	496

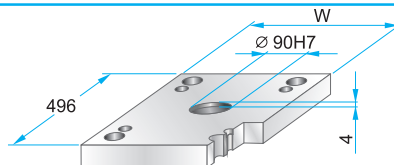

**PK 01** – 446 x 496 x h / material  
**PKA 01** – 446 x 496 x h / material

36	1730
46	2312
	2085

**PK 11  
PKA 11**

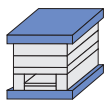

	W
<b>PK 11</b>	546
<b>PKA 11</b>	496

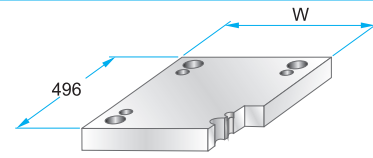

**PK 11** – 446 x 496 x h / material  
**PKA 11** – 446 x 496 x h / material

36	1730
46	2312
	2085

**PK 02  
PKA 02**

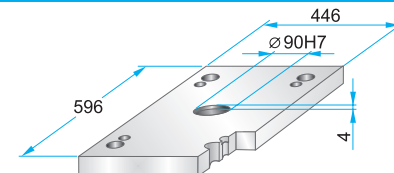

**PK 02** – 446 x 496 x h / material  
**PKA 02** – 446 x 496 x h / material

36	1730
46	2312
	2085

**PK 12  
PKA 12**

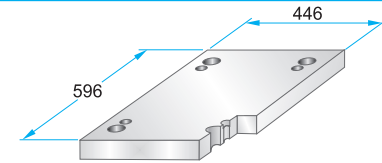

**PK 12** – 446 x 496 x h / material  
**PKA 12** – 446 x 496 x h / material

36	1730
46	2312
	2085

**PK 21  
PKA 21**

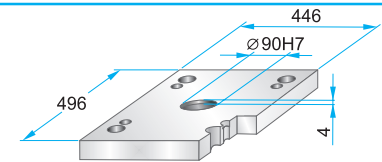
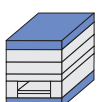

**PK 21** – 446 x 496 x h / material  
**PKA 21** – 446 x 496 x h / material

27	1730
36	2312
46	2085

**PK 22  
PKA 22**

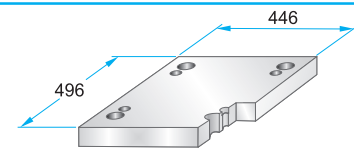

**PK 22** – 446 x 496 x h / material  
**PKA 22** – 446 x 496 x h / material

27	1730
36	2312
46	2085

**PK 03  
PKA 03**

Podcięcia do demontażu  
na życzenie.  
Corner undercuts upon request.

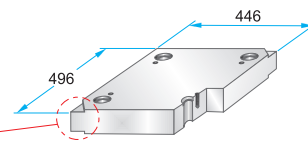

**PK 03** – 446 x 496 x h / material  
**PKA 03** – 446 x 496 x h / material

**PK 35** – 446 x 496 x h / material  
**PKA 35** – 446 x 496 x h / (a1/b1/h1)

27	1730
36	2083
46	2085
56	2162
66	2311
76	2312
86	2738
96	Toolox33
116	Toolox44
136	2738HH
156	2714HH
176	

**PK 35  
PKA 35**

Podcięcia do demontażu  
na życzenie.  
Corner undercuts upon request.

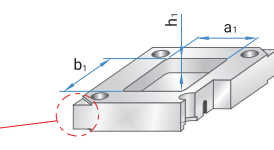

Material info



**Korpus formy**

Mold base

**446x496**

**PK 31  
PKA 31**

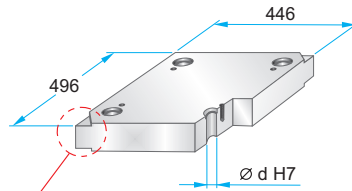
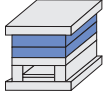

Podcięcia do demontażu na życzenie.  
Corner undercuts upon request.



	d
<b>PK 31</b>	41,3
<b>PKA 31</b>	41,4

Material info



PK 31 - 446 x 496 x	h /	material
PKA 31 - 446 x 496 x	h /	
	22	1730
	27	2083
	36	2085
	46	2162
	56	2311
	66	2312
	76	2343
	86	2738
	96	2767
	116	Toolox33
	136	Toolox44
	156	2738HH
	176	2714HH

**PK 04  
PKA 04**

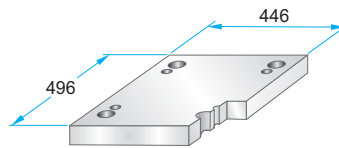
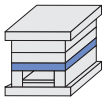

PK 04 - 446 x 496 x	h /	material
PKA 04 - 446 x 496 x	h /	
	36	1730
	46	2312
	56	2085
	66	
	76	
	86	

**PK 05  
PKA 05**

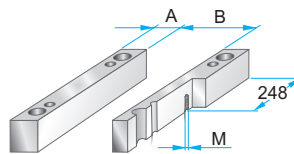
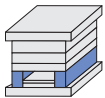

	A	B	M
<b>PK 05</b>	62	322	-
<b>PKA 05</b>	62	322	M10

PK 05 - 446 x 496 x	h /	material
PKA 05 - 446 x 496 x	h /	
	66	1730
	76	2085
	86	
	96	
	116	
	136	
	156	

**PK 55  
PKA 55**

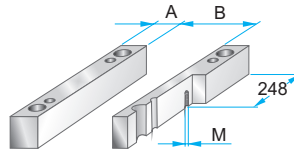
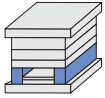

	A	B	M
<b>PK 55</b>	86	274	-
<b>PKA 55</b>	86	274	M10

PK 55 - 446 x 496 x	h /	material
PKA 55 - 446 x 496 x	h /	
	66	1730
	76	2085
	86	
	96	
	116	
	136	
	156	

**PK 06  
PKA 06**

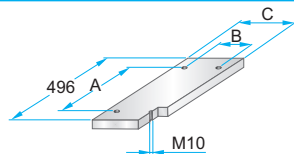

	A	B	C
<b>PK 06</b>	414	286	318
<b>PKA 06</b>	360	280	318

PK 06 - 446 x 496 x	h /	material
PKA 06 - 446 x 496 x	h /	
	22	1730
		2085

**PK 65  
PKA 65**

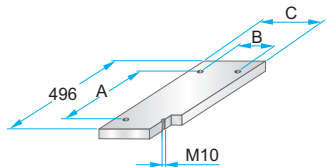
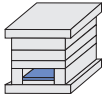

	A	B	C
<b>PK 65</b>	414	238	270
<b>PKA 65</b>	360	230	268

PK 65 - 446 x 496 x	h /	material
PKA 65 - 446 x 496 x	h /	
	22	1730
		2085

**PK 07  
PKA 07**

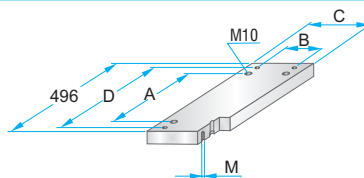
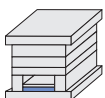

	A	B	C	D	M
<b>PK 07</b>	414	286	318	464	M4
<b>PKA 07</b>	360	280	318	458	M5

PK 07 - 446 x 496 x	h /	material
PKA 07 - 446 x 496 x	h /	
	27	1730
		2312
		2085

**PK 75  
PKA 75**

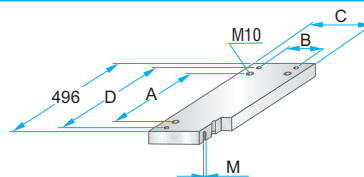
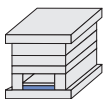

	A	B	C	D	M
<b>PK 75</b>	414	238	270	464	M4
<b>PKA 75</b>	360	230	268	458	M5

PK 75 - 446 x 496 x	h /	material
PKA 75 - 446 x 496 x	h /	
	27	1730
		2312
		2085