

**Korpus formy**

Mold base

**446x796**

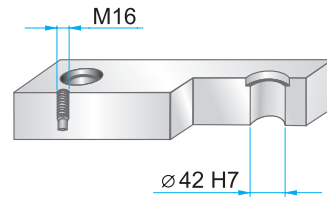
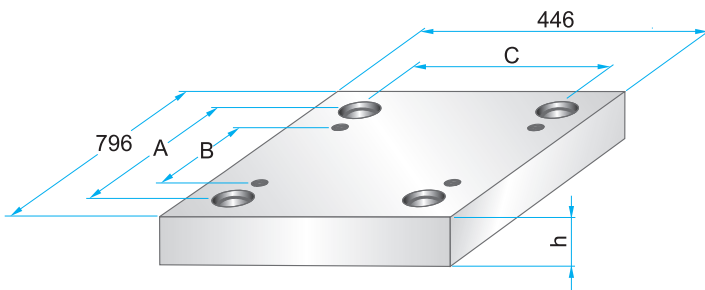

Wymiary i tolerancje  
Dimensions and tolerances



	A	B	C
<b>PK</b>	724	630	374
<b>PKA</b>	724	630	374

**PKA 01**

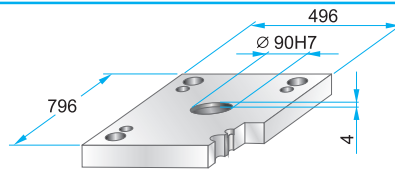

**PKA 01 – 446 x 796 x h / material**

46	1730
	2312
	2085

**PK 11  
PKA 11**



	W
<b>PK 11</b>	546
<b>PKA 11</b>	496

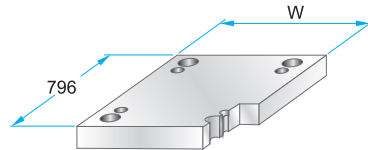

**PK 11 – 446 x 796 x h / material**  
**PKA 11 – 446 x 796 x h / material**

46	1730
56	2312
	2085

**PK 02  
PKA 02**



**PK 12  
PKA 12**

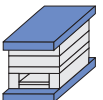

**PKA 21**

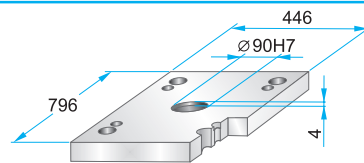

**PKA 21 – 446 x 796 x h / material**

46	1730
	2312
	2085

**PK 22  
PKA 22**

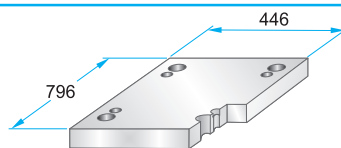

**PK 22 – 446 x 796 x h / material**  
**PKA 22 – 446 x 796 x h / material**

36	1730
46	2312
	2085

**PK 03  
PKA 03**

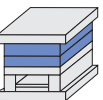

Podcięcia do demontażu  
na życzenie.  
Corner undercuts upon request.

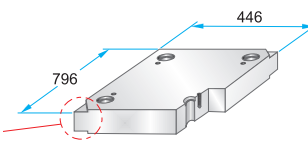

**PK 03 – 446 x 796 x h / material**  
**PKA 03 – 446 x 796 x h / material**

**PK 35 – 446 x 796 x h / material**  
**PKA 35 – 446 x 796 x h / (a1/b1/h1)**

27	1730
36	2083
46	2085
56	2162
66	2311
76	2312
86	2738
96	Toolox33
116	Toolox44
136	2738HH
156	2714HH
176	

**PK 35  
PKA 35**

Podcięcia do demontażu  
na życzenie.  
Corner undercuts upon request.

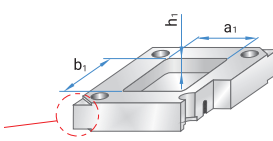

Material info



**Korpus formy**

Mold base

**446x796**

**PK 31**

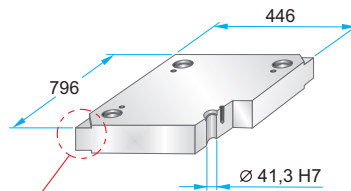
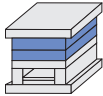

**PK 31 - 446 x 796 x h / material**

h	material
36	1730
46	2083
56	2085
66	2162
76	2311
86	2312
96	2343
116	2738
136	2767
156	Toolox33
176	Toolox44
	2738HH
	2714HH

Podcięcia do demontażu na życzenie.  
Corner undercuts upon request.



Material info



**PK 04  
PKA 04**

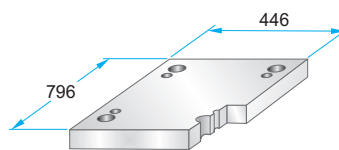
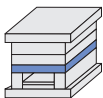

**PK 04 - 446 x 796 x h / material**  
**PKA 04 - 446 x 796 x h / material**

h	material
46	1730
56	2312
	2085

**PK 05  
PKA 05**

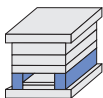

	A	B	M
<b>PK 05</b>	62	322	-
<b>PKA 05</b>	62	322	M10

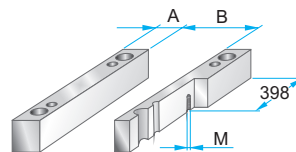

**PK 05 - 446 x 796 x h / material**  
**PKA 05 - 446 x 796 x h / material**

h	material
76	1730
86	2085
96	
116	
136	
156	

**PK 55  
PKA 55**

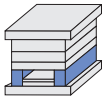

	A	B	M
<b>PK 55</b>	86	274	-
<b>PKA 55</b>	86	274	M10

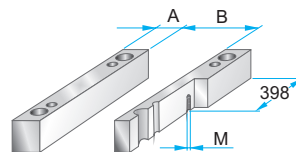

**PK 55 - 446 x 796 x h / material**  
**PKA 55 - 446 x 796 x h / material**

h	material
76	1730
86	2085
96	
116	
136	
156	

**PK 06  
PKA 06**

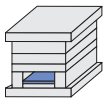

	A	B	C
<b>PK 06</b>	714	286	318
<b>PKA 06</b>	660	280	318

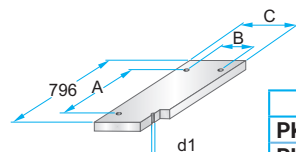

**PK 06 - 446 x 796 x h / material**  
**PKA 06 - 446 x 796 x h / material**

h	material
27	1730
	2085

	d1
<b>PK 06</b>	M12
<b>PKA 06</b>	M10

**PK 65  
PKA 65**

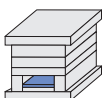

	A	B	C
<b>PK 65</b>	714	238	270
<b>PKA 65</b>	660	230	268

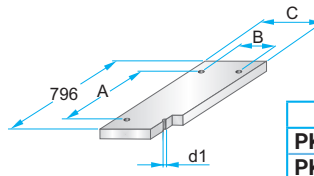

**PK 65 - 446 x 796 x h / material**  
**PKA 65 - 446 x 796 x h / material**

h	material
27	1730
	2085

	d1
<b>PK 65</b>	M12
<b>PKA 65</b>	M10

**PK 07  
PKA 07**

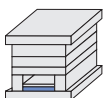

	A	B	C	D	M
<b>PK 07</b>	714	286	318	-	-
<b>PKA 07</b>	660	280	318	758	M5

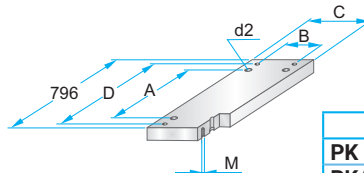

**PK 07 - 446 x 796 x h / material**  
**PKA 07 - 446 x 796 x h / material**

h	material
36	1730
	2312
	2085

	d2
<b>PK 07</b>	M12
<b>PKA 07</b>	M10

**PK 75  
PKA 75**

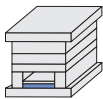

	A	B	C	D	M
<b>PK 75</b>	714	238	270	-	-
<b>PKA 75</b>	660	230	268	758	M5

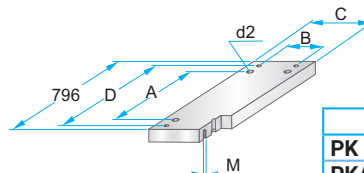

**PK 75 - 446 x 796 x h / material**  
**PKA 75 - 446 x 796 x h / material**

h	material
36	1730
	2312
	2085

	d2
<b>PK 75</b>	M12
<b>PKA 75</b>	M10