

**Korpus formy**

Mold base

**446x896**

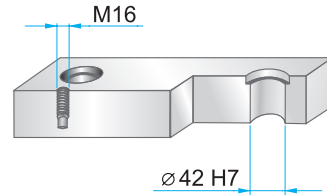
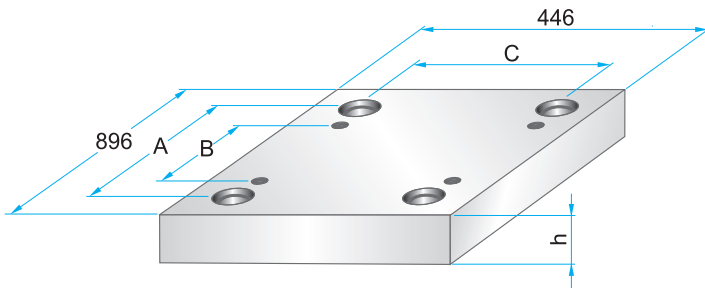

Wymiary i tolerancje  
Dimensions and tolerances



	A	B	C
<b>PK</b>	824	730	374
<b>PKA</b>	824	730	374

**PKA 01**

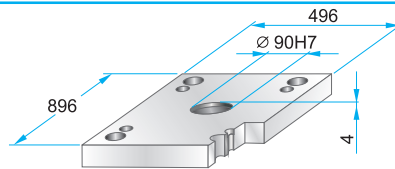
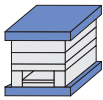

**PKA 01 – 446 x 896 x h / material**

46	1730
	2312
	2085

**PK 11  
PKA 11**



	W
<b>PK 11</b>	546
<b>PKA 11</b>	496

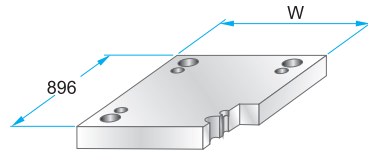

**PK 11 – 446 x 896 x h / material  
PKA 11 – 446 x 896 x h / material**

46	1730
56	2312
	2085

**PK 02  
PKA 02**

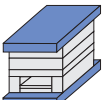

**PK 12  
PKA 12**



**PKA 21**

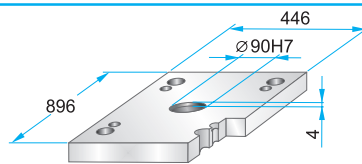
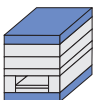

**PKA 21 – 446 x 896 x h / material**

46	1730
	2312
	2085

**PK 22  
PKA 22**

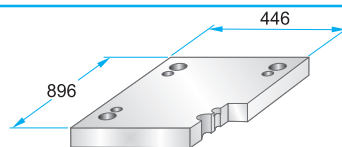

**PK 22 – 446 x 896 x h / material  
PKA 22 – 446 x 896 x h / material**

36	1730
46	2312
	2085

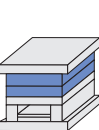

**PK 03  
PKA 03**

Podcięcia do demontażu  
na życzenie.  
Corner undercuts upon request.

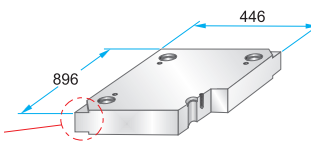

**PK 03 – 446 x 896 x h / material  
PKA 03 – 446 x 896 x h / material**

**PK 35 – 446 x 896 x h / material  
PKA 35 – 446 x 896 x h / (a1/b1/h1)**

27	1730
36	2083
46	2085
56	2162
66	2311
76	2312
86	2738
96	Toolox33
116	Toolox44
136	2738HH
156	2714HH
176	

**PK 35  
PKA 35**

Podcięcia do demontażu  
na życzenie.  
Corner undercuts upon request.

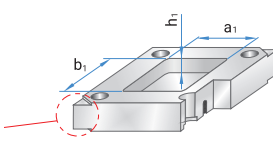

Material info



**Korpus formy**

Mold base

**446x896**

**PK 31**

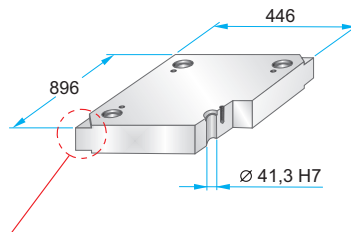
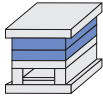

**PK 31 - 446 x 896 x h / material**

36	1730
46	2083
56	2085
66	2162
76	2311
86	2312
96	2343
116	2738
136	2767
156	Toolox33
	Toolox44
	2738HH
	2714HH

Podcięcia do demontażu na życzenie.  
Corner undercuts upon request.



Material info



**PK 04  
PKA 04**

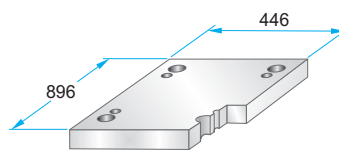
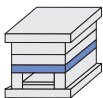

**PK 04 - 446 x 896 x h / material  
PKA 04 - 446 x 896 x h / material**

46	1730
56	2312
	2085

**PK 05  
PKA 05**

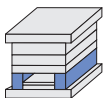

	A	B	M
<b>PK 05</b>	62	322	-
<b>PKA 05</b>	62	322	M10

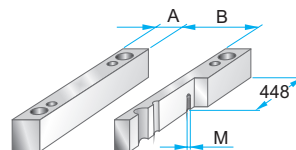

**PK 05 - 446 x 896 x h / material  
PKA 05 - 446 x 896 x h / material**

76	1730
86	2085
96	
116	
136	
156	

**PK 55  
PKA 55**

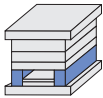

	A	B	M
<b>PK 55</b>	86	274	-
<b>PKA 55</b>	86	274	M10

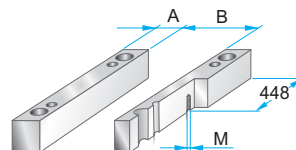

**PK 55 - 446 x 896 x h / material  
PKA 55 - 446 x 896 x h / material**

76	1730
86	2085
96	
116	
136	
156	

**PK 06  
PKA 06**

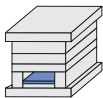

	A	B	C
<b>PK 06</b>	814	286	318
<b>PKA 06</b>	760	280	318

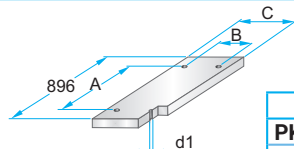

**PK 06 - 446 x 896 x h / material  
PKA 06 - 446 x 896 x h / material**

27	1730
	2085

	d1
<b>PK 06</b>	M12
<b>PKA 06</b>	M10

**PK 65  
PKA 65**

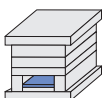

	A	B	C
<b>PK 65</b>	814	238	270
<b>PKA 65</b>	760	230	268

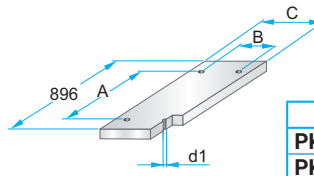

**PK 65 - 446 x 896 x h / material  
PKA 65 - 446 x 896 x h / material**

27	1730
	2085

	d1
<b>PK 65</b>	M12
<b>PKA 65</b>	M10

**PK 07  
PKA 07**

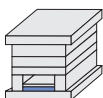

	A	B	C	D	M
<b>PK 07</b>	814	286	318	-	-
<b>PKA 07</b>	760	280	318	858	M5

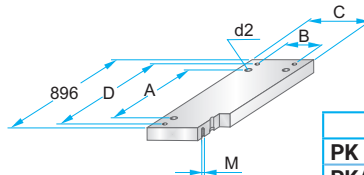

**PK 07 - 446 x 896 x h / material  
PKA 07 - 446 x 896 x h / material**

36	1730
	2312
	2085

	d2
<b>PK 07</b>	M12
<b>PKA 07</b>	M10

**PK 75  
PKA 75**

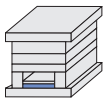

	A	B	C	D	M
<b>PK 75</b>	814	238	270	-	-
<b>PKA 75</b>	760	230	268	858	M5

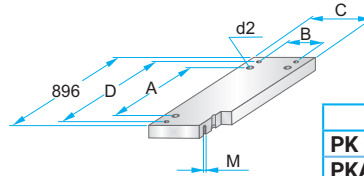

**PK 75 - 446 x 896 x h / material  
PKA 75 - 446 x 896 x h / material**

36	1730
	2312
	2085

	d2
<b>PK 75</b>	M12
<b>PKA 75</b>	M10