

Korpus formy

Mold base

496x496

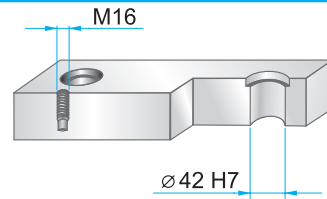
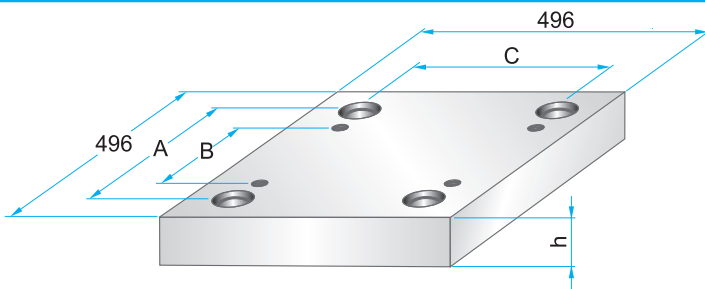

Wymiary i tolerancje
Dimensions and tolerances



	A	B	C
PK	424	330	424
PKA	424	330	424

**PK 01
PKA 01**



	W
PK 01	596
PKA 01	546

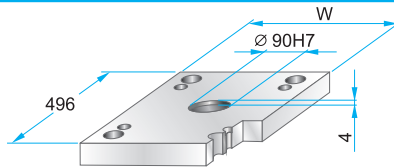

PK 01 – 496 x 496 x h / material
PKA 01 – 496 x 496 x h / material

36	1730
46	2312
56	2085

**PK 11
PKA 11**



	W
PK 11	596
PKA 11	546

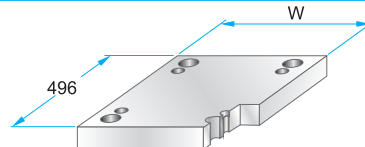

PK 11 – 496 x 496 x h / material
PKA 11 – 496 x 496 x h / material

36	1730
46	2312
56	2085

**PK 02
PKA 02**

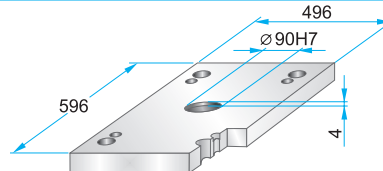
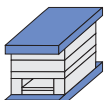

PK 02 – 496 x 496 x h / material
PKA 02 – 496 x 496 x h / material

36	1730
46	2312
56	2085

**PK 12
PKA 12**

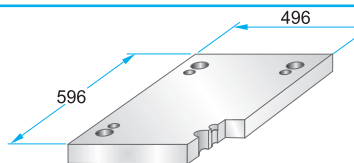
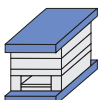

PK 12 – 496 x 496 x h / material
PKA 12 – 496 x 496 x h / material

36	1730
46	2312
56	2085

**PK 21
PKA 21**

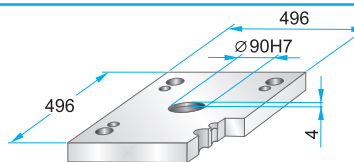
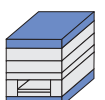

PK 21 – 496 x 496 x h / material
PKA 21 – 496 x 496 x h / material

27	1730
36	2312
46	2085
56	

**PK 22
PKA 22**

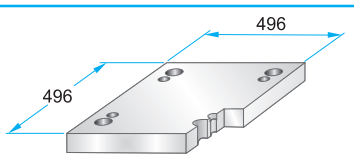

PK 22 – 496 x 496 x h / material
PKA 22 – 496 x 496 x h / material

27	1730
36	2312
46	2085
56	

**PK 03
PKA 03**

Podcięcia do demontażu
na życzenie.
Corner undercuts upon request.

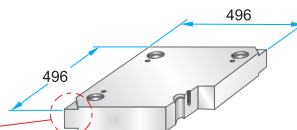

PK 03 – 496 x 496 x h / material
PKA 03 – 496 x 496 x h / material

PK 35 – 496 x 496 x h / material
PKA 35 – 496 x 496 x h / (a1/b1/h1)

27	1730
36	2083
46	2085
56	2162
66	2311
76	2312
86	2738
96	Toolox33
116	Toolox44
136	2738HH
156	2714HH
176	

**PK 35
PKA 35**

Podcięcia do demontażu
na życzenie.
Corner undercuts upon request.

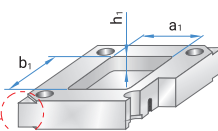

Material info



Korpus formy

Mold base

496x496

**PK 31
PKA 31**

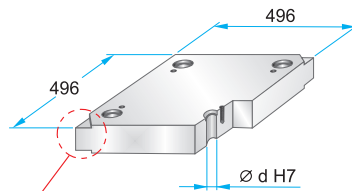
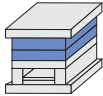

Podcięcia do demontażu na życzenie.
Corner undercuts upon request.



	d
PK 31	41,3
PKA 31	41,4

PK 31 – 496 x 496 x h / material
PKA 31 – 496 x 496 x h / material

27	1730
36	2083
46	2085
56	2162
66	2311
76	2312
86	2343
96	2738
116	2767
136	Toolox33
156	Toolox44
176	2738HH
	2714HH

Material info



**PK 04
PKA 04**

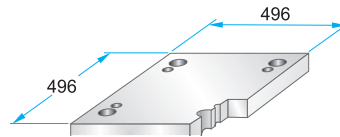
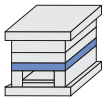

PK 04 – 496 x 496 x h / material
PKA 04 – 496 x 496 x h / material

46	1730
56	2312
66	2085
76	
86	
96	

**PK 05
PKA 05**

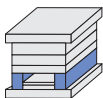

	A	B	M
PK 05	62	372	-
PKA 05	62	372	M10

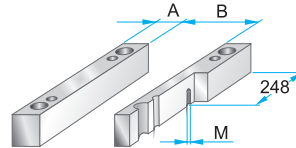

PK 05 – 496 x 496 x h / material
PKA 05 – 496 x 496 x h / material

66	1730
76	2085
86	
96	
116	
136	
156	

**PK 55
PKA 55**

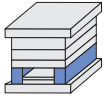

	A	B	M
PK 55	86	324	-
PKA 55	86	324	M10

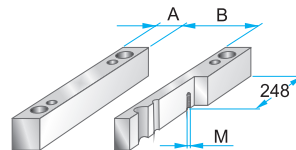

PK 55 – 496 x 496 x h / material
PKA 55 – 496 x 496 x h / material

66	1730
76	2085
86	
96	
116	
136	
156	

**PK 06
PKA 06**

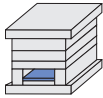

	A	B	C
PK 06	414	336	368
PKA 06	360	330	368

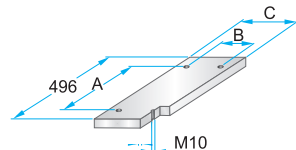

PK 06 – 496 x 496 x h / material
PKA 06 – 496 x 496 x h / material

22	1730
27	2085

**PK 65
PKA 65**

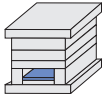

	A	B	C
PK 65	414	288	320
PKA 65	360	280	318

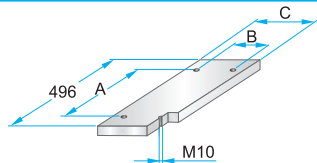

PK 65 – 496 x 496 x h / material
PKA 65 – 496 x 496 x h / material

22	1730
27	2085

**PK 07
PKA 07**

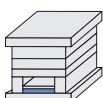

	A	B	C	D	M
PK 07	414	336	368	464	M4
PKA 07	360	330	368	458	M5

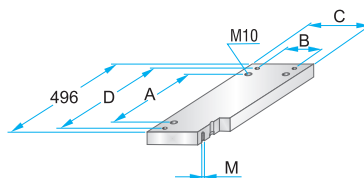

PK 07 – 496 x 496 x h / material
PKA 07 – 496 x 496 x h / material

27	1730
36	2312
	2085

**PK 75
PKA 75**

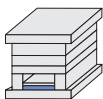

	A	B	C	D	M
PK 75	414	288	320	464	M4
PKA 75	360	280	318	458	M5

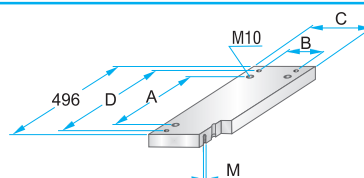

PK 75 – 496 x 496 x h / material
PKA 75 – 496 x 496 x h / material

27	1730
36	2312
	2085