

**Korpus formy**

Mold base

**496x646**

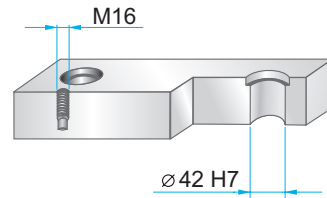
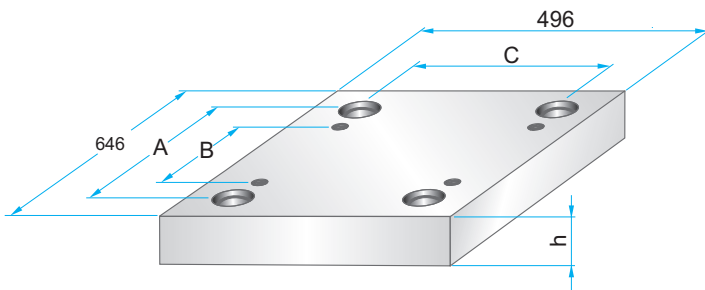

Wymiary i tolerancje  
Dimensions and tolerances



	A	B	C
<b>PK</b>	574	480	424
<b>PKA</b>	574	480	424

**PK 01  
PKA 01**



	W
<b>PK 01</b>	596
<b>PKA 01</b>	546

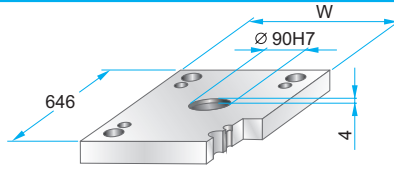

**PK 01** - 496 x 646 x h / material  
**PKA 01** - 496 x 646 x h / material

46	1730
56	2312
	2085

**PK 11  
PKA 11**

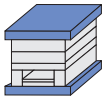

	W
<b>PK 11</b>	596
<b>PKA 11</b>	546

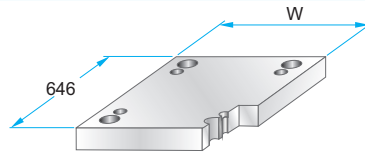

**PK 11** - 496 x 646 x h / material  
**PKA 11** - 496 x 646 x h / material

46	1730
56	2312
	2085

**PK 02  
PKA 02**



**PK 12  
PKA 12**

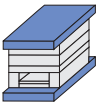

**PK 21  
PKA 21**

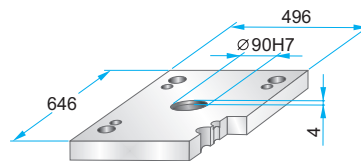
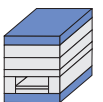

**PK 21** - 496 x 646 x h / material  
**PKA 21** - 496 x 646 x h / material

36	1730
46	2312
	2085

**PK 22  
PKA 22**

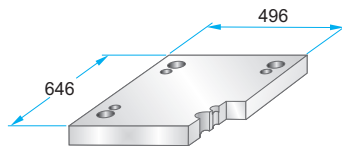

**PK 22** - 496 x 646 x h / material  
**PKA 22** - 496 x 646 x h / material

36	1730
46	2312
	2085

**PK 03  
PKA 03**

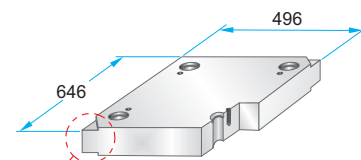
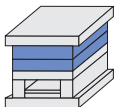

**PK 03** - 496 x 646 x h / material  
**PKA 03** - 496 x 646 x h / material

27	1730
36	2083
46	2085
56	2162
66	2311
76	2312
86	2738
96	Toolox33
116	Toolox44
136	2738HH
156	2714HH
176	

Podcięcia do demontażu na życzenie.  
Corner undercuts upon request.



Material info



**Korpus formy**

Mold base

**496x646**

**PK 31**

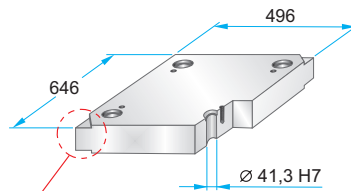
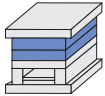

Podcięcia do demontażu na życzenie.  
Corner undercuts upon request.



**PK 31 - 496 x 646 x h / material**

h	material
36	1730
46	2083
56	2085
66	2162
76	2311
86	2312
96	2343
116	2738
136	2767
156	Toolox33
176	Toolox44
	2738HH
	2714HH

Material info



**PK 04  
PKA 04**

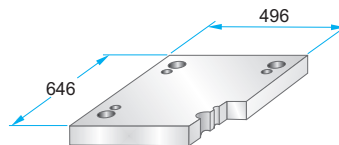
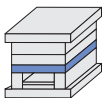

**PK 04 - 496 x 646 x h / material**  
**PKA 04 - 496 x 646 x h / material**

h	material
46	1730
56	2312
66	2085
76	
86	
96	

**PK 05  
PKA 05**

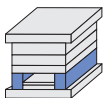

	A	B	M
<b>PK 05</b>	62	372	-
<b>PKA 05</b>	62	372	M10

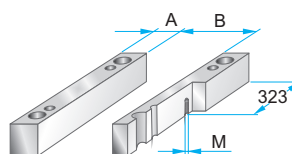

**PK 05 - 496 x 646 x h / material**  
**PKA 05 - 496 x 646 x h / material**

h	material
66	1730
76	2085
86	
96	
116	
136	
156	

**PK 55  
PKA 55**

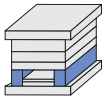

	A	B	M
<b>PK 55</b>	86	324	-
<b>PKA 55</b>	86	324	M10

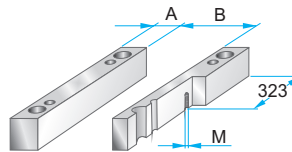

**PK 55 - 496 x 646 x h / material**  
**PKA 55 - 496 x 646 x h / material**

h	material
66	1730
76	2085
86	
96	
116	
136	
156	

**PK 06  
PKA 06**

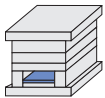

	A	B	C
<b>PK 06</b>	564	336	368
<b>PKA 06</b>	510	330	368

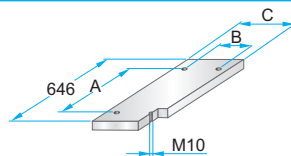

**PK 06 - 496 x 646 x h / material**  
**PKA 06 - 496 x 646 x h / material**

h	material
27	1730
	2085

**PK 65  
PKA 65**

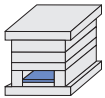

	A	B	C
<b>PK 65</b>	564	288	320
<b>PKA 65</b>	510	280	318

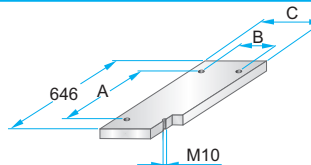

**PK 65 - 496 x 646 x h / material**  
**PKA 65 - 496 x 646 x h / material**

h	material
27	1730
	2085

**PK 07  
PKA 07**

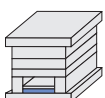

	A	B	C	D	M
<b>PK 07</b>	564	336	368	614	M4
<b>PKA 07</b>	510	330	368	608	M5

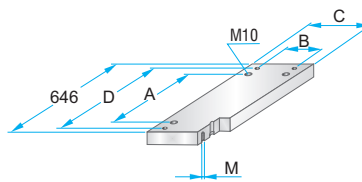

**PK 07 - 496 x 646 x h / material**  
**PKA 07 - 496 x 646 x h / material**

h	material
36	1730
	2312
	2085

**PK 75  
PKA 75**

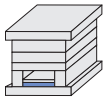

	A	B	C	D	M
<b>PK 75</b>	564	288	320	614	M4
<b>PKA 75</b>	510	280	318	608	M5

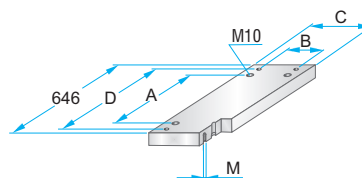

**PK 75 - 496 x 646 x h / material**  
**PKA 75 - 496 x 646 x h / material**

h	material
36	1730
	2312
	2085