

**Korpus formy**

Mold base

**496x696**

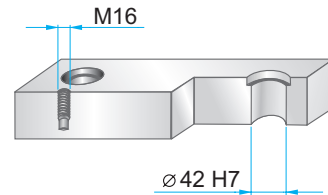
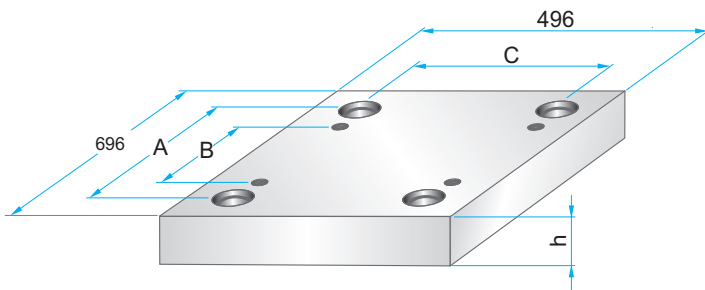

Wymiary i tolerancje  
Dimensions and tolerances



	A	B	C
<b>PK</b>	624	530	424
<b>PKA</b>	624	530	424

**PK 01  
PKA 01**



	W
<b>PK 01</b>	596
<b>PKA 01</b>	546

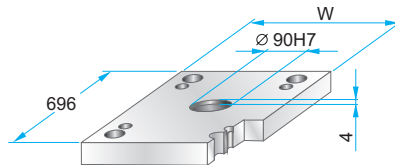

**PK 01** - 496 x 696 x h / material  
**PKA 01** - 496 x 696 x h / material

46	1730
56	2312
	2085

**PK 11  
PKA 11**

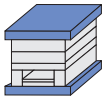

	W
<b>PK 11</b>	596
<b>PKA 11</b>	546

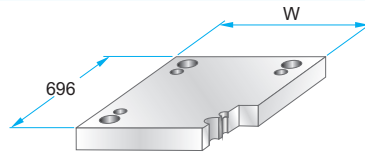

**PK 11** - 496 x 696 x h / material  
**PKA 11** - 496 x 696 x h / material

46	1730
56	2312
	2085

**PK 02  
PKA 02**



**PK 12  
PKA 12**

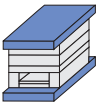

**PK 21  
PKA 21**

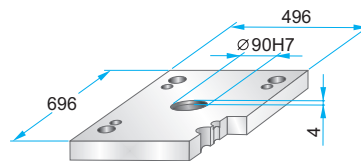
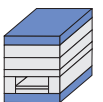

**PK 21** - 496 x 696 x h / material  
**PKA 21** - 496 x 696 x h / material

36	1730
46	2312
	2085

**PK 22  
PKA 22**

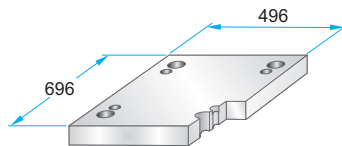

**PK 22** - 496 x 696 x h / material  
**PKA 22** - 496 x 696 x h / material

36	1730
46	2312
	2085

**PK 03  
PKA 03**

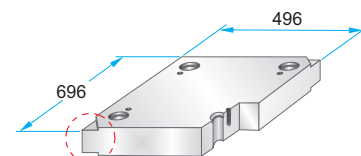
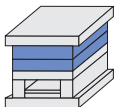

**PK 03** - 496 x 696 x h / material  
**PKA 03** - 496 x 696 x h / material

27	1730
36	2083
46	2085
56	2162
66	2311
76	2312
86	2738
96	Toolox33
116	Toolox44
136	2738HH
156	2714HH
176	

Podcienia do demontażu na życzenie.  
Corner undercuts upon request.



Material info



**Korpus formy**

Mold base

**496x696**

**PK 31**

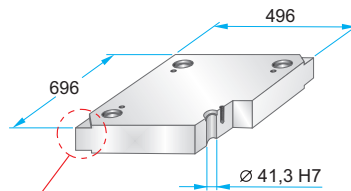
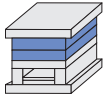

**PK 31 - 496 x 696 x h / material**

36	1730
46	2083
56	2085
66	2162
76	2311
86	2312
96	2343
116	2738
136	2767
156	Toolox33
176	Toolox44
	2738HH
	2714HH

Podcięcia do demontażu na życzenie.  
Corner undercuts upon request.



Material info



**PK 04  
PKA 04**

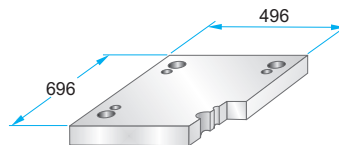
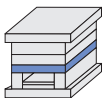

**PK 04 - 496 x 696 x h / material**  
**PKA 04 - 496 x 696 x h / material**

46	1730
56	2312
	2085

**PK 05  
PKA 05**

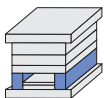

	A	B	M
<b>PK 05</b>	62	372	-
<b>PKA 05</b>	62	372	M10

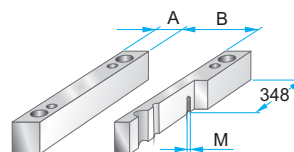

**PK 05 - 496 x 696 x h / material**  
**PKA 05 - 496 x 696 x h / material**

76	1730
86	2085
96	
116	
136	
156	

**PK 55  
PKA 55**

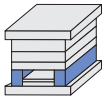

	A	B	M
<b>PK 55</b>	86	324	-
<b>PKA 55</b>	86	324	M10

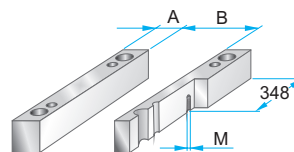

**PK 55 - 496 x 696 x h / material**  
**PKA 55 - 496 x 696 x h / material**

76	1730
86	2085
96	
116	
136	
156	

**PK 06  
PKA 06**

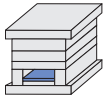

	A	B	C
<b>PK 06</b>	614	336	368
<b>PKA 06</b>	560	330	368

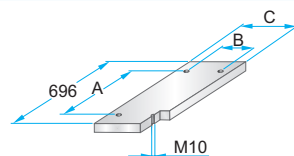

**PK 06 - 496 x 696 x h / material**  
**PKA 06 - 496 x 696 x h / material**

27	1730
	2085

**PK 65  
PKA 65**

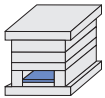

	A	B	C
<b>PK 65</b>	614	288	320
<b>PKA 65</b>	560	280	318

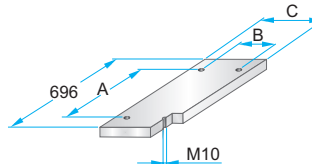

**PK 65 - 496 x 696 x h / material**  
**PKA 65 - 496 x 696 x h / material**

27	1730
	2085

**PK 07  
PKA 07**

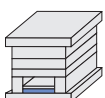

	A	B	C	D	M
<b>PK 07</b>	614	336	368	664	M4
<b>PKA 07</b>	560	330	368	658	M5

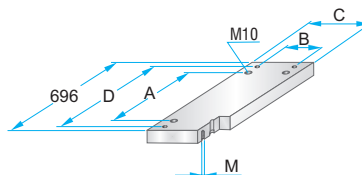

**PK 07 - 496 x 696 x h / material**  
**PKA 07 - 496 x 696 x h / material**

36	1730
	2312
	2085

**PK 75  
PKA 75**

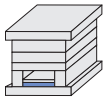

	A	B	C	D	M
<b>PK 75</b>	614	288	320	664	M4
<b>PKA 75</b>	560	280	318	658	M5

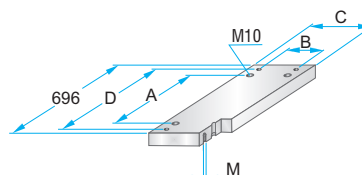

**PK 75 - 496 x 696 x h / material**  
**PKA 75 - 496 x 696 x h / material**

36	1730
	2312
	2085