

Korpus formy

Mold base

496x896

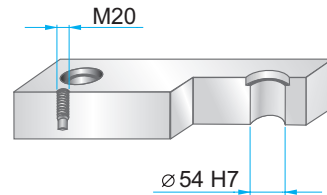
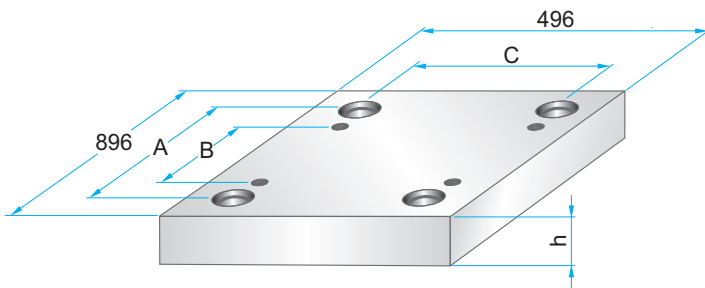

Wymiary i tolerancje
Dimensions and tolerances



	A	B	C
PK	792	674	392
PKA	808	690	408

PKA 01

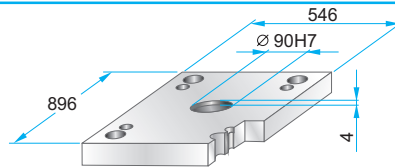
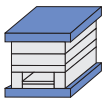

PKA 01 – 496 x 896 x h / material

46	1730
	2312
	2085

**PK 11
PKA 11**

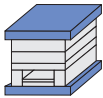

	W
PK 11	596
PKA 11	546

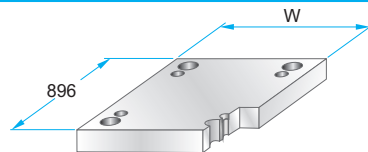

PK 11 – 496 x 896 x h / material
PKA 11 – 496 x 896 x h / material

46	1730
56	2312
	2085

**PK 02
PKA 02**



**PK 12
PKA 12**

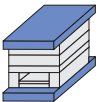

PKA 21

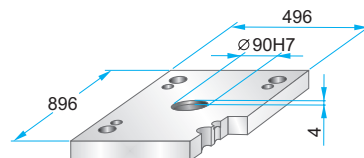
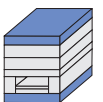

PKA 21 – 496 x 896 x h / material

46	1730
	2312
	2085

**PK 22
PKA 22**

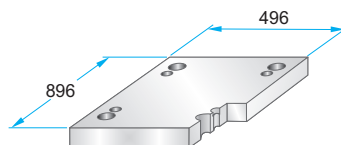

PK 22 – 496 x 896 x h / material
PKA 22 – 496 x 896 x h / material

46	1730
	2312
	2085

**PK 03
PKA 03**

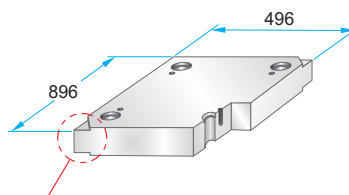
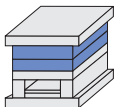

PK 03 – 496 x 896 x h / material
PKA 03 – 496 x 896 x h / material

27	1730
36	2083
46	2085
56	2162
66	2311
76	2312
86	2738
96	Toolox33
116	Toolox44
136	2738HH
156	2714HH
176	
196	

Podcięcia do demontażu na życzenie.
Corner undercuts upon request.



Material info



Korpus formy

Mold base

496x896

PK 31

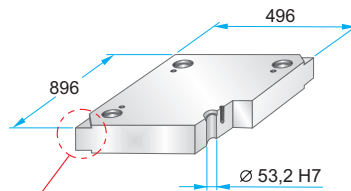
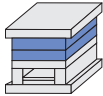

PK 31 - 496 x 896 x h / material

46	1730
56	2083
66	2085
76	2162
86	2311
96	2312
116	2343
136	2738
156	2767
176	Toolox33
196	Toolox44
	2738HH
	2714HH

Podcięcia do demontażu na życzenie.
Corner undercuts upon request.



Material info



**PK 04
PKA 04**

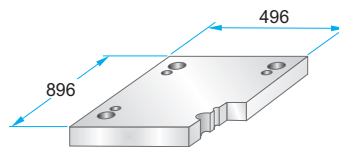
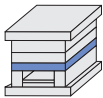

PK 04 - 496 x 896 x h / material
PKA 04 - 496 x 896 x h / material

46	1730
56	2312
76	2085

**PK 05
PKA 05**

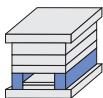

	A	B	M
PK 05	84	328	-
PKA 05	76	344	M12

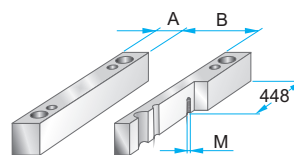

PK 05 - 496 x 896 x h / material
PKA 05 - 496 x 896 x h / material

86	1730
96	2085
116	
136	
156	
176	

PK 55

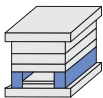

	A	B
PK 55	114	268

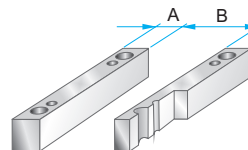

PK 55 - 496 x 896 x h / material

96	1730
116	2085
136	
156	

**PK 06
PKA 06**

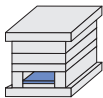

	A	B	C
PK 06	810	288	324
PKA 06	740	300	338

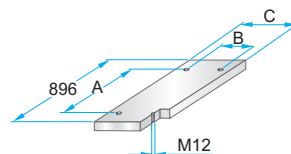

PK 06 - 496 x 896 x h / material
PKA 06 - 496 x 896 x h / material

27	1730
	2085

PK 65

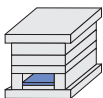

	A	B	C
PK 65	810	228	264

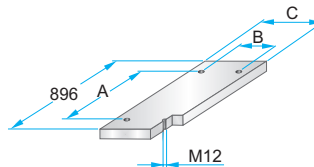

PK 65 - 496 x 896 x h / material

27	1730
	2085

**PK 07
PKA 07**

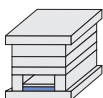

	A	B	C	D	M
PK 07	810	288	324	-	-
PKA 07	740	300	338	858	M5

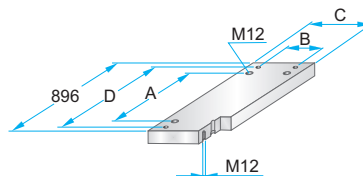

PK 07 - 496 x 896 x h / material
PKA 07 - 496 x 896 x h / material

36	1730
	2312
	2085

PK 75

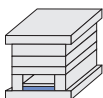

	A	B	C
PK 75	810	228	264

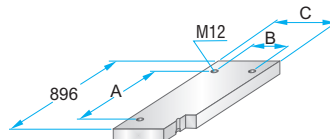

PK 75 - 496 x 896 x h / material

36	1730
	2312
	2085