

Korpus formy

Mold base

546x796

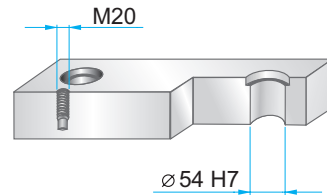
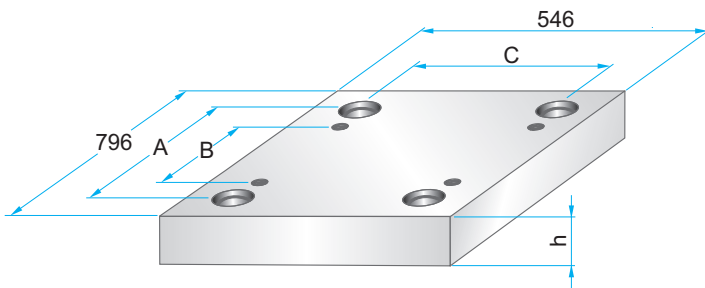

Wymiary i tolerancje
Dimensions and tolerances



	A	B	C
PK	692	574	442
PKA	708	590	458

**PK 01
PKA 01**

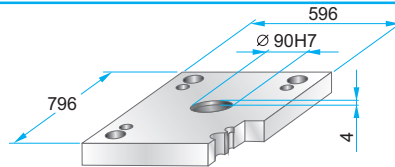
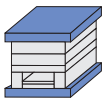

PK 01 – 546 x 796 x h / material
PKA 01 – 546 x 796 x h / material

46	1730
	2312
	2085

**PK 11
PKA 11**



	W
PK 11	646
PKA 11	596

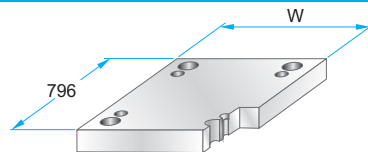

PK 11 – 546 x 796 x h / material
PKA 11 – 546 x 796 x h / material

46	1730
56	2312
	2085

**PK 02
PKA 02**



**PK 12
PKA 12**

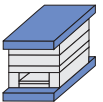

PKA 21

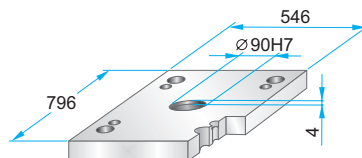
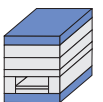

PKA 21 – 546 x 796 x h / material

46	1730
	2312
	2085

**PK 22
PKA 22**

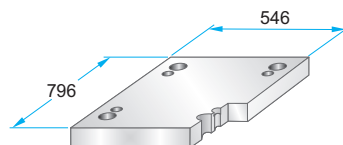

PK 22 – 546 x 796 x h / material
PKA 22 – 546 x 796 x h / material

36	1730
46	2312
	2085

**PK 03
PKA 03**

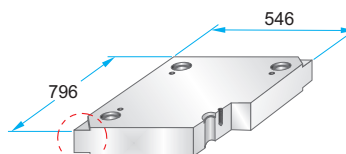
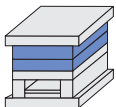

PK 03 – 546 x 796 x h / material
PKA 03 – 546 x 796 x h / material

27	1730
36	2083
46	2085
56	2162
66	2311
76	2312
86	2738
96	Toolox33
116	Toolox44
136	2738HH
156	2714HH
176	
196	

Podcięcia do demontażu na życzenie.
Corner undercuts upon request.



Material info



Korpus formy

Mold base

546x796

PK 31

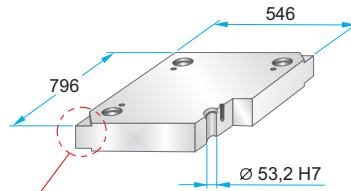
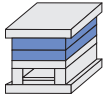

Podcięcia do demontażu na życzenie.
Corner undercuts upon request.



PK 31 - 546 x 796 x h / material

h	material
46	1730
56	2083
66	2085
76	2162
86	2311
96	2312
116	2343
136	2738
156	2767
176	Toolox33
196	Toolox44
	2738HH
	2714HH

Material info



**PK 04
PKA 04**

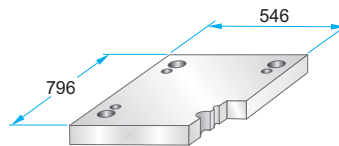
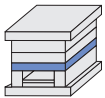

PK 04 - 546 x 796 x h / material
PKA 04 - 546 x 796 x h / material

h	material
46	1730
56	2312
76	2085

**PK 05
PKA 05**

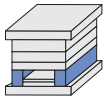

	A	B	M
PK 05	84	378	-
PKA 05	76	394	M12

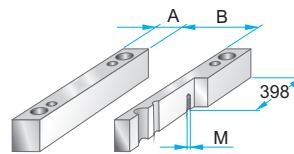

PK 05 - 546 x 796 x h / material
PKA 05 - 546 x 796 x h / material

h	material
86	1730
96	2085
116	
136	
156	
176	

**PK 55
PKA 55**

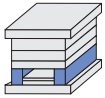

	A	B	M
PK 55	114	318	-
PKA 55	106	334	M12

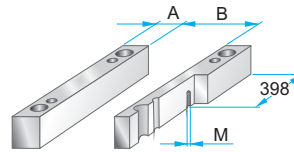

PK 55 - 546 x 796 x h / material
PKA 55 - 546 x 796 x h / material

h	material
86	1730
96	2085
116	
136	
156	
176	

**PK 06
PKA 06**

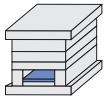

	A	B	C
PK 06	710	338	374
PKA 06	640	350	388

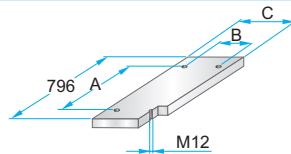

PK 06 - 546 x 796 x h / material
PKA 06 - 546 x 796 x h / material

h	material
27	1730
	2085

**PK 65
PKA 65**

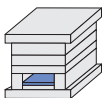

	A	B	C
PK 65	710	278	314
PKA 65	640	280	318

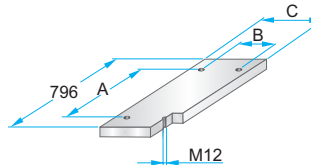

PK 65 - 546 x 796 x h / material
PKA 65 - 546 x 796 x h / material

h	material
27	1730
	2085

**PK 07
PKA 07**

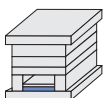

	A	B	C	D	M
PK 07	710	338	374	-	-
PKA 07	640	350	388	758	M5

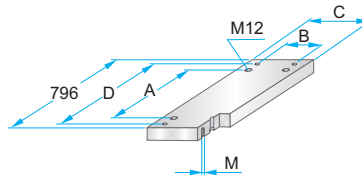

PK 07 - 546 x 796 x h / material
PKA 07 - 546 x 796 x h / material

h	material
36	1730
	2312
	2085

**PK 75
PKA 75**

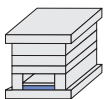

	A	B	C	D	M
PK 75	710	278	314	-	-
PKA 75	640	280	318	758	M5

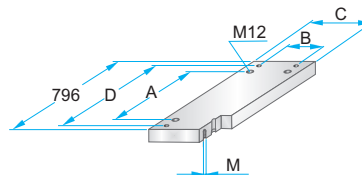

PK 75 - 546 x 796 x h / material
PKA 75 - 546 x 796 x h / material

h	material
36	1730
	2312
	2085