

Korpus formy

Mold base

546x896

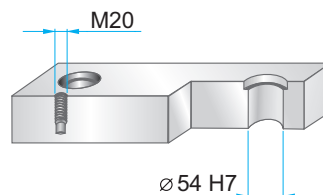
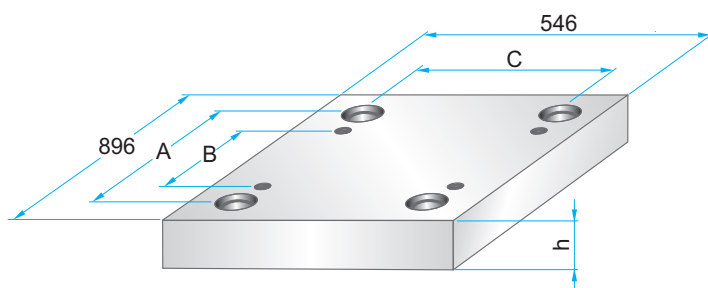

Wymiary i tolerancje
Dimensions and tolerances



	A	B	C
PK	792	674	442
PKA	808	690	458

PKA 01

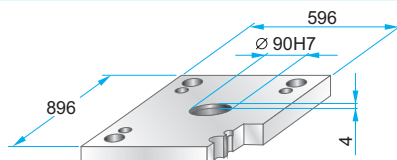

PKA 01 – 546 x 896 x h / material

46	1730
	2312
	2085

PK 11 PKA 11



	W
PK 11	646
PKA 11	596

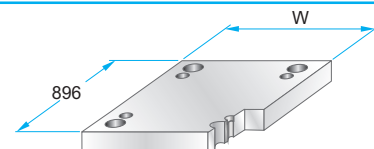

PK 11 – 546 x 896 x h / material
PKA 11 – 546 x 896 x h / material

46	1730
56	2312
	2085

PK 02 PKA 02

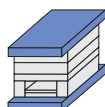

PK 12 PKA 12



PKA 21

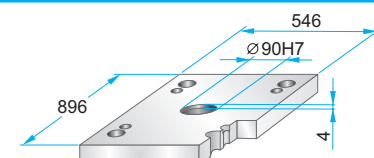
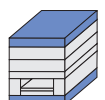

PKA 21 – 546 x 896 x h / material

46	1730
	2312
	2085

PK 22 PKA 22

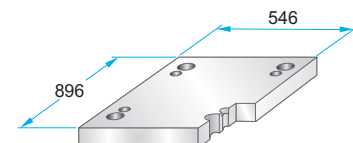

PK 22 – 546 x 896 x h / material
PKA 22 – 546 x 896 x h / material

46	1730
56	2312
	2085

PK 03 PKA 03

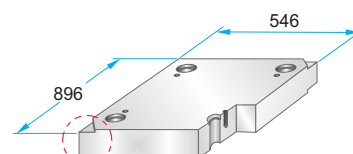
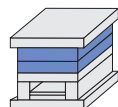

PK 03 – 546 x 896 x h / material
PKA 03 – 546 x 896 x h / material

27	1730
36	2083
46	2085
56	2162
66	2311
76	2312
86	2738
96	Toolox33
116	Toolox44
136	2738HH
156	2714HH
176	
196	

Podcięcia do demontażu na życzenie.
Corner undercuts upon request.



Material info



Korpus formy

Mold base

546x896

PK 31

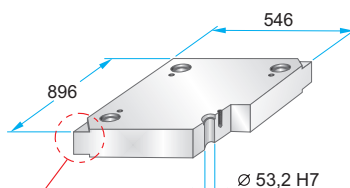
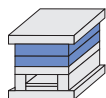

Podcięcia do demontażu na życzenie.
Corner undercuts upon request.



Material info



PK 31 – 546 x 896 x h / material

46	1730
56	2083
66	2085
76	2162
86	2311
96	2312
116	2343
136	2738
156	2767
176	Toolox33
196	Toolox44
	2738HH
	2714HH

PK 04 PKA 04

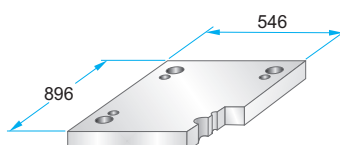
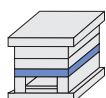

PK 04 – 546 x 896 x h / material PKA 04 – 546 x 896 x h / material

46	1730
56	2312
76	2085

PK 05 PKA 05

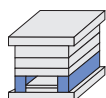

	A	B	M
PK 05	84	378	–
PKA 05	76	394	M12

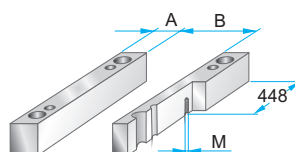

PK 05 – 546 x 896 x h / material PKA 05 – 546 x 896 x h / material

86	1730
96	2085
116	
136	
156	
176	

PK 55 PKA 55

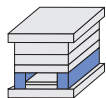

	A	B	M
PK 55	114	318	–
PKA 55	106	334	M12

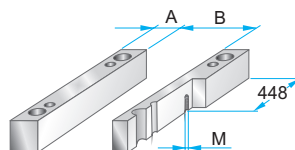

PK 55 – 546 x 896 x h / material PKA 55 – 546 x 896 x h / material

86	1730
96	2085
116	
136	
156	
176	

PK 06 PKA 06

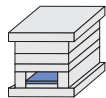

	A	B	C
PK 06	810	338	374
PKA 06	740	350	388

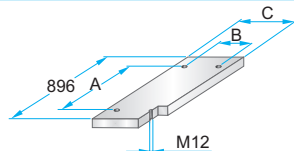

PK 06 – 546 x 896 x h / material PKA 06 – 546 x 896 x h / material

27	1730
	2085

PK 65 PKA 65

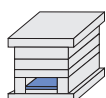

	A	B	C
PK 65	810	278	314
PKA 65	740	280	318

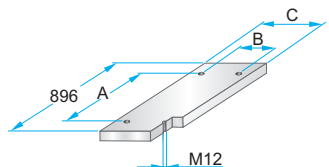

PK 65 – 546 x 896 x h / material PKA 65 – 546 x 896 x h / material

27	1730
	2085

PK 07 PKA 07

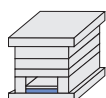

	A	B	C	D	M
PK 07	810	338	374	–	–
PKA 07	740	350	388	858	M5

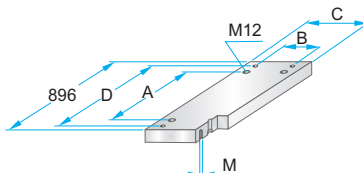

PK 07 – 546 x 896 x h / material PKA 07 – 546 x 896 x h / material

36	1730
	2312
	2085

PK 75 PKA 75

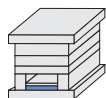

	A	B	C	D	M
PK 75	810	278	314	–	–
PKA 75	740	280	318	858	M5

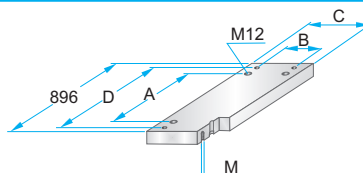

PK 75 – 546 x 896 x h / material PKA 75 – 546 x 896 x h / material

36	1730
	2312
	2085