

Korpus formy

Mold base

596x596

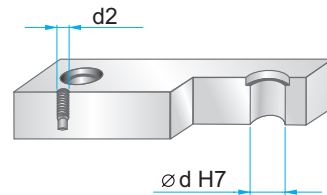
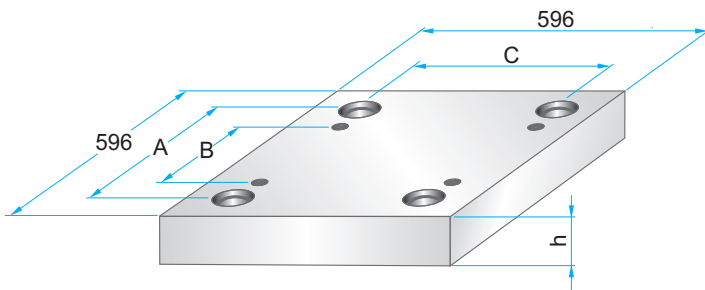

Wymiary i tolerancje
Dimensions and tolerances



	A	B	C	d	d2
PK	524	430	524	42	M16
PKA	508	390	508	54	M20

**PK 01
PKA 01**



	W
PK 01	696
PKA 01	646

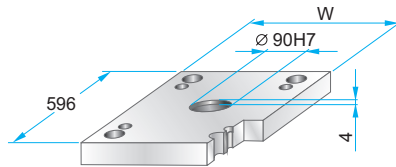

PK 01 – 596 x 596 x h / material
PKA 01 – 596 x 596 x h / material

46	1730
56	2312
	2085

**PK 11
PKA 11**

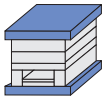

	W
PK 11	696
PKA 11	646

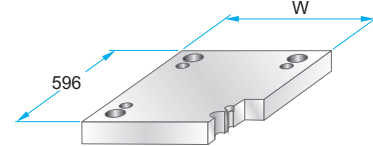

PK 11 – 596 x 596 x h / material
PKA 11 – 596 x 596 x h / material

46	1730
56	2312
	2085

**PK 02
PKA 02**



**PK 12
PKA 12**



**PK 21
PKA 21**

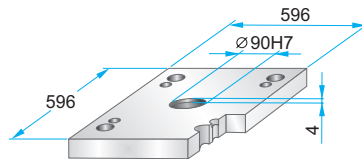
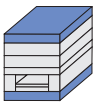

PK 21 – 596 x 596 x h / material
PKA 21 – 596 x 596 x h / material

36	1730
46	2312
	2085

**PK 22
PKA 22**

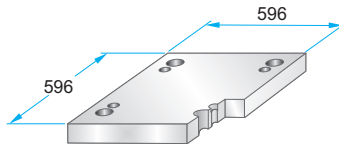

PK 22 – 596 x 596 x h / material
PKA 22 – 596 x 596 x h / material

36	1730
46	2312
	2085

**PK 03
PKA 03**

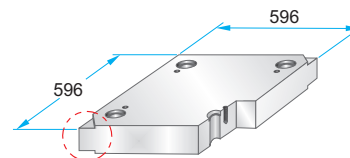
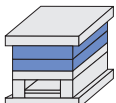

PK 03 – 596 x 596 x h / material
PKA 03 – 596 x 596 x h / material

27	1730
36	2083
46	2085
56	2162
66	2311
76	2312
86	2738
96	Toolox33
116	Toolox44
136	2738HH
156	2714HH
176	
196	

Podcięcia do demontażu na życzenie.
Corner undercuts upon request.



Material info



Korpus formy

Mold base

596x596

PK 31

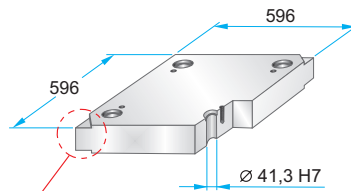
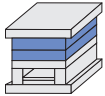

Podcięcia do demontażu na życzenie.
Corner undercuts upon request.



PK 31 - 596 x 596 x h / material

h	material
36	1730
46	2083
56	2085
66	2162
76	2311
86	2312
96	2343
116	2738
136	2767
156	Toolox33
176	Toolox44
196	2738HH 2714HH

Material info



**PK 04
PKA 04**

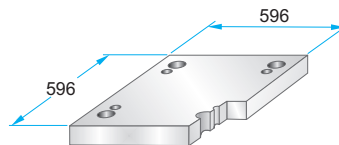
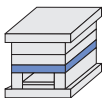

PK 04 - 596 x 596 x h / material
PKA 04 - 596 x 596 x h / material

h	material
46	1730
56	2312
76	2085

**PK 05
PKA 05**

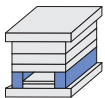

	A	B	M
PK 05	62	472	-
PKA 05	76	444	M12

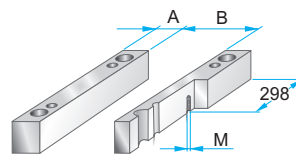

PK 05 - 596 x 596 x h / material
PKA 05 - 596 x 596 x h / material

h	material
66	1730
76	2085
86	
96	
116	
136	
156	
176	

**PK 55
PKA 55**

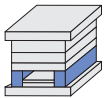

	A	B	M
PK 55	92	412	-
PKA 55	106	384	M12

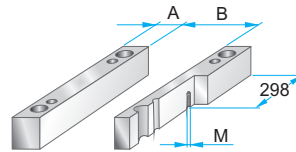

PK 55 - 596 x 596 x h / material
PKA 55 - 596 x 596 x h / material

h	material
66	1730
76	2085
86	
96	
116	
136	
156	
176	

**PK 06
PKA 06**

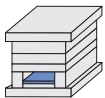

	A	B	C
PK 06	514	436	468
PKA 06	440	400	438

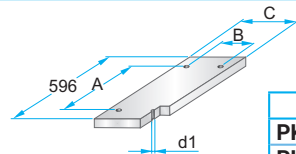

PK 06 - 596 x 596 x h / material
PKA 06 - 596 x 596 x h / material

h	material
27	1730 2085

	d1
PK 06	M10
PKA 06	M12

**PK 65
PKA 65**

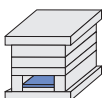

	A	B	C
PK 65	514	376	408
PKA 65	440	330	368

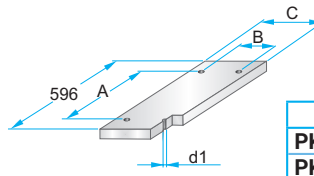

PK 65 - 596 x 596 x h / material
PKA 65 - 596 x 596 x h / material

h	material
27	1730 2085

	d1
PK 65	M10
PKA 65	M12

**PK 07
PKA 07**

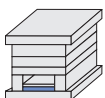

	A	B	C	D	M
PK 07	514	436	468	564	M4
PKA 07	440	400	438	558	M5

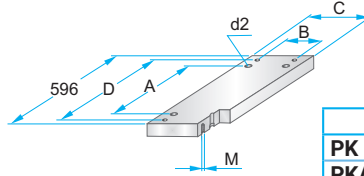

PK 07 - 596 x 596 x h / material
PKA 07 - 596 x 596 x h / material

h	material
36	1730 2312 2085

	d2
PK 07	M10
PKA 07	M12

**PK 75
PKA 75**

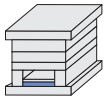

	A	B	C	D	M
PK 75	514	376	408	564	M4
PKA 75	440	330	368	558	M5

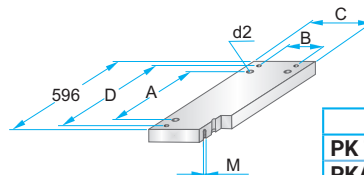

PK 75 - 596 x 596 x h / material
PKA 75 - 596 x 596 x h / material

h	material
36	1730 2312 2085

	d2
PK 75	M10
PKA 75	M12