

Korpus formy

Mold base

596x696

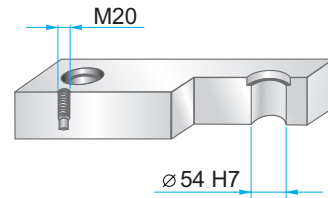
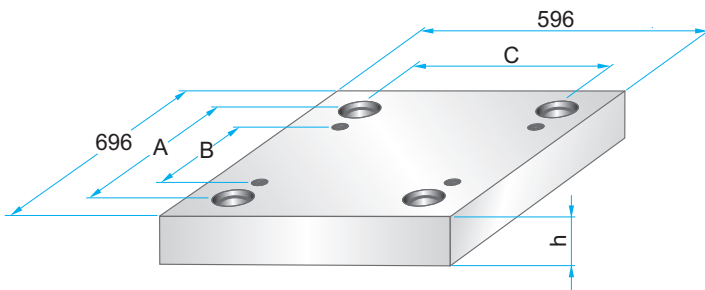

Wymiary i tolerancje
Dimensions and tolerances



	A	B	C
PK	592	474	492
PKA	608	490	508

PK 01



	W
PK 01	696
PKA 01	646

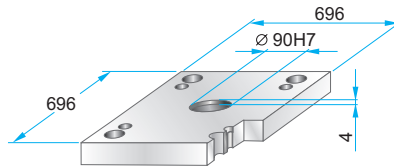

PK 01 – 596 x 696 x h / material
PKA 01 – 596 x 696 x h / material

46	1730
	2312
	2085

**PK 11
PKA 11**



	W
PK 11	696
PKA 11	646

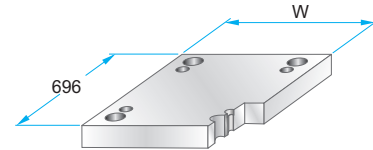

PK 11 – 596 x 696 x h / material
PKA 11 – 596 x 696 x h / material

46	1730
56	2312
	2085

**PK 02
PKA 02**



**PK 12
PKA 12**

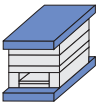

PK 21

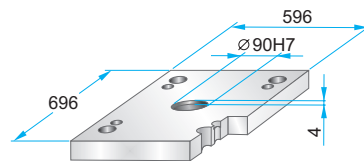
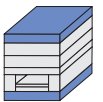

PK 21 – 596 x 696 x h / material

46	1730
	2312
	2085

**PK 22
PKA 22**

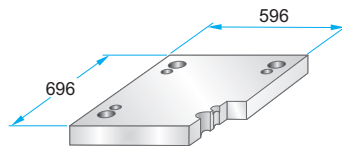

PK 22 – 596 x 696 x h / material
PKA 22 – 596 x 696 x h / material

46	1730
56	2312
	2085

**PK 03
PKA 03**

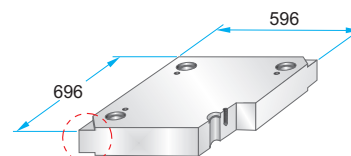
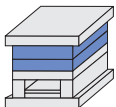

PK 03 – 596 x 696 x h / material
PKA 03 – 596 x 696 x h / material

27	1730
36	2083
46	2085
56	2162
66	2311
76	2312
86	2738
96	Toolox33
116	Toolox44
136	2738HH
156	2714HH
176	
196	

Podcięcia do demontażu na życzenie.
Corner undercuts upon request.



Material info



Korpus formy

Mold base

596x696

PK 31

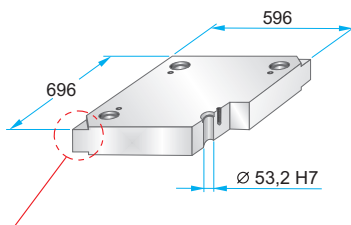
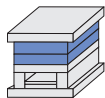

Podcięcia do demontażu na życzenie.
Corner undercuts upon request.



Material info



PK 31 – 596 x 696 x h / material

46	1730
56	2083
66	2085
76	2162
86	2311
96	2312
116	2343
136	2738
156	2767
176	Toolox33
196	Toolox44
	2738HH
	2714HH

PK 04

PKA 04

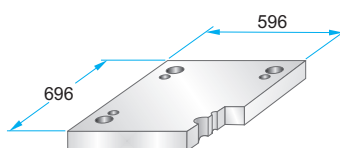
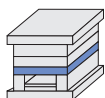

PK 04 – 596 x 696 x h / material

PKA 04 – 596 x 696 x h / material

46	1730
56	2312
76	2085

PK 05

PKA 05

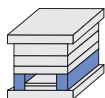

	A	B	M
PK 05	84	428	-
PKA 05	76	444	M12

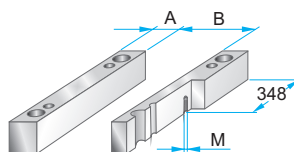

PK 05 – 596 x 696 x h / material

PKA 05 – 596 x 696 x h / material

86	1730
96	2085
116	
136	
156	
176	

PK 55

PKA 55

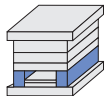

	A	B	M
PK 55	114	368	-
PKA 55	106	384	M12

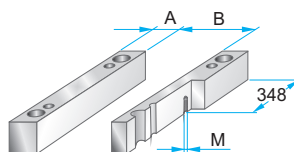

PK 55 – 596 x 696 x h / material

PKA 55 – 596 x 696 x h / material

86	1730
96	2085
116	
136	
156	
176	

PK 06

PKA 06

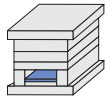

	A	B	C
PK 06	610	388	424
PKA 06	540	400	438

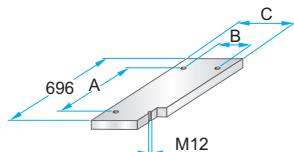

PK 06 – 596 x 696 x h / material

PKA 06 – 596 x 696 x h / material

27	1730
	2085

PK 65

PKA 65

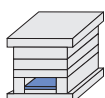

	A	B	C
PK 65	610	328	364
PKA 65	540	330	368

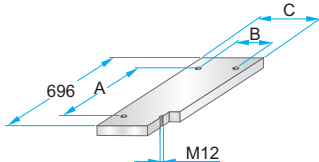

PK 65 – 596 x 696 x h / material

PKA 65 – 596 x 696 x h / material

27	1730
	2085

PK 07

PKA 07

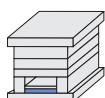

	A	B	C	D	M
PK 07	610	388	424	-	-
PKA 07	540	400	438	658	M5

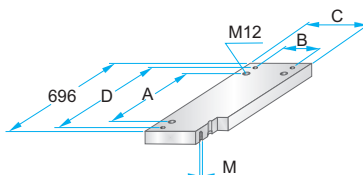

PK 07 – 596 x 696 x h / material

PKA 07 – 596 x 696 x h / material

36	1730
	2312
	2085

PK 75

PKA 75

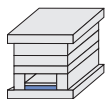

	A	B	C	D	M
PK 75	610	328	364	-	-
PKA 75	540	330	368	658	M5

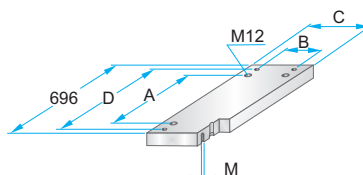

PK 75 – 596 x 696 x h / material

PKA 75 – 596 x 696 x h / material

36	1730
	2312
	2085