

**Korpus formy**

Mold base

**596x796**

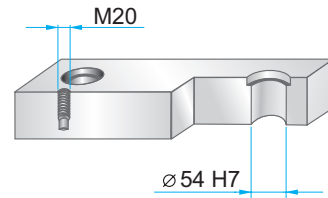
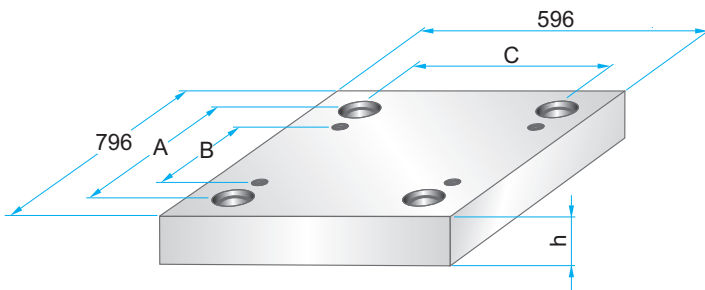

**Wymiary i tolerancje**  
Dimensions and tolerances



	A	B	C
<b>PK</b>	692	574	492
<b>PKA</b>	708	590	508

**PK 01**



	W
<b>PK 01</b>	696
<b>PKA 01</b>	646

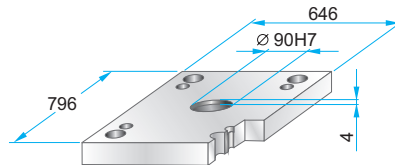

**PK 01** – 596 x 796 x h / material  
**PKA 01** – 596 x 796 x h / material

46	1730
	2312
	2085

**PK 11  
PKA 11**

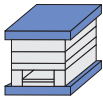

	W
<b>PK 11</b>	696
<b>PKA 11</b>	646

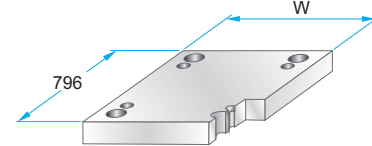

**PK 11** – 596 x 796 x h / material  
**PKA 11** – 596 x 796 x h / material

46	1730
56	2312
	2085

**PK 02  
PKA 02**



**PK 12  
PKA 12**

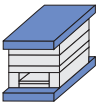

**PK 21**

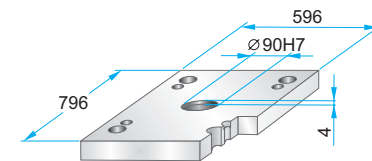
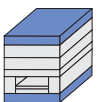

**PK 21** – 596 x 796 x h / material

46	1730
	2312
	2085

**PK 22  
PKA 22**

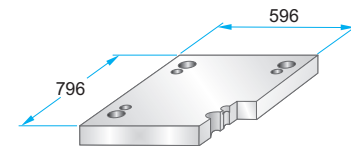

**PK 22** – 596 x 796 x h / material  
**PKA 22** – 596 x 796 x h / material

46	1730
56	2312
	2085

**PK 03  
PKA 03**

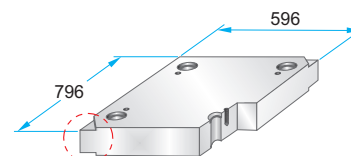
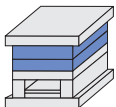

**PK 03** – 596 x 796 x h / material  
**PKA 03** – 596 x 796 x h / material

27	1730
36	2083
46	2085
56	2162
66	2311
76	2312
86	2738
96	Toolox33
116	Toolox44
136	2738HH
156	2714HH
176	
196	

**Podcięcia do demontażu na życzenie.**  
Corner undercuts upon request.



**Material info**



**Korpus formy**

Mold base

**596x796**

**PK 31**

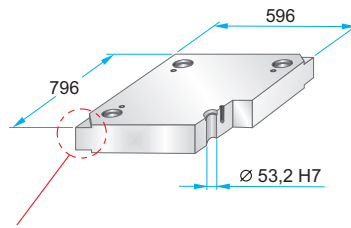
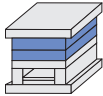

Podcięcia do demontażu na życzenie.  
Corner undercuts upon request.



**PK 31 - 596 x 796 x h / material**

h	material
46	1730
56	2083
66	2085
76	2162
86	2311
96	2312
116	2343
136	2738
156	2767
176	Toolox33
196	Toolox44
	2738HH
	2714HH

Material info



**PK 04  
PKA 04**

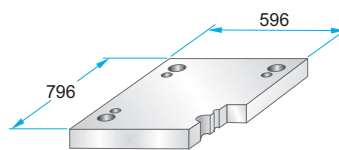
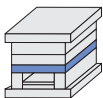

**PK 04 - 596 x 796 x h / material  
PKA 04 - 596 x 796 x h / material**

h	material
46	1730
56	2312
76	2085

**PK 05  
PKA 05**

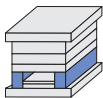

	A	B	M
<b>PK 05</b>	84	428	-
<b>PKA 05</b>	76	444	M12

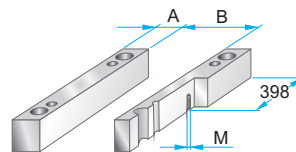

**PK 05 - 596 x 796 x h / material  
PKA 05 - 596 x 796 x h / material**

h	material
86	1730
96	2085
116	
136	
156	
176	

**PK 55  
PKA 55**

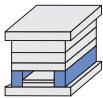

	A	B	M
<b>PK 55</b>	114	368	-
<b>PKA 55</b>	106	384	M12

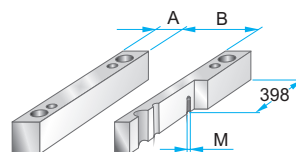

**PK 55 - 596 x 796 x h / material  
PKA 55 - 596 x 796 x h / material**

h	material
86	1730
96	2085
116	
136	
156	
176	

**PK 06  
PKA 06**

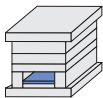

	A	B	C
<b>PK 06</b>	710	388	424
<b>PKA 06</b>	640	400	438

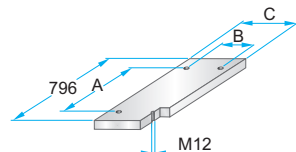

**PK 06 - 596 x 796 x h / material  
PKA 06 - 596 x 796 x h / material**

h	material
27	1730
	2085

**PK 65  
PKA 65**

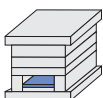

	A	B	C
<b>PK 65</b>	710	328	364
<b>PKA 65</b>	640	330	368

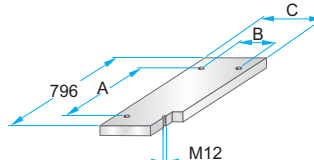

**PK 65 - 596 x 796 x h / material  
PKA 65 - 596 x 796 x h / material**

h	material
27	1730
	2085

**PK 07  
PKA 07**

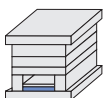

	A	B	C	D	M
<b>PK 07</b>	710	388	424	-	-
<b>PKA 07</b>	640	400	438	758	M5

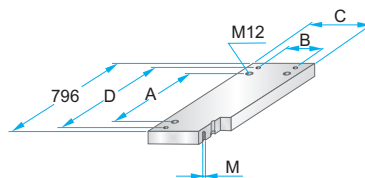

**PK 07 - 596 x 796 x h / material  
PKA 07 - 596 x 796 x h / material**

h	material
36	1730
	2312
	2085

**PK 75  
PKA 75**

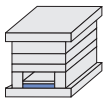

	A	B	C	D	M
<b>PK 75</b>	710	328	364	-	-
<b>PKA 75</b>	640	330	368	758	M5

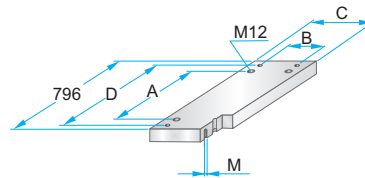

**PK 75 - 596 x 796 x h / material  
PKA 75 - 596 x 796 x h / material**

h	material
36	1730
	2312
	2085