

Korpus formy

Mold base

596x996

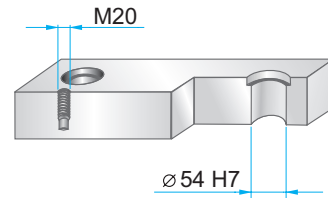
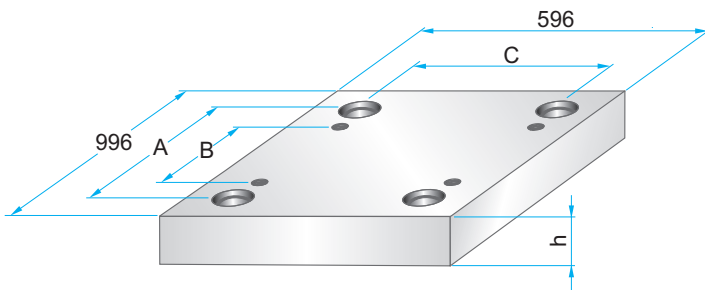

Wymiary i tolerancje
Dimensions and tolerances



	A	B	C
PK	892	774	492
PKA	908	790	508

**PK 01
PKA 01**



**PK 11
PKA 11**

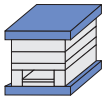

	W
PK 11	696
PKA 11	646

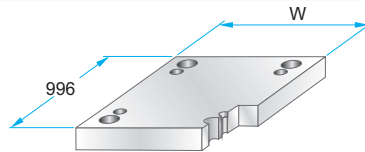

PK 11 - 596 x 996 x	h	/	material
PKA 11 - 596 x 996 x	h	/	
	46		1730
	56		2312
			2085

**PK 02
PKA 02**

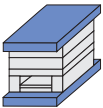

**PK 12
PKA 12**

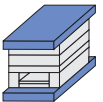

**PK 21
PKA 21**

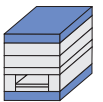

**PK 22
PKA 22**

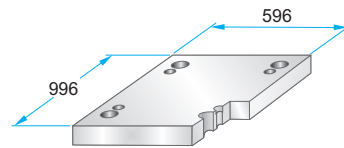

PK 22 - 596 x 996 x	h	/	material
PKA 22 - 596 x 996 x	h	/	
	46		1730
	56		2312
			2085

**PK 03
PKA 03**

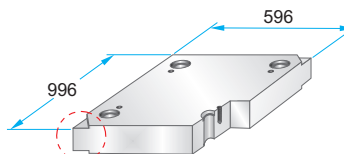
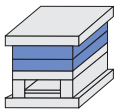

PK 03 - 596 x 996 x	h	/	material
PKA 03 - 596 x 996 x	h	/	
	27		1730
	36		2083
	46		2085
	56		2162
	66		2311
	76		2312
	86		2738
	96		Toolox33
	116		Toolox44
	136		2738HH
	156		2714HH
	176		
	196		

Podcięcia do demontażu na życzenie.
Corner undercuts upon request.



Material info



Korpus formy

Mold base

596x996

PK 31

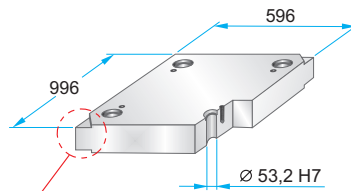
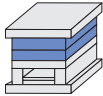

Podcięcia do demontażu na życzenie.
Corner undercuts upon request.



PK 31 - 596 x 996 x h / material

h	material
46	1730
56	2083
66	2085
76	2162
86	2311
96	2312
116	2343
136	2738
156	2767
176	Toolox33
196	Toolox44
	2738HH
	2714HH

Material info



**PK 04
PKA 04**

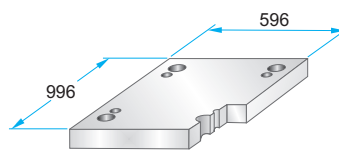
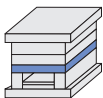

PK 04 - 596 x 996 x h / material
PKA 04 - 596 x 996 x h / material

h	material
46	1730
56	2312
76	2085

**PK 05
PKA 05**

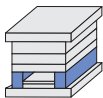

	A	B	M
PK 05	84	428	-
PKA 05	76	444	M12

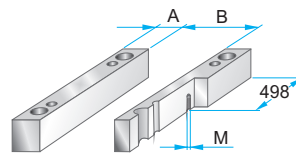

PK 05 - 596 x 996 x h / material
PKA 05 - 596 x 996 x h / material

h	material
86	1730
96	2085
116	
136	
156	
176	

**PK 55
PKA 55**

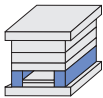

	A	B	M
PK 55	114	368	-
PKA 55	106	384	M12

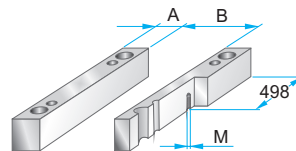

PK 55 - 596 x 996 x h / material
PKA 55 - 596 x 996 x h / material

h	material
86	1730
96	2085
116	
136	
156	
176	

**PK 06
PKA 06**

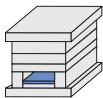

	A	B	C
PK 06	910	388	424
PKA 06	840	400	438

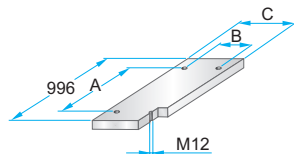

PK 06 - 596 x 996 x h / material
PKA 06 - 596 x 996 x h / material

h	material
27	1730
	2085

**PK 65
PKA 65**

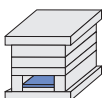

	A	B	C
PK 65	910	328	364
PKA 65	840	330	368

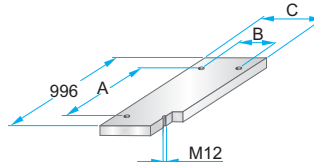

PK 65 - 596 x 996 x h / material
PKA 65 - 596 x 996 x h / material

h	material
27	1730
	2085

**PK 07
PKA 07**

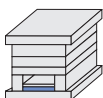

	A	B	C	D	M
PK 07	910	388	424	-	-
PKA 07	840	400	438	958	M5

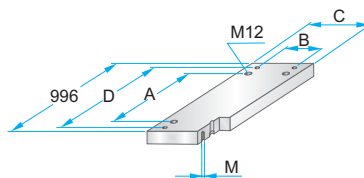

PK 07 - 596 x 996 x h / material
PKA 07 - 596 x 996 x h / material

h	material
36	1730
	2312
	2085

**PK 75
PKA 75**

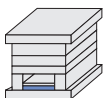

	A	B	C	D	M
PK 75	910	328	364	-	-
PKA 75	840	330	368	958	M5

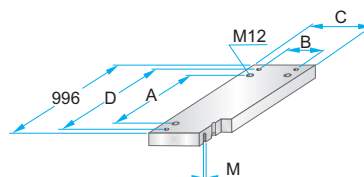

PK 75 - 596 x 996 x h / material
PKA 75 - 596 x 996 x h / material

h	material
36	1730
	2312
	2085