

Korpus formy

Mold base

646x696

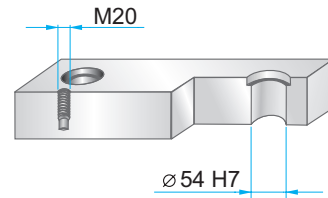
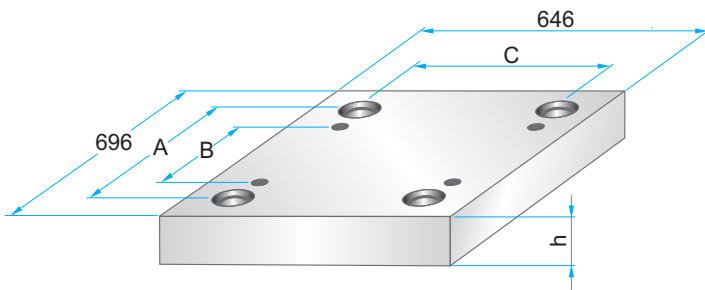

Wymiary i tolerancje
Dimensions and tolerances



	A	B	C
PK	592	474	542
PKA	608	490	558

**PK 01
PKA 01**



**PK 11
PKA 11**

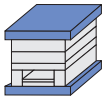

	W
PK 11	746
PKA 11	696

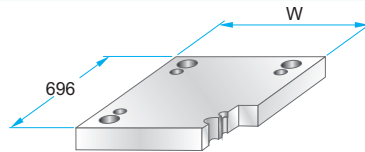

PK 11 - 646 x 696 x	h /	material
PKA 11 - 646 x 696 x	h /	
	46	1730
	56	2312
		2085

**PK 02
PKA 02**



**PK 12
PKA 12**

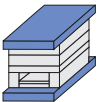

**PK 21
PKA 21**

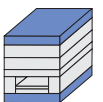

**PK 22
PKA 22**

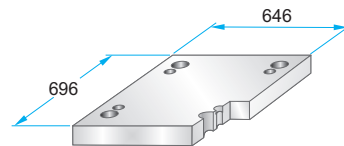

PK 22 - 646 x 696 x	h /	material
PKA 22 - 646 x 696 x	h /	
	46	1730
	56	2312
		2085

**PK 03
PKA 03**

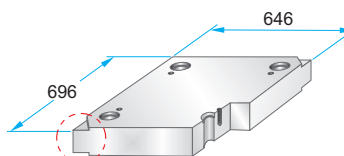
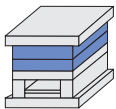

PK 03 - 646 x 696 x	h /	material
PKA 03 - 646 x 696 x	h /	
	27	1730
	36	2083
	46	2085
	56	2162
	66	2311
	76	2312
	86	2738
	96	Toolox33
	116	Toolox44
	136	2738HH
	156	2714HH
	176	
	196	

Podcięcia do demontażu na życzenie.
Corner undercuts upon request.



Material info



Korpus formy

Mold base

646x696

PK 31

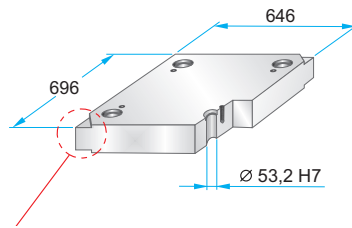
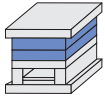

Podcięcia do demontażu na życzenie.
Corner undercuts upon request.



PK 31 - 646 x 696 x h / material

46	1730
56	2083
66	2085
76	2162
86	2311
96	2312
116	2343
136	2738
156	2767
176	Toolox33
196	Toolox44
	2738HH
	2714HH

Material info



**PK 04
PKA 04**

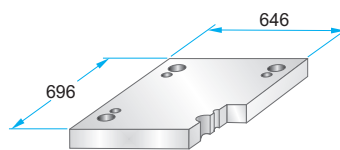
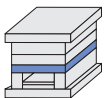

**PK 04 - 646 x 696 x h / material
PKA 04 - 646 x 696 x h / material**

46	1730
56	2312
76	2085

**PK 05
PKA 05**

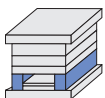

	A	B	M
PK 05	84	478	-
PKA 05	76	494	M12

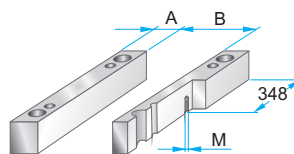

**PK 05 - 646 x 696 x h / material
PKA 05 - 646 x 696 x h / material**

86	1730
96	2085
116	
136	
156	
176	

**PK 55
PKA 55**

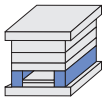

	A	B	M
PK 55	114	418	-
PKA 55	106	434	M12

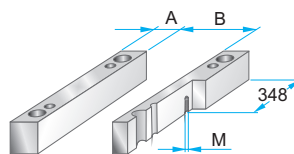

**PK 55 - 646 x 696 x h / material
PKA 55 - 646 x 696 x h / material**

86	1730
96	2085
116	
136	
156	
176	

**PK 06
PKA 06**

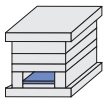

	A	B	C
PK 06	610	438	474
PKA 06	540	450	488

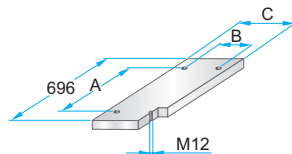

**PK 06 - 646 x 696 x h / material
PKA 06 - 646 x 696 x h / material**

27	1730
	2085

**PK 65
PKA 65**

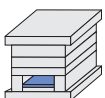

	A	B	C
PK 65	610	378	414
PKA 65	540	380	418

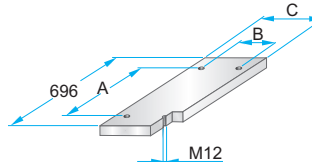

**PK 65 - 646 x 696 x h / material
PKA 65 - 646 x 696 x h / material**

27	1730
	2085

**PK 07
PKA 07**

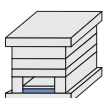

	A	B	C	D	M
PK 07	610	438	474	-	-
PKA 07	540	450	488	658	M5

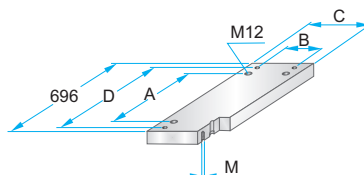

**PK 07 - 646 x 696 x h / material
PKA 07 - 646 x 696 x h / material**

36	1730
	2312
	2085

**PK 75
PKA 75**

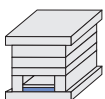

	A	B	C	D	M
PK 75	610	378	414	-	-
PKA 75	540	380	418	658	M5

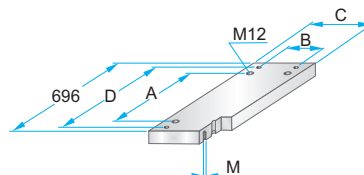

**PK 75 - 646 x 696 x h / material
PKA 75 - 646 x 696 x h / material**

36	1730
	2312
	2085