

Korpus formy

Mold base

696x996

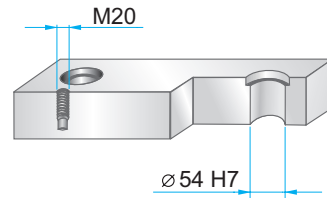
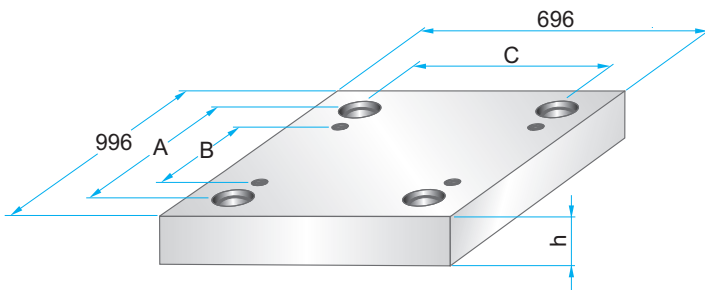

Wymiary i tolerancje
Dimensions and tolerances



	A	B	C
PK	892	774	592
PKA	908	790	608

**PK 01
PKA 01**



**PK 11
PKA 11**

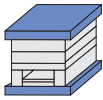

	W
PK 11	796
PKA 11	746

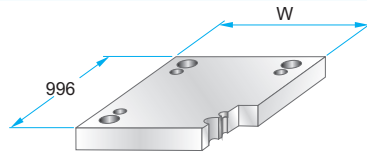

PK 11 - 696 x 996 x	h /	material
PKA 11 - 696 x 996 x	h /	
	46	1730
	76	2312
		2085

**PK 02
PKA 02**

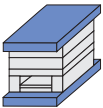

**PK 12
PKA 12**

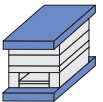

**PK 21
PKA 21**

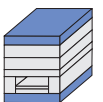

**PK 22
PKA 22**

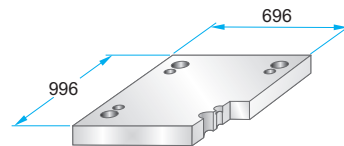

PK 22 - 696 x 996 x	h /	material
PKA 22 - 696 x 996 x	h /	
	46	1730
	56	2312
		2085

**PK 03
PKA 03**

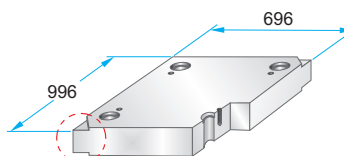
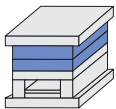

PK 03 - 696 x 996 x	h /	material
PKA 03 - 696 x 996 x	h /	
	27	1730
	36	2083
	46	2085
	56	2162
	66	2311
	76	2312
	86	2738
	96	Toolox33
	116	Toolox44
	136	2738HH
	156	2714HH
	176	
	196	

Podcięcia do demontażu na życzenie.
Corner undercuts upon request.



Material info



Korpus formy

Mold base

696x996

PK 31

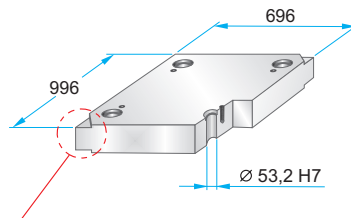
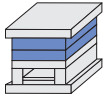

Podcięcia do demontażu na życzenie.
Corner undercuts upon request.



Material info



PK 31 – 696 x 996 x h / material

h	material
46	1730
56	2083
66	2085
76	2162
86	2311
96	2312
116	2343
136	2738
156	2767
176	Toolox33
196	Toolox44
	2738HH
	2714HH

**PK 04
PKA 04**

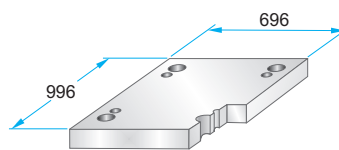
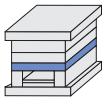

**PK 04 – 696 x 996 x h / material
PKA 04 – 696 x 996 x h / material**

h	material
46	1730
56	2312
76	2085

**PK 05
PKA 05**

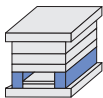

	A	B	M
PK 05	84	528	-
PKA 05	76	544	M12

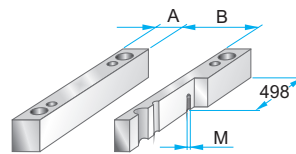

**PK 05 – 696 x 996 x h / material
PKA 05 – 696 x 996 x h / material**

h	material
86	1730
96	2085
116	
136	
156	
176	

**PK 55
PKA 55**

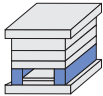

	A	B	M
PK 55	114	468	-
PKA 55	106	484	M12

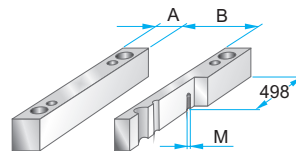

**PK 55 – 696 x 996 x h / material
PKA 55 – 696 x 996 x h / material**

h	material
86	1730
96	2085
116	
136	
156	
176	

**PK 06
PKA 06**

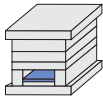

	A	B	C
PK 06	910	488	524
PKA 06	840	500	538

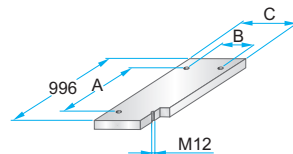

**PK 06 – 696 x 996 x h / material
PKA 06 – 696 x 996 x h / material**

h	material
27	1730
	2085

**PK 65
PKA 65**

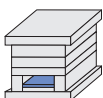

	A	B	C
PK 65	910	428	464
PKA 65	840	430	468

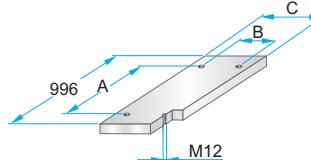

**PK 65 – 696 x 996 x h / material
PKA 65 – 696 x 996 x h / material**

h	material
27	1730
	2085

**PK 07
PKA 07**

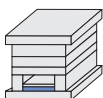

	A	B	C	D	M
PK 07	910	488	524	-	-
PKA 07	840	500	538	958	M5

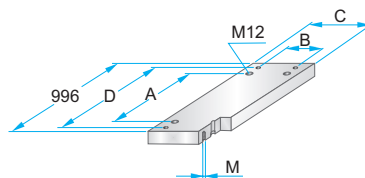

**PK 07 – 696 x 996 x h / material
PKA 07 – 696 x 996 x h / material**

h	material
36	1730
	2312
	2085

**PK 75
PKA 75**

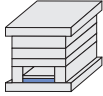

	A	B	C	D	M
PK 75	910	428	464	-	-
PKA 75	840	430	468	958	M5

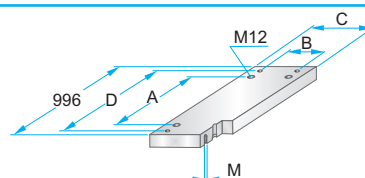

**PK 75 – 696 x 996 x h / material
PKA 75 – 696 x 996 x h / material**

h	material
36	1730
	2312
	2085