

Korpus formy

Mold base

746x896

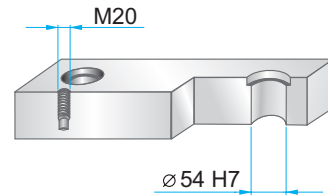
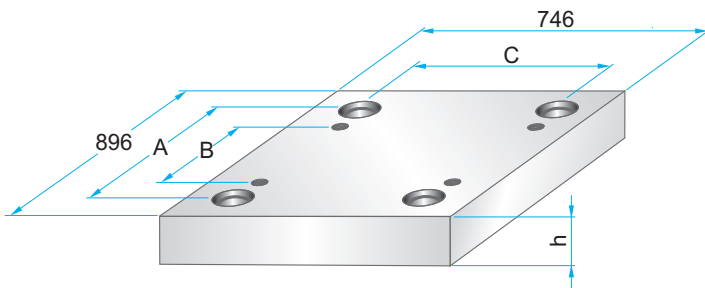

Wymiary i tolerancje
Dimensions and tolerances



	A	B	C
PK	792	674	642
PKA	808	690	658

**PK 01
PKA 01**



**PK 11
PKA 11**

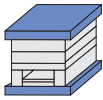

	W
PK 11	846
PKA 11	796

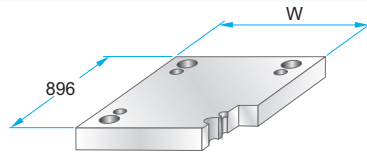

PK 11 - 746 x 896 x	h /	material
PKA 11 - 746 x 896 x	h /	
	46	1730
	76	2312
		2085

**PK 02
PKA 02**



**PK 12
PKA 12**



**PK 21
PKA 21**

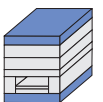

**PK 22
PKA 22**

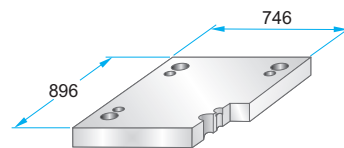

PK 22 - 746 x 896 x	h /	material
PKA 22 - 746 x 896 x	h /	
	46	1730
	56	2312
		2085

**PK 03
PKA 03**

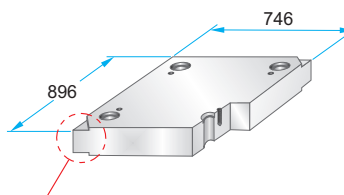
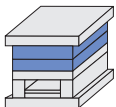

PK 03 - 746 x 896 x	h /	material
PKA 03 - 746 x 896 x	h /	
	27	1730
	36	2083
	46	2085
	56	2162
	66	2311
	76	2312
	86	2738
	96	Toolox33
	116	Toolox44
	136	2738HH
	156	2714HH
	176	
	196	

Podcięcia do demontażu na życzenie.
Corner undercuts upon request.



Material info



Korpus formy

Mold base

746x896

PK 31

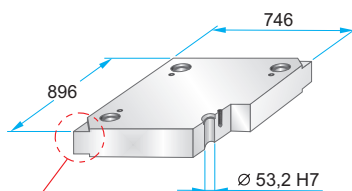
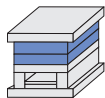

Podcięcia do demontażu na życzenie.
Corner undercuts upon request.



Material info



PK 31 - 746 x 896 x h / material

h	material
46	1730
56	2083
66	2085
76	2162
86	2311
96	2312
116	2343
136	2738
156	2767
176	Toolox33
196	Toolox44
	2738HH
	2714HH

PK 04

PKA 04

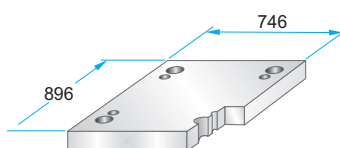
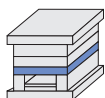

PK 04 - 746 x 896 x h / material

PKA 04 - 746 x 896 x h / material

h	material
46	1730
56	2312
76	2085

PK 05

PKA 05

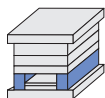

	A	B	M
PK 05	84	578	-
PKA 05	76	594	M12

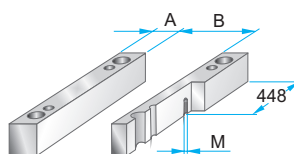

PK 05 - 746 x 896 x h / material

PKA 05 - 746 x 896 x h / material

h	material
86	1730
96	2085
116	
136	
156	
176	

PK 55

PKA 55

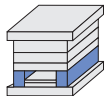

	A	B	M
PK 55	114	518	-
PKA 55	106	534	M12

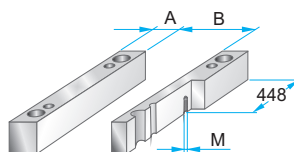

PK 55 - 746 x 896 x h / material

PKA 55 - 746 x 896 x h / material

h	material
86	1730
96	2085
116	
136	
156	
176	

PK 06

PKA 06

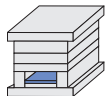

	A	B	C
PK 06	810	538	574
PKA 06	740	550	588

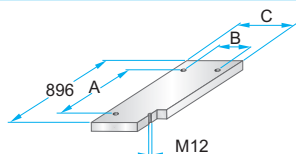

PK 06 - 746 x 896 x h / material

PKA 06 - 746 x 896 x h / material

h	material
27	1730
	2085

PK 65

PKA 65

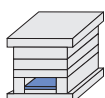

	A	B	C
PK 65	810	478	514
PKA 65	740	480	518

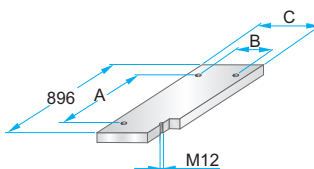

PK 65 - 746 x 896 x h / material

PKA 65 - 746 x 896 x h / material

h	material
27	1730
	2085

PK 07

PKA 07

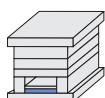

	A	B	C	D	M
PK 07	810	538	574	-	-
PKA 07	740	550	588	858	M5

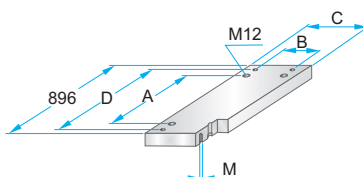

PK 07 - 746 x 896 x h / material

PKA 07 - 746 x 896 x h / material

h	material
36	1730
46	2312
	2085

PK 75

PKA 75

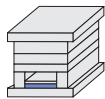

	A	B	C	D	M
PK 75	810	478	514	-	-
PKA 75	740	480	518	858	M5

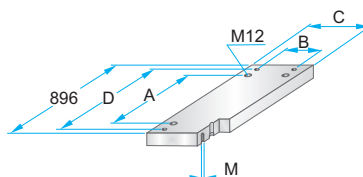

PK 75 - 746 x 896 x h / material

PKA 75 - 746 x 896 x h / material

h	material
36	1730
46	2312
	2085