

**Korpus formy**

Mold base

**796x996**

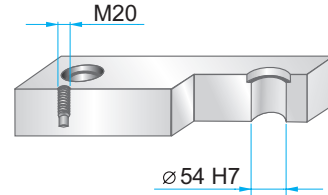
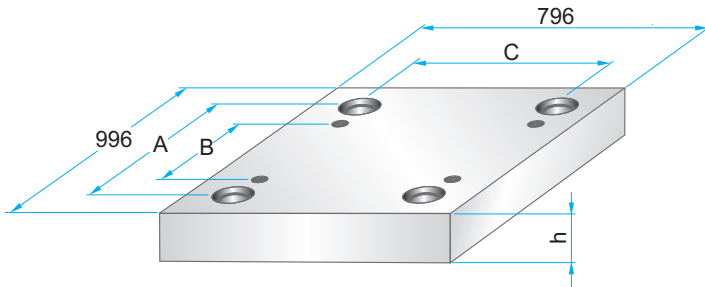

**Wymiary i tolerancje**  
Dimensions and tolerances



	A	B	C
<b>PK</b>	892	774	692
<b>PKA</b>	908	790	708

**PK 01  
PKA 01**



**PK 11  
PKA 11**

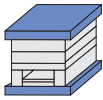

	W
<b>PK 11</b>	896
<b>PKA 11</b>	846

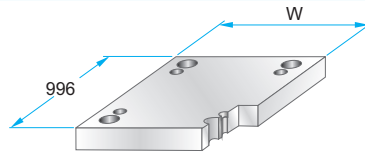

PK 11 - 796 x 996 x	h /	material
PKA 11 - 796 x 996 x	h /	
	46	1730
	76	2312
		2085

**PK 02  
PKA 02**

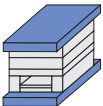

**PK 12  
PKA 12**

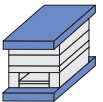

**PK 21  
PKA 21**

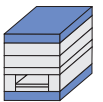

**PK 22  
PKA 22**

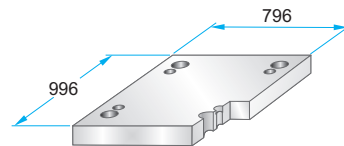

PK 22 - 796 x 996 x	h /	material
PKA 22 - 796 x 996 x	h /	
	46	1730
	56	2312
		2085

**PK 03  
PKA 03**

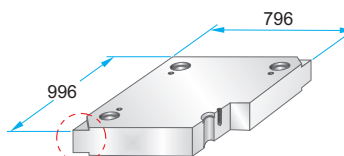
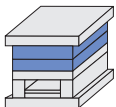

PK 03 - 796 x 996 x	h /	material
PKA 03 - 796 x 996 x	h /	
	27	1730
	36	2083
	46	2085
	56	2162
	66	2311
	76	2312
	86	2738
	96	Toolox33
	116	Toolox44
	136	2738HH
	156	2714HH
	176	
	196	

**Podcięcia do demontażu na życzenie.**  
Corner undercuts upon request.



**Material info**



**Korpus formy**

Mold base

**796x996**

**PK 31**

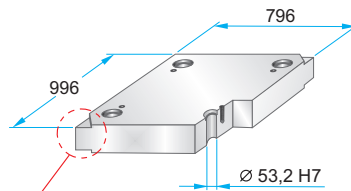
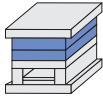

Podcięcia do demontażu na życzenie.  
Corner undercuts upon request.



Material info



**PK 31 - 796 x 996 x h / material**

46	1730
56	2083
66	2085
76	2162
86	2311
96	2312
116	2343
136	2738
156	2767
176	Toolox33
196	Toolox44
	2738HH
	2714HH

**PK 04  
PKA 04**

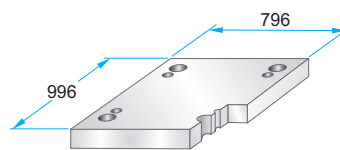
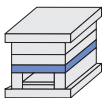

**PK 04 - 796 x 996 x h / material**  
**PKA 04 - 796 x 996 x h / material**

46	1730
56	2312
76	2085

**PK 05  
PKA 05**

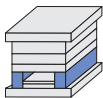

	A	B	M
<b>PK 05</b>	84	628	-
<b>PKA 05</b>	76	644	M12

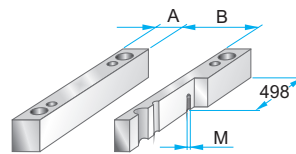

**PK 05 - 796 x 996 x h / material**  
**PKA 05 - 796 x 996 x h / material**

86	1730
96	2085
116	
136	
156	
176	

**PK 55  
PKA 55**

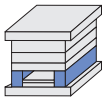

	A	B	M
<b>PK 55</b>	114	568	-
<b>PKA 55</b>	106	584	M12

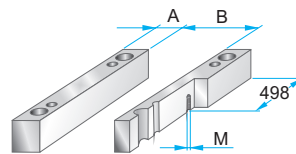

**PK 55 - 796 x 996 x h / material**  
**PKA 55 - 796 x 996 x h / material**

86	1730
96	2085
116	
136	
156	
176	

**PK 06  
PKA 06**

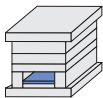

	A	B	C
<b>PK 06</b>	910	588	624
<b>PKA 06</b>	840	600	638

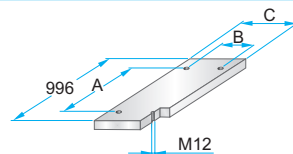

**PK 06 - 796 x 996 x h / material**  
**PKA 06 - 796 x 996 x h / material**

27	1730
	2085

**PK 65  
PKA 65**

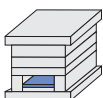

	A	B	C
<b>PK 65</b>	910	528	564
<b>PKA 65</b>	840	530	568

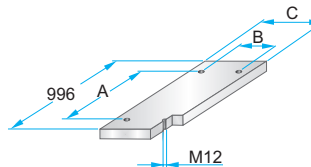

**PK 65 - 796 x 996 x h / material**  
**PKA 65 - 796 x 996 x h / material**

27	1730
	2085

**PK 07  
PKA 07**

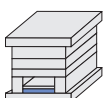

	A	B	C	D	M
<b>PK 07</b>	910	588	624	-	-
<b>PKA 07</b>	840	600	638	958	M5

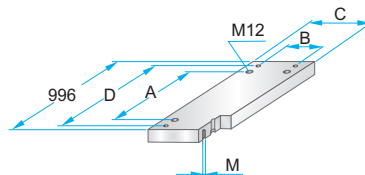

**PK 07 - 796 x 996 x h / material**  
**PKA 07 - 796 x 996 x h / material**

46	1730
	2312
	2085

**PK 75  
PKA 75**

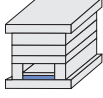

	A	B	C	D	M
<b>PK 75</b>	910	528	564	-	-
<b>PKA 75</b>	840	530	568	958	M5

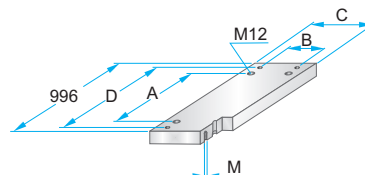

**PK 75 - 796 x 996 x h / material**  
**PKA 75 - 796 x 996 x h / material**

46	1730
	2312
	2085