

**Korpus formy**

Mold base

**95x95**

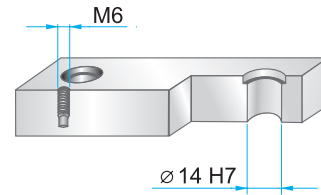
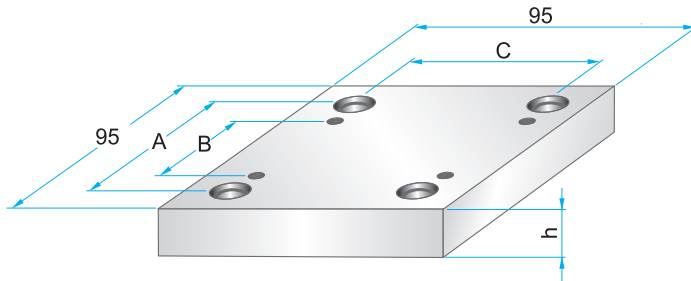

Wymiary i tolerancje  
Dimensions and tolerances



	A	B	C
PK	75	46	75

**PK 01**

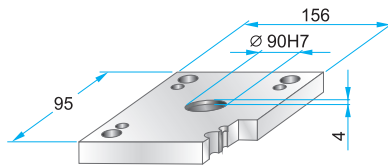

**PK 01 – 95 x 95 x h / material**

22	1730
	2312
	2085

**PK 11**

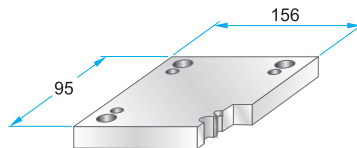

**PK 11 – 95 x 95 x h / material**

22	1730
	2312
	2085

**PK 02**

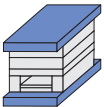

**PK 12**

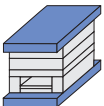

**PK 21**

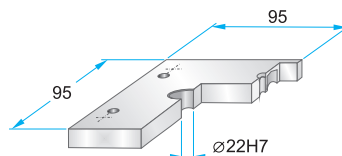

**PK 21 – 95 x 95 x h / material**

12	1730
17	2312
	2085

**PK 22**

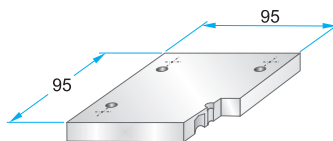

**PK 22 – 95 x 95 x h / material**

12	1730
17	2312
	2085

**PK 03**

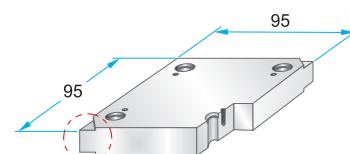
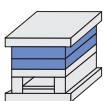

**PK 03 – 95 x 95 x h / material**

9	1730
12	2312
17	2085
22	2162
27	2311
36	2312
46	2738
56	Toolox33
	Toolox44
	2738HH
	2714HH

Podcięcia do demontażu na życzenie.  
Corner undercuts upon request.



Material info



**Korpus formy**

Mold base

**95x95**

**PK 31**

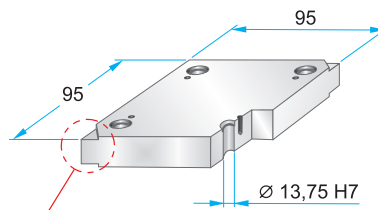
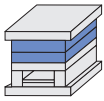

**PK 31 – 95 x 95 x h / material**

9	1730
12	2083
17	2085
22	2162
27	2311
36	2312
46	2343
56	2738
	2767
	Toolox33
	Toolox44
	2738HH
	2714HH

Podcięcia do demontażu na życzenie.  
Corner undercuts upon request.



Material info



**PK 04**

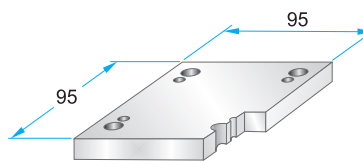
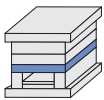

**PK 04 – 95 x 95 x h / material**

6	1730
12	2312
17	2085

**PK 05**

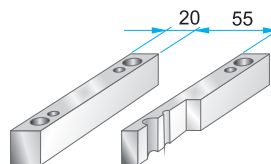
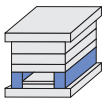

**PK 05 – 95 x 95 x h / material**

22	1730
27	2085
36	
46	

**PK 55**

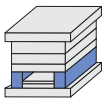

**PK 06**

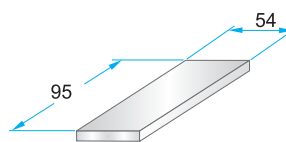

**PK 06 – 95 x 95 x h / material**

6	1730
	2085

**PK 65**

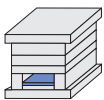

**PK 07**

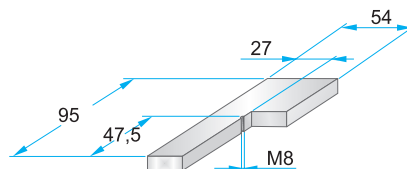

**PK 07 – 95 x 95 x h / material**

9	1730
	2312
	2085

**PK 75**

